

DATE: 2024-02-22

Draft Agenda – Meeting # 71

Agenda for the 71st Meeting of ISO/IEC JTC 1/SC2/WG2, Prague, Czechia. 2024- June 10-14

This will be held as a hybrid meeting from June 10<sup>th</sup> (afternoon after the morning dedicated to SC2 plenary), to the 14<sup>th</sup> (morning). This document contains additional information concerning local logistics and visa information. Many visitors can travel to European countries without visa (the ETIAS process has been delayed until 2025), but you need to check your visa requirement status based on your citizenship. If you need an invitation letter, the process is described in the visa information pages at the end of this document.

SC2 and WG2 attendance requires use of the ISO meeting management system. Instructions on how to join will be provided through that system.

The following draft agenda is based on information available as of today and will be updated as we get closer to the meeting date. Contributions welcome.

Topic (Document No.)	Proposed Outcome
1 Opening and roll call List	Update Distribution
2 Approval of the agenda (N5248)	Approved agenda
3 Approval of minutes of meeting 70 ( <a href="#">N5244</a> )	Approved minutes
4 Review action items from previous meeting ( <a href="#">N5244-AI</a> )	Updated Action Items
5 JTC 1 and ITTF matters: 5.1 JTC 1 Code of Conduct ( <a href="#">N5213</a> )	FYI
5.2 Notice of Publication: ISO/IEC 10646:2020 Amd 1:2023 ( <a href="#">N4875</a> )	FYI
6 SC2 matters:	
6.1 Text for ISO/IEC 10646 (Ed.6) CDAM2.3 ( <a href="#">SC2/4876</a> )	FYI
6.2 Result of CDAM2.3 consultation ( <a href="#">SC2/4891</a> )	FYI
6.3 Disposition of comments on 10646 (Ed.6) CDAM2.3 ( <a href="#">N5245</a> )	FYI
7 WG2 matters:	
7.1 Text for ISO/IEC 10646 (Ed.6) CDAM2.4 (SC2/49xx)	FYI
7.2 Result of CDAM2.4 consultation (SC2/49xx)	FYI
7.3 Disposition of comments on 10646 Ed.6 CDAM2.4 (draft N52xx, final N52xx)	Adoption
7.4 Roadmap Snapshot ( <a href="#">Roadmap</a> ), accessed February 21, 2024	FYI
7.5 Additional draft repertoire for provisionally accepted code points ( <a href="#">N5249</a> )	FYI
7.6 Meeting #71 recommendations (N52xx)	Adoption
8 IRG status and reports	
8.1 IRG #61 Hybrid, 2023/10/16~20 Recommendations and Action Items ( <a href="#">N5243</a> )	FYI
8.2 IRG #62 Virtual, 2024/3/18~22 Recommendations and Action Items (N52xx)	FYI

- 8.3 Summary IRG 61 and 62 (N52xx) FYI
- 8.4 IRG PnP Version 17 (N52xx) FYI
- 9 Contributions related to ballots:
  - 9.1 Related to and incorporated into 10646 Ed.6 CDAM2.3
    - 9.1.1 Additional draft repertoire for cdam2.3, revised ([N5235R](#))
    - 9.1.2 ISO/IEC 10646 repertoire proposal for CDAM2.3 ([N5241](#))
    - 9.1.3 Proposal for an extended Egyptian Hieroglyphs repertoire ([N5240](#)), ([DB 38MB](#))
    - 9.1.4 Encoding proposal for two arrow symbols used in Egyptology ([N5239](#))
    - 9.1.5 Proposal to encode 622 urgently needed ideographs, 2<sup>nd</sup> revision ([N5214R2](#) [N5238](#))
    - 9.1.6 CJK & Unihan Group Recommendations for UTC #176 Meeting ([L2/23-163](#)) FYI
    - 9.1.7 Revision of 3 G-Source Glyphs ([L2/23-133](#))
  - 9.2 Related to and incorporated into ISO/IEC 10646 Ed.6 CDAM2.4
    - 9.2.1 Additional draft repertoire for cdam2.4 ([N5246](#))
    - 9.2.2 ISO/IEC 10646 repertoire proposal for CDAM2.4 ([N5247](#))
    - 9.2.3 Proposal for an extended Egyptian Hieroglyphs repertoire, 2<sup>nd</sup> revision, 3995 characters ([N5240R2](#))
    - 9.2.4 CJK & Unihan Group Recommendations for UTC #177 Meeting ([L2/23-237](#)) FYI
    - 9.2.5 Request to update the G-Source reference for U+320DD ([L2/23-255](#))
    - 9.2.6 Request to confirm one unification for U+2C21C (new G source) ([L2/23-243](#))
    - 9.2.7 Proposal to Change Glyph of U+21128 (V source) ([L2/23-242](#))
    - 9.2.8 Suggestions to correct representative glyphs of 4 CJKUs, applied to U+2B92C (G source) and U+32268 (UK source) ([L2/23-244](#))
    - 9.2.9 Proposal to update the reference glyphs for 3 characters G source U+203D8, U+25B9F, U+2D156 ([L2/23-245](#))
    - 9.2.10 Proposal to update glyph of U+3029 SUZHOU NUMERAL NINE ([L2/23-167](#))
    - 9.2.11 Proposal to encode (disunify) two stroke characters in CJK Strokes block ([L2/23-220](#))
    - 9.2.12 Proposal to modify the representative glyph of U+31D2 CJK STROKE P ([L2/23-221](#))
    - 9.2.13 CJK & Unihan Group Recommendations for UTC #178 Meeting ([L2/24-012](#)) FYI
    - 9.2.14 New UTC sources for U+3150D and U+317EA, page 6 and 7 of L2/24-012
    - 9.2.15 Glyph update for U+30D91 and U+30D94 (UK sources) page 10 of L2/24/012
    - 9.2.16 Update Suzhou numerals in CJK Symbols font ([L23/281](#))
    - 9.2.17 Proposal to encode a blank character for Khitan Small Script ([N5205](#))
    - 9.2.18 Proposal for 7 new Emojis ([L2/23-236r](#))
    - 9.2.19 Glyph corrections for four Tangut ideographs ([N5237](#))
    - 9.2.20 Glyph correction for Khitan Small Script U+18BD2 ([L2/23-199](#))
    - 9.2.21 New K source for U+25A36 ([N5245](#))
    - 9.2.22 Proposal to Encode 3 Additional Latin Characters for Wakashan and Salishan Languages U+A7DA..U+A7DC ([L2/23-191](#))
  - 9.3 Related but not incorporated into ISO/IEC 10646 Ed.6 CDAM2.4
  - 9.4 Recommended for future encoding at M70, also provisionally assigned by Unicode
    - 9.4.1 Proposal to Encode the Chisoi script ([L2/22-218R3](#))
    - 9.4.2 Proposal to encode the Tai Yo Script ([L2/22-289R](#))
    - 9.4.3 Proposal to encode the Sidetic script ([L2/23-019](#))

- 9.4.4 Proposal to encode the Tolong Siki ([L2/23-024](#))
- 9.4.5 Proposal to encode SANSKRIT BA (formerly ALTERNATE BA) for the Bengali Language U+09FF ([L2/22-268R](#))
- 9.4.6 Proposal to add two characters to Middle English U+A7D2 U+A7D4 ([N5525](#))
- 9.4.7 Proposal to encode two Quranic Arabic Characters U+10EC5 U+10EFB ([L2/22-281R](#))
- 9.4.8 Proposal for ARABIC BIBLICAL END OF VERSE U+10ED0 ([L2/23-103](#))
- 9.5 Recommended for future encoding by Unicode
  - 9.5.1 Proposal to encode 116 Tangut components and 29 Tangut ideographs ([N5217](#), [N5218](#))
- 10 Script contributions not related to ballots
  - 10.1 Carried forward not related to ballots without new contributions
    - 10.1.1 Scripts and new blocks

Afáka <a href="#">N4292</a>	Loma <a href="#">N4786</a> , <a href="#">N4837</a>
Aiha <a href="#">N5226</a>	Lota Ende <a href="#">L2/16-076</a>
Bagam <a href="#">N4293</a>	Mandombe <a href="#">L2/16-077R</a>
Balti 'B' <a href="#">N4016</a>	Moon <a href="#">N4128</a>
Balti scripts <a href="#">N3842</a>	Mwangwego <a href="#">N4323</a>
Beria <a href="#">L2/08-265</a>	Naxi Dongba <a href="#">N4898</a>
Bété <a href="#">L2/19-044</a>	Naxi Geba <a href="#">N4886</a> <a href="#">N4887</a>
Bima <a href="#">L2/16-119</a>	Obsolete Simplified Chinese Ideographs <a href="#">N3695</a>
Blissymbols <a href="#">N5228</a> <a href="#">N5149</a> <a href="#">N5171</a>	Old Yi <a href="#">N3288</a>
Brusha <a href="#">L2/17-183</a>	Oracle Bone <a href="#">N5090</a>
Buginese extensions <a href="#">L2/16-159</a>	Palaeohispanic Northern <a href="#">L2/22-146</a>
Chinese Chess Symbols <a href="#">N3910</a>	Palaeohispanic Southern <a href="#">L2/22-147</a>
CJK Buddhist symbols <a href="#">N5166</a>	Pau Cin Hau Syllabary <a href="#">L2/16-014</a>
Diwani Siyaq Numbers <a href="#">L2/15-066R</a>	Persian Siyaq <a href="#">L2/21-105</a>
Eebee Hmong <a href="#">N4668</a>	Proto-Cuneiform <a href="#">L2/22-239</a>
Jianzi Musical Notation and Format Controls, <a href="#">N5041</a>	Proto-Elamite <a href="#">L2/20-192</a>
Jurchen <a href="#">N4795</a> , updated <a href="#">N5207</a> , <a href="#">N5131</a>	Pungchen <a href="#">L2/17-181</a>
Kerinci <a href="#">L2/16-074</a>	Pyu <a href="#">N3874</a>
Khambu Rai <a href="#">N4018</a>	Ranjana <a href="#">L2/23-028</a>
Khatt-i Baburi <a href="#">N4130</a>	Shuishu <a href="#">N4758</a> <a href="#">N4922</a> <a href="#">N4839</a> <a href="#">N4956</a> <a href="#">N4942</a> <a href="#">N4946</a> <a href="#">N5110</a>
Khitan Large script <a href="#">N4631</a> , <a href="#">N4642</a>	Southwest China Hieroglyphs <a href="#">N4856</a> <a href="#">N4901</a>
Khotanese <a href="#">L2/15-022</a>	Sumbawa <a href="#">L2/16-096</a>
Kpelle <a href="#">N3762</a>	Tamga symbols <a href="#">N5092</a>
Kulitan <a href="#">L2/15-232</a>	Tocharian <a href="#">L2/15-236</a>
Lampung <a href="#">L2/22-044</a>	Vexillology symbols <a href="#">L2/17-089</a>
Landa <a href="#">N3768</a>	Western Cham <a href="#">N5098</a> <a href="#">L2/22-095</a>
Leke <a href="#">N4438</a>	Woleai <a href="#">N4146</a>
Linear Elamite <a href="#">L2/21-233</a>	Zou <a href="#">N4044</a>
Lisu Monosyllabic <a href="#">N5047</a> <a href="#">N5121</a>	

## 10.2 New scripts or block or existing with new contributions

### 10.2.1 Shuowen Small Seal

10.2.1.1 Previous proposals [N4688](#), [N4853](#)

10.2.1.2 Current proposal to encode Small Seal Script ([N5105](#)), [appendix](#)

10.2.1.3 Various report of discussion ([N5034](#)), ([N5089](#)), ([N5108](#))

10.2.1.4 Shuowen Seal encoding report, TCA, Sept 27 ([N5117](#))

10.2.1.5 About the future extension of Shuowen Seal ([N5118](#)), Feedback ([N5123](#)), revised after feedback ([N5188](#))

10.2.1.6 Shuowen Seal Ad Hoc Meeting Report, Taipei, Oct 2019 ([N5119](#))

10.2.1.7 Comparison table of N5105 proposal (of Shuowen Seal) and Changzhi's version, ([N5133](#) and appended [data](#)), TCA and China feedback ([N5187](#))

10.2.1.8 THX Seal Modifications principles ([N5189](#))

10.2.1.9 THX Correction glyph summary table ([N5190](#))

10.2.1.10 THX Properties Table (pdf: [N5191](#)), [excel format](#)

10.2.1.11 UCS Seal Script Source Mapping Data ([L2/22-279](#))

10.2.1.12 Consideration concerning Small Seal ([N5209](#), [table pdf](#), [XLS](#))

10.2.1.13 Comparison 14 column chart ([N5211](#), [chart \(420MB\)](#))

10.2.1.14 Comments to latest documents from TCA/China (n5187, 5189, 5190) ([N5219](#))

10.2.1.15 TCA feedback to N5209 ([N5230](#)), [XLS data](#)

10.2.1.16 TCA feedback to N5219 ([N5231](#))

10.2.1.17 Preliminary Draft of Mapping Table for Shuowen Seal: from CCZ to N5191 ([N5232](#)), [data \(zip\)](#)

10.2.1.18 Small-Seal, Glyph Image Chart to Review L2/22-279 Mapping ([N5242](#)), full chart ([pdf 302MB](#))

## 10.3 Additions to existing scripts or blocks provisionally assigned by Unicode

10.3.1 Additional draft repertoire for provisionally assigned code points ([N5249](#))

10.3.2 Proposal to encode Mongolian Manchu Alternate UE U+1879 ([L2/24-025](#))

10.3.3 Request for six compound tone diacritics U+1AD0..U+1AD5 ([L2/23-188](#))

10.3.4 Request for three compound tone diacritics U+1AD6..U+1AD8 ([L2/23-208](#))

10.3.5 Request for five Harrington diacritics U+1AD9..U+1ADD ([L2/23-206R](#))

10.3.6 Request for one chess symbol U+2B96 ([L2/24-018](#))

10.3.7 Proposal to add two Latin pharyngeal voiced fricative characters U+A7CE..U+A7CF ([L2/23-219](#))

10.3.8 Proposal to encode eight Arabic Honorifics U+FD90 U+FD98..U+FD9E ([L2/24-002](#))

10.3.9 Proposal to encode Arabic Letter Thin Noon: U+10EC6 ([L2/23-121](#))

10.3.10 Proposal to encode Arabic Double Vertical Bar Below U+10EFA ([L2/23-248](#))

10.3.11 Proposal to Encode eight Kashmiri Sharada Characters U+11B60..U+11B67 ([L2/23-122](#))

10.3.12 Proposal to encode two small form CJK characters for Chinese U+16FF2..U+16FF3 ([L2/23-284](#))

10.3.13 Proposal to encode 28 Tangut ideographs (U+187F8..U+187FF U+18D09..18D1C) and 116 Tangut components (U+18D80..U+18DF3) ([N5217](#), [N5218](#))

- 10.3.14 Proposal to disunify Symbols for Legacy Computing from emoji  
U+1CCFA..U+1CCFC U+1CEBA..U+1CEBF U+1FBFA ([L2/23-252](#))
- 10.3.15 Request for 21 historical asteroid symbols U+1CEC0..U+1CED0 U+1F77..U+1F77A  
([L2/23-207](#))
- 10.3.16 Proposal to encode 16 Geomantic Figures U+1CEE0..U+1CEEF ([L2/23-218](#))
- 10.3.17 Proposal for ten Chemical Symbols U+1CEF0 U+1F8D0..U+1F8D8, ([L2/23-193R2](#))
- 10.3.18 Request for three musical symbols U+1D127..U+1D128 U+1D1FF ([L2/23-278R](#))
- 10.3.19 Request for 12 Stein-Zimmermann quarter-tone accidentals U+1D1EB..U+1D1F6  
([L2/23-276](#))
- 10.3.20 Request for 8 digits with slashes used in figured bass U+1D1F7..U+1D1FE ([L2/23-277](#))
- 10.3.21 Request for shatranj symbols U+1FA54..U+1FA57 ([L2/24-020](#))
- 10.4 Miscellaneous Proposals
- 11 Errata/modification
  - 11.1 Misspelled name of U+1680B: BAMUM LETTER PHASE-A MAEMBGBIEE ([L2/24-009r](#)) p7
- 12 Architecture issues
- 13 Liaison reports and new requests
  - 13.1 Unicode Consortium
  - 13.2 IETF
  - 13.3 SC22
  - 13.4 W3C
  - 13.5 SEI ([N5229](#))
  - 13.6 SAT
- 14 Other business
  - 14.1 Web site review
- 15 Future meetings
  - 15.1 Meeting 72 – seeking host
- 16 Closing
  - 16.1 Approval of Recommendations of meeting 71 (N52xx)
  - 16.2 Adjournment



Institute of South and Central Asia  
Faculty of Arts, Charles University  
students

# General Meeting Information and Logistics

ISO/IEC JTC1/SC 2

ISO/IEC JTC1/SC 2/WG 2

**June 2024, Monday 10<sup>th</sup> to Friday 14<sup>th</sup>**

**Prague, Czech Republic**

## Hosting organization

**Institute of South and Central Asia Students**

Nám. Jana Palacha 1/2, 116 42 Praha 1, Czech Republic

Primary contact: **Jan Kučera**

E-mail: [jan.kucera@ujca.cz](mailto:jan.kucera@ujca.cz)

Phone: +420 724 322 484

## Meeting venue



Meetings will be held in the **Green Room** (Zelená posluchárna), № 141 at Faculty of Arts, Charles University, in the very centre of Prague.

Address: **Celetná 20/562**, 110 00 Praha 1 – Old Town, Czech Republic  
<https://maps.app.goo.gl/r2TQ9V96ezj62E5H6>

Booked: 8:30—17:30 Monday to Friday

Capacity: 42 + 5, up to 10 extra seats available

Connectivity: WiFi available in the building 24/7.

Closest public transport stops:

- |                   |        |         |                    |
|-------------------|--------|---------|--------------------|
| Náměstí Republiky | 6 min  | Metro B | Tram 6, 8, 15, 26  |
| Muzeum            | 8 min  | Metro A |                    |
| Staroměstská      | 10 min | Metro A | Tram 2, 17, 18, 27 |

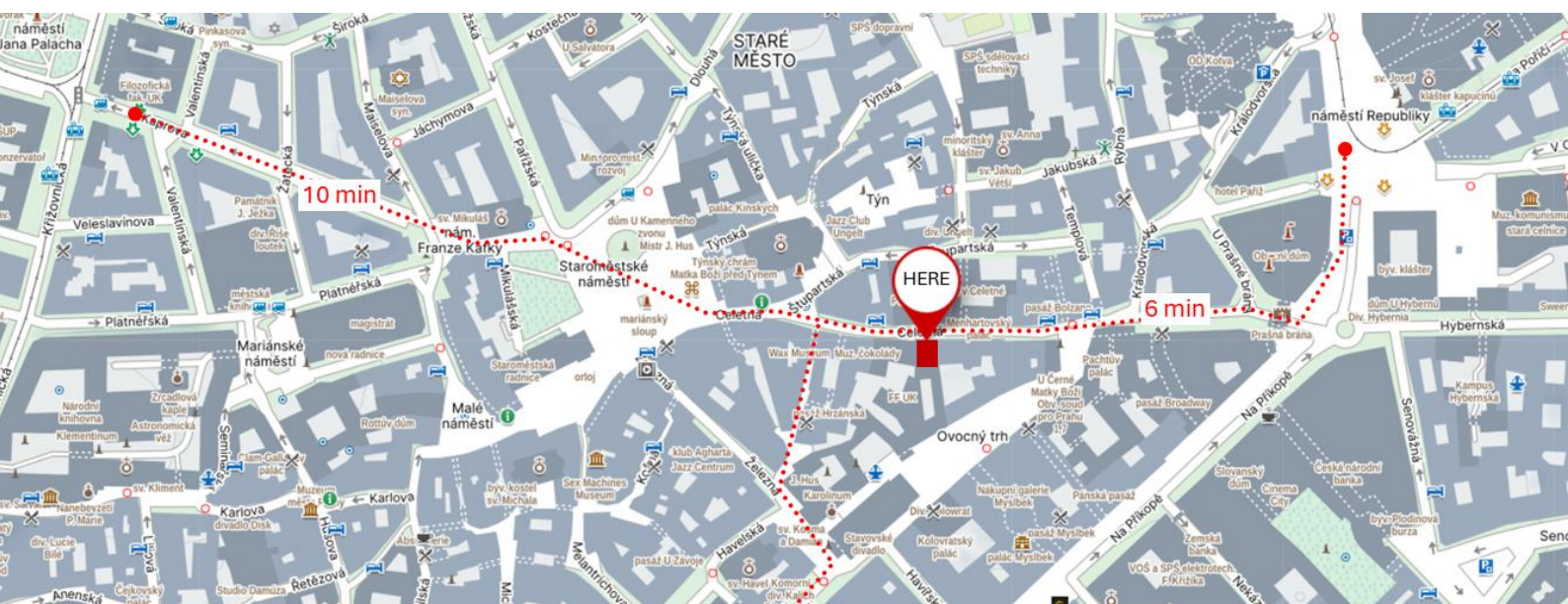

## Accommodation

Discounts might be available when booking multiple rooms, feel free to reach out to organizer for enquiries. Selection of hotels in walking distance from the meeting venue is available below. Cheaper options are available further from the city centre.

### Around €250/night



**Hotel Kings Court**  
U Obecního domu 3

🚶 5 min

[www.hotelkingscourt.cz](http://www.hotelkingscourt.cz)



**Grand Hotel Bohemia**  
Královská 4

🚶 3 min

[www.grandhotelbohemia.cz](http://www.grandhotelbohemia.cz)



**Buddha-Bar Hotel**  
Jakubská 8

🚶 4 min

[www.buddhabarhotelprague.com](http://www.buddhabarhotelprague.com)

### Around €130/night



**EA Hotel Royal Esprit**  
Jakubská 5

🚶 4 min

[www.hotelroyalesprit.cz](http://www.hotelroyalesprit.cz)



**Hotel Metamorphosis**  
Týn 10

🚶 2 min

[www.grandhotelbohemia.cz](http://www.grandhotelbohemia.cz)



**Clarion Hotel Prague**  
Hradební 9

🚶 12 min

[clarionhotelpragueoldtown.com](http://clarionhotelpragueoldtown.com)

### Around €90/night



**Hotel Central Prague**  
Rybná 8

🚶 5 min

[prague-central.hotel-rn.com](http://prague-central.hotel-rn.com)



**Hotel NYX**  
Panská 9

🚶 9 min

[www.leonardo-hotels.com](http://www.leonardo-hotels.com)



**ibis**  
Na Poříčí 5

🚶 10 min

[www.accorhotels.cz](http://www.accorhotels.cz)







## Public Transport

Prague has a reasonable public transport network, consisting of 3 underground metro lines, trams, buses, part of the railroad network, a trolleybus, a funicular and couple of ferries.

**Timetables** differ on Saturday and Sundays from the weekdays. Apart from online resources, timetables can be found printed at each stop. Typically, the transport runs often enough during the day that no ahead planning is needed. Night trams and buses are running at night from around 0:00 to 4:30, however, they have different numbering and routes. Metro does not run at night.

**Tickets** are time based and stay valid when switching between lines as well as transport modes. This includes ferries and part of the railroad network, however, the funicular requires at least 24 hours ticket (alternatively, separate ticket can be purchased on site).

 30 minutes	30 CZK (around €1)
 90 minutes	40 CZK (around €1,6)
 24 hours	120 CZK (around €5)
 72 hours	330 CZK (around €13)

The most convenient way to **purchase** tickets is through the official mobile app. For short term tickets listed above, no account is required.



PID lítačka (by Hlavní město Praha)

[Google Play](#) · [App Store](#)

Alternatively, tickets can be purchased at contactless terminals in all trams, buses and metro stations. Paper tickets are also available from points of sale as well as vending machines, mostly available in metro stations (also at the airport).

There are no barriers or checkpoints entering or exiting public transport vehicles. If you have a paper ticket, you need to validate it in a validator either inside tram/bus as soon as entered, or before entering a metro station. If you purchase tickets through the app, note that the purchase and activation steps are separate. You may be asked to produce a valid ticket at any point during the transport.

**Long-term** tickets are available (30/90/365 days) at points of sale, but either need a separate card made in your name, or are less financially attractive (anonymous ones starting at 1000 CZK/€40 for 30 days).

Selected public **transport maps** available for download:

 [Daytime metro and trams](#) ·  [Night trams and buses](#)

*Note: Most of the places of interest are within walking distance from the meeting venue.*



## Airport Transport

<https://www.prg.aero/en>

The international airport of Václav Havel (PRG) is located in the north-west of the city (Ruzyně). **Uber Airport** is the official taxi service of the airport and their taxi can be requested without any app either at self-service kiosks or at a service counter located in the arrival area.

It is, however, possible to use **public transport** to commute between the airport and the city centre. This trip is around 30 minutes, involves at least one change and it is covered by standard short-term tickets priced as above.

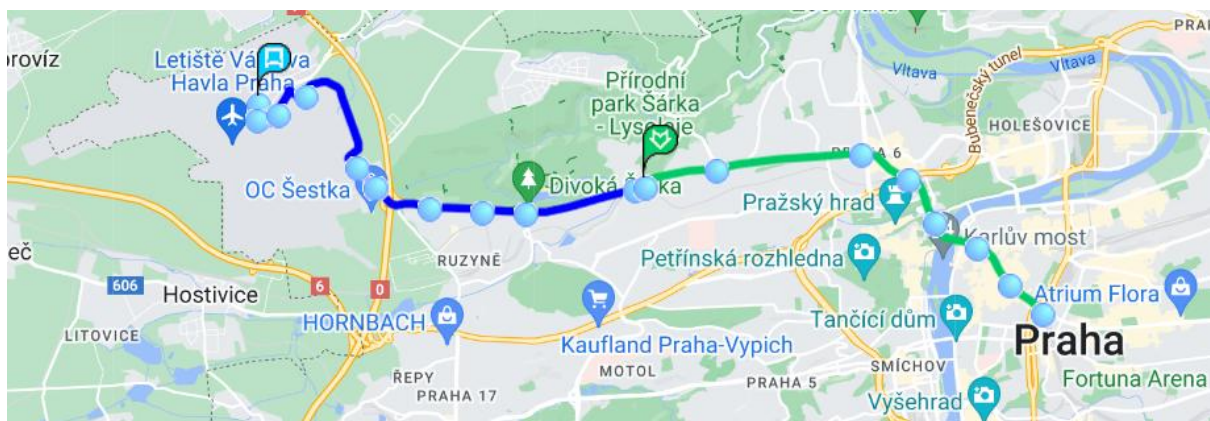

- From airport, take bus 119 to Nádraží Veleslavín, where you can switch to metro line A (green). Metro stops in the old city centre are Staroměstská, Muzeum, Můstek for line A, and Náměstí Míru and Můstek for line B (yellow).
- To airport, take metro line A (green) to Nádraží Veleslavín, where you can switch to bus 119. Get off either at Terminál 1 (for flights outside of Schengen area) or Terminál 2 (for flights within Schengen area).

*Note: Bus 119 is planned to be replaced by a brand-new trolleybus line 59 in spring.*

## Parking

<https://parking.praha.eu/en/parking-options-in-prague/>

Since the meeting venue is in the centre of old town which includes pedestrian zones, there is **very limited** options for public parking. It is recommended that cars are parked at one of the [Park & Ride](#) places and the trip to the city centre is done via public transport. Otherwise, Prague employs parking zones. Blue zones are for local residents only and unavailable to general public. You would be allowed to park in purple zones for a fee, should you find a space. Parking zones can be seen e.g. on this [map](#) (as blue/purple lines).

## Electricity

<https://www.iec.ch/world-plugs>

Standard electricity supply in Czech Republic is 230 Volts at 50 Hertz. The IEC plug types are C and E.

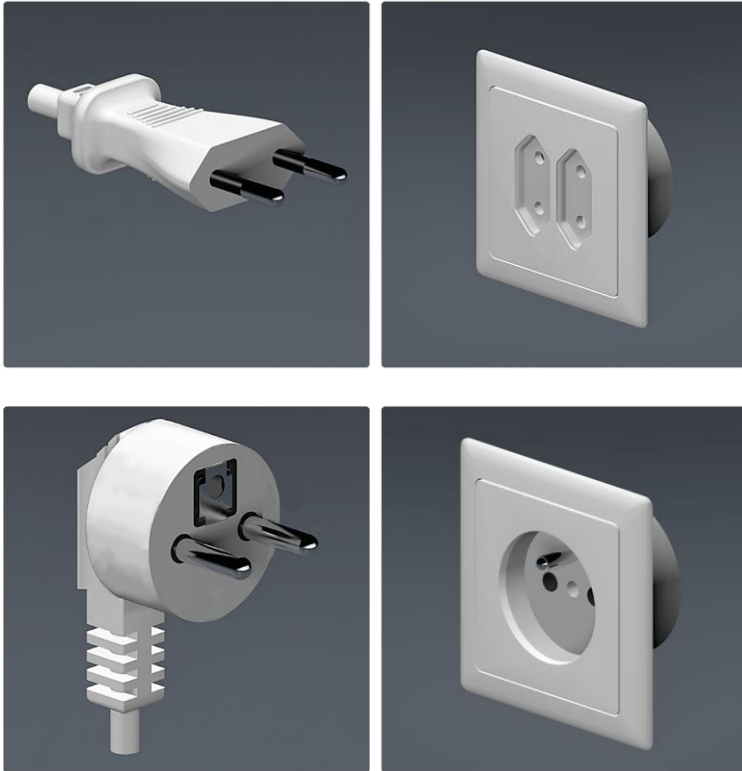

## Telecommunications

The international dialing prefix in Czech Republic is +420. Prepaid SIM cards without any subscription are available.

Internet access may be available in libraries, coffee shops, malls, certain shops and at hotels.

## Language

The official language of Czech Republic is Czech, a language of the Slavic family.

Most younger people should be able to communicate in English. The city centre is a busy tourist area and as such businesses are generally able to communicate in English as well. Note, however, that according to 2016 data, 74 % of the general population above 40 years of age cannot speak English.

# Currency

<https://www.cnb.cz/en/banknotes-and-coins/>

The currency in Czech Republic is Czech crown (CZK, Kč, koruna česká).

Currently valid denominations are as follows:



100 Kč



200 Kč



500 Kč



1000 Kč



2000 Kč



5000 Kč



1 Kč



2 Kč



5 Kč



10 Kč



20 Kč



50 Kč

Nearby currency exchange offices:

**Exchange Praha** 🚶 4 min  
[Jakubská 12](#)

**Czech Exchange** 🚶 7 min  
[Revoluční 3](#) (weekdays only)

# Credit and Debit Cards

Visa and MasterCard credit and debit cards should be widely accepted. American Express cards are NOT widely accepted, except for some hotel chains. Please contact your card provider prior to travel to ensure that your card can be used in Czech Republic.

## Taxes

Most goods and services are subject to Value Added Tax (VAT), which has the base rate of 21 %. Prices displayed in shops and restaurants already have VAT included.

Citizens of countries outside of the European Economic Area travelling by air are eligible for VAT refund for goods over 2000 Kč (around €80) when leaving the country.<sup>1</sup> However, special receipts need to be requested from the seller, one stating VAT REFUND and one COPY.

## Tipping

Tipping in sit-down restaurants is appreciated, usually to round up the value for easy change if paying cash.

2023 data from card payments indicate:

- Average tips were 6.12 %
- In around 21 % cases, customers weren't leaving any tips
- In around 37 % cases, tips were around 5 %
- In around 33 % cases, tips were around 10 %

## Restaurants

There are numerous restaurants in the immediate vicinity of the meeting venue, as well in the wider old town area. A list of suggested places will be provided closer to the meeting, which can be utilized for lunches. Lunches will not be organized by the host.

## Consular Assistance

 [https://mzv.gov.cz/jnp/en/diplomatic\\_missions/diplomatic\\_list.html](https://mzv.gov.cz/jnp/en/diplomatic_missions/diplomatic_list.html)

The Ministry of Foreign Affairs of the Czech Republic maintains a list of diplomatic missions to the Czech Republic, see the above link.

## Emergencies

The European general emergency number is **112**, which may be used for urgent help from police, firefighters, or for emergency medical assistance. Prague's municipal police 156. Participants are encouraged to obtain insurance prior to departure, neither host nor the Czech national body accept any liability for any loss of property or injury.

---

<sup>1</sup> This excludes tobacco products, alcohol and food.



Institute of South and Central Asia  
Faculty of Arts, Charles University  
students

# Visa Information

ISO/IEC JTC1/SC 2

ISO/IEC JTC1/SC 2/WG 2

**June 2024, Monday 10<sup>th</sup> to Friday 14<sup>th</sup>**

**Prague, Czech Republic**

## Hosting organization

**Institute of South and Central Asia Students**

Nám. Jana Palacha 1/2, 116 42 Praha 1, Czech Republic

Primary contact: **Jan Kučera**

E-mail: [jan.kucera@ujca.cz](mailto:jan.kucera@ujca.cz)

Phone: +420 724 322 484

Attendees in need of invitation letter for visa purposes are kindly asked to request their letter directly from the Czech Standardization Agency:

**Ing. Michaela Sersour (Ms.)**

[sersour@agentura-cas.cz](mailto:sersour@agentura-cas.cz)

Please include the following information in your request:

1. full identification of the SC and/or WG attending, that is:  
ISO/IEC JTC 1/SC 2 and/or ISO/IEC JTC 1/SC 2/WG 2;
2. your full name;
3. your address;
4. passport number;
5. date of birth;
6. any other information you require to be in the letter (if any).

Invitation letters will be sent by e-mail.

Note: The legal processing period for visa applications is 15 days, however, this can be extended to up to 45 days if further examination is needed. Leave enough time for your visa application.

Further information on the visa application process can be found on the website of the Ministry of Foreign Affairs of the Czech Republic:

[https://mzv.gov.cz/jnp/en/information\\_for.aliens/short\\_stay\\_visa/visa\\_for\\_a\\_stay\\_up\\_to\\_90\\_days\\_for\\_the\\_3.html](https://mzv.gov.cz/jnp/en/information_for.aliens/short_stay_visa/visa_for_a_stay_up_to_90_days_for_the_3.html)