



Nice

# On/Off-Control2

The new module for effortless control of two devices,  
from anywhere

Nice

# Compact casing, multiple inputs

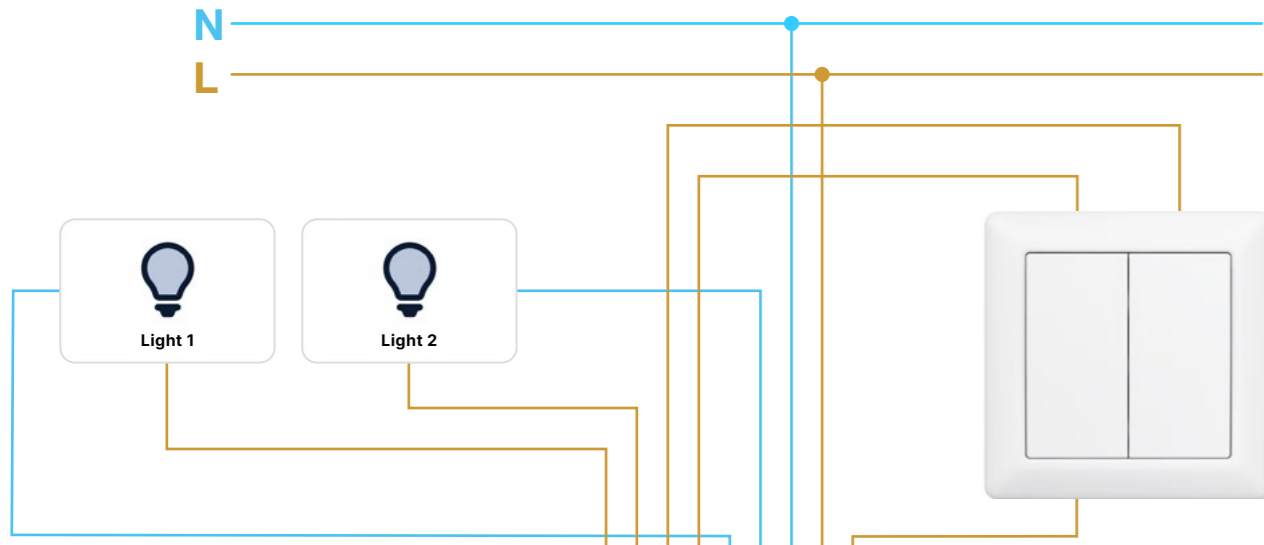

**New Z-Wave 800 chip**  
improves communication between the module and gateway significantly and extends devices range

**9 port plug-in terminal strip**  
optimizes the time needed for an installation and reduces the number of required additional connectors

**PROG button and status LED**

## Z-Wave 800 Series protocol

- **Extended Range:** enjoy reliable connectivity across larger spaces.
- **Enhanced Security:** benefit from advanced encryption for greater protection.
- **Improved Performance:** faster processing for smoother operation.
- **Energy Efficient:** consumes less power, reducing your environmental impact.

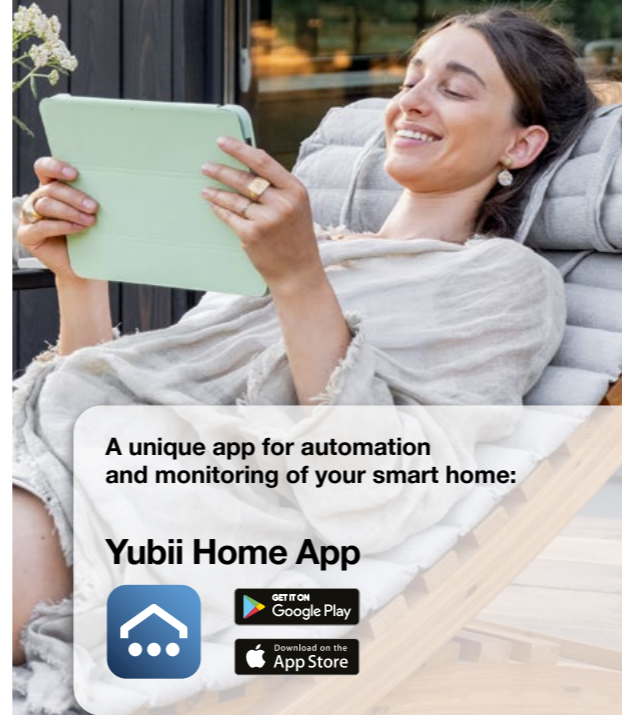

**A unique app for automation and monitoring of your smart home:**

**Yubii Home App**



Nice

## Independent control of two loads

Independently or together, manage two devices with ease. Each channel offers 5A for resistive loads or 80W for LEDs, and you can monitor energy consumption for both. Whether you're setting the mood or optimizing energy efficiency, this module is your ultimate smart home companion.

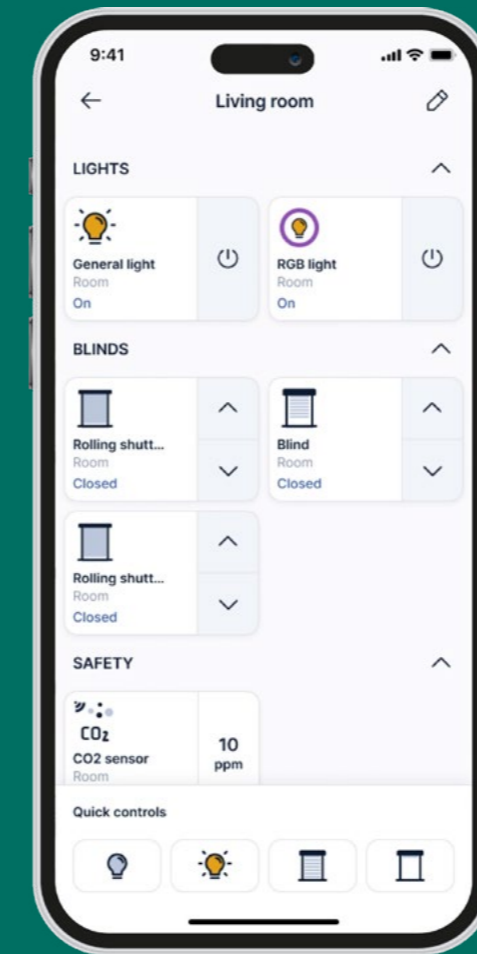

## Real-time voltage monitoring

The module's advanced voltage monitoring capabilities allow you to track mains condition and create smart scenes based on real-time data. Perfect for homes with solar panels, it helps you maximize self-consumption and minimize your carbon footprint.

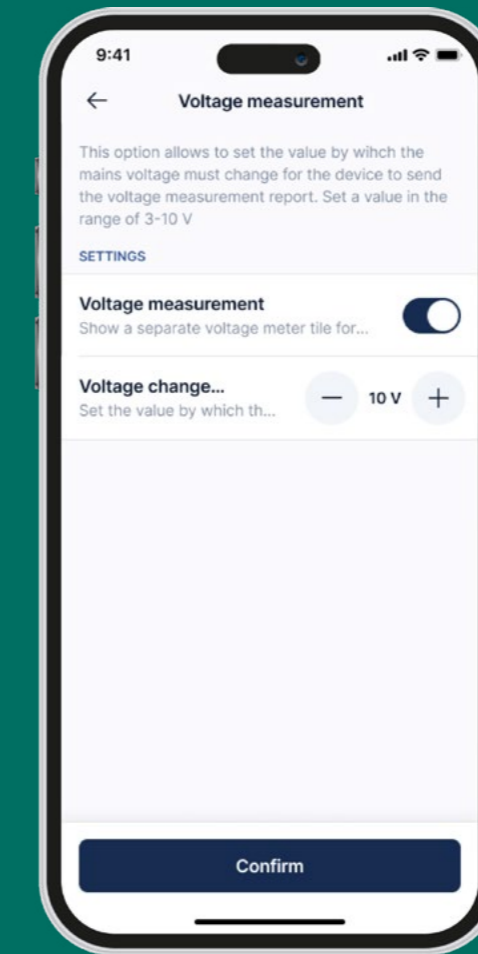

## Custom Auto-Off scenarios

Easily set up one-time events to automatically turn off specific devices after a set time. Perfect for temporary lighting, heating, or irrigation needs.

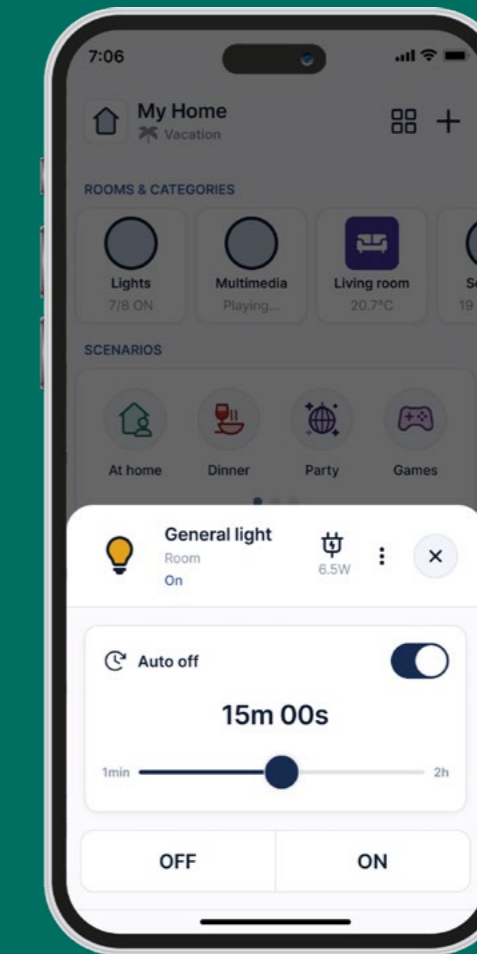

## Quick and easy configuration

Simplify the installation process with the new in-app wizard. Add and configure your device in just a few steps, directly from Yubii Home app.

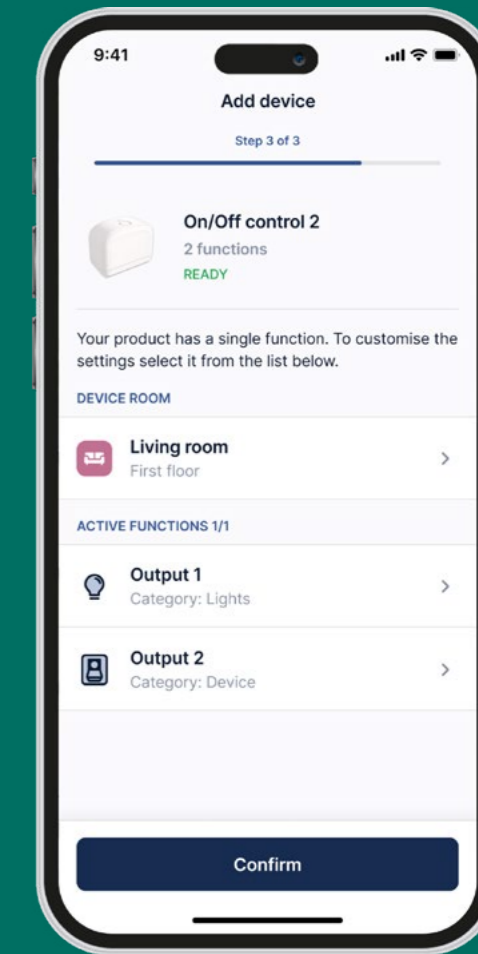



Nice

# On/Off-Control2

Module for remote On/Off control of two circuits or appliances.

WORKS WITH NICE GATEWAYS:

Yubii Home Pro

Yubii Home

WORKS WITH FIBARO GATEWAYS:

Home Center 3

Home Center 3 Lite



LIGHTS ON/OFF



230V LAMP MANAGEMENT



HOME APPLIANCE MANAGEMENT 230V



MEASUREMENT OF ENERGY CONSUMPTION



LED CERTIFIED



MAINS VOLTAGE MEASUREMENT



AUTO-OFF

The On/Off-Control2 is installed in a wall-mounted box and can control two devices with maximum total power of 2300W (2x1150W) for resistive/incandescent loads or 160W (2x80W) for LED loads.

It can be turned on either remotely via the mobile app, or via a traditional wall switch.

The device can measure energy consumption and active current power and mains voltage.

**Supported device type:**

- Incandescent bulbs
- LEDs
- Conductors
- Fluorescent lamps
- Electronic transformers
- Ferromagnetic transformers
- Halogens
- Other electrical appliances matching the devices electrical specifications, f.e. TV's, sound systems, coffee makers etc.

**Main features:**

- Compatible with Z-Wave+ and Z-Wave controllers. Works also as a repeater.
- Supports secure mode (Z-Wave network security mode): S0 with AES-128 and S2 encryption.
- Autentication with PRNG encryption.
- Advanced microprocessor control.
- Active power, energy and mains voltage measurement function.
- Works with various types of switches.
- Works with LED loads.
- Simultaneous or independent outputs control.
- Spring-based quick connector and additional terminals available for even faster installation.
- First configuration creator (wizard), easy devices grouping and Auto-Off function, all conveniently managed through the Yubii Home app.



**TECHNICAL SPECIFICATIONS**

Code	Description	Pcs./pack	Certificates
<b>ON/OFF-CONTROL2</b>	Module for remote On-Off control of up to two circuits or appliances	1	CE

Code	ON/OFF-CONTROL2
Input power	100-240V~50/60Hz
Nominal resistive/incandesent bulbs/halogens channel current	2 x 5A (10A overall)
Nominal LED/fluorescent lamp real power	2 x 80W
Nominal electronic transformers (LED/CCFL External Ballast Lamp) channel current	2 x 2A
Operating temperature (°C Min/Max)	0 - 35
For installation in wall-mounted boxes (mm)	Ø >= 50, depth >= 60
Radio protocol	Z-Wave (800 series)
Radio frequency (MHz)	868.4 or 869.8 (EU) / 919.8 or 921.4 (AH)
Radio range (m)	up to 100m outdoors, up to 30m indoors (depending on building structure)
Compliant with European directives	RoHS 2011/65/EU - RED 2014/53/EU
Dimensions (mm)	46 x 36 x 19.9 h

Nice

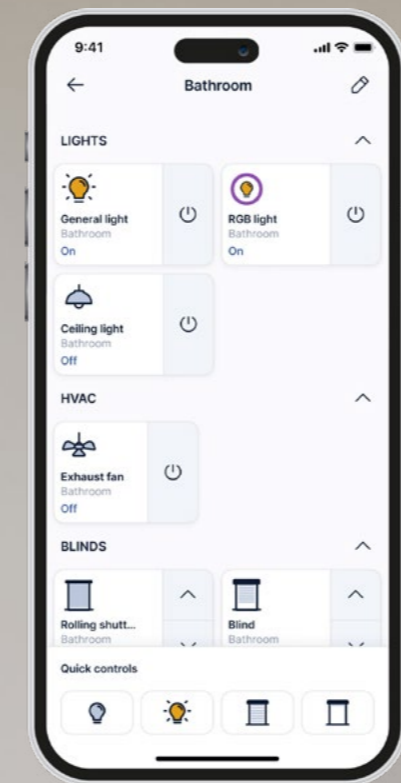

Yubii

Z-Wave

# We imagined the freedom to explore the world and turned it into a house-system.

Connected, integrated and customisable.  
Safe and easy to use. The smart home system  
is the Nice project that puts the way you want to live  
at the centre of the automation.

Even when you're busy exploring the world.

[www.niceforyou.com](http://www.niceforyou.com)

**Nice SpA**  
Oderzo, TV, Italy

