

Nice

New  
**Era Fit<sup>S</sup> BD,**  
BiDirectional  
tubular motor



Nice

BiDi Yubii 230 Vac

# Era Fit<sup>S</sup> BD

With electronic limit switch and built-in bidirectional radio receiver

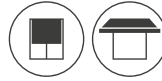

**Tubular motor with electronic limit switch and built-in bidirectional radio receiver.**

**S size**  
Ø 35 mm

**Smart**

The Nice bidirectional radio protocol enables confirmation of correct reception of the command by the automation and the possibility of checking the position of the blind or rolling shutter. As it also supports the Nice mesh network function, the motor can route the radio command, thus extending the radio range of the system.

**Handy remote control of limit switches** by transmitter in manual or semi-automatic mode.

**Easy to programme, thanks to feedback** from movement of the rolling shutter.

**Level programming: quick and safe.**

Thanks to this function, there are a number of possible settings. If an incorrect selection is made, programming begins again from the previous level without the need to reprogramme all the settings programmed up to that point.

**Memory locking to prevent accidental memorising.**

**Connection to climatic sensors** via radio with user-friendly programming.

The built-in circuit board allows **a number of motors to be connected and controlled in parallel** from a single point without the need for additional control units.

**Low consumption in stand-by.**

Compatible with previous versions of Nice unidirectional transmitters.

Code	Description	Pcs./pack	Certificates
<b>E FIT S 619 BD</b>	Electronic limit switch, built-in bidirectional radio receiver. 6 Nm, 19 rpm	1	NF CE
<b>E FIT S 1014 BD</b>	Electronic limit switch, built-in bidirectional radio receiver. 10 Nm, 14 rpm	1	NF CE

**TECHNICAL SPECIFICATION**

Code	E FIT S 619 BD	E FIT S 1014 BD
<b>ELECTRICAL SPECIFICATIONS</b>		
Power supply (VAC/Hz)	230/50	
Absorption (A)	0,49	
Power (W)	116	
Absorbed power in stand-by (W)	<0,5	
<b>PERFORMANCE</b>		
Torque (Nm)	6	10
Speed (rpm)	19	14
Lifted weight* (kg)	12	18
Number of turns before the stop	>100	
Continuous operating time (min)	4	
<b>DIMENSIONAL DATA</b>		
Length (L) (mm)	596	
Weight of motor (kg)	1,4	
Pack dimensions (mm)	95x95x605	

**Protection class IP44.**  
\*Value calculated with 40 mm diameter octagonal roller.

**POWER CABLE**

Length 1.5 m, 3 wires in cable



**DIMENSIONS**

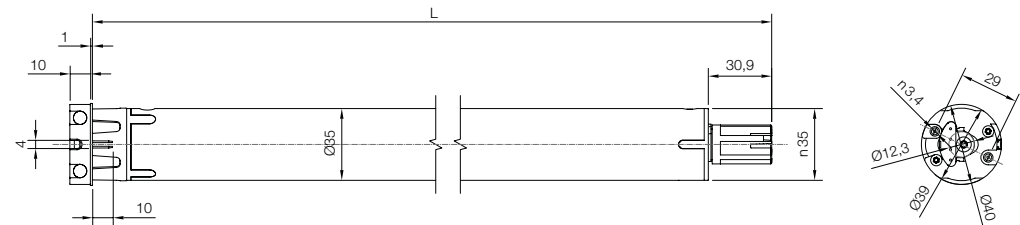

# Supports

## S series Ø 35 mm

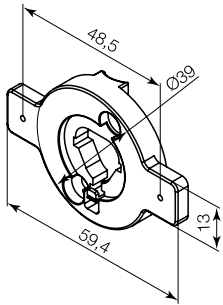

**221440001**  
Intermediate plate (must be used with support 233220001 or 231080001)

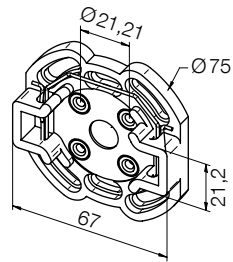

**233220001**  
Motor support  
Centre distance 48 and 60, with slot (for use with 221440001)

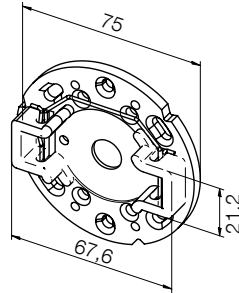

**231080001**  
Motor support  
Centre distance 48 and 60 (for use with 221440001)

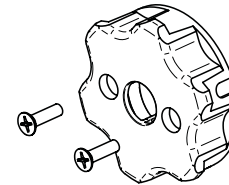

**233759001**  
Set of motor support plates for use in star-shaped supports.  
Also suitable for maintenance work and to replace previous applications

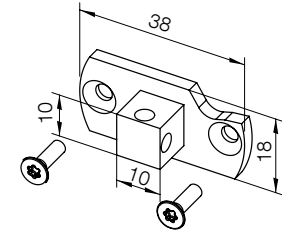

**220400001**  
10x10 mm complete with mounting accessories

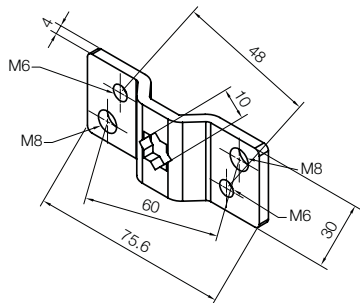

**162728**  
Bracket 10x10 mm

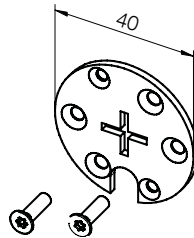

**220640001**  
Cross = 13 mm with mounting accessories

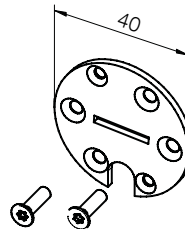

**220650001**  
Size = 16.4 mm with mounting accessories

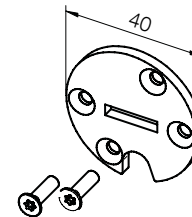

**220800001**  
(size 15 x 3 mm), Benthin with mounting accessories

# We make even the smallest of gestures extraordinary.

## Nice, a world without barriers.

Automation and control systems for gates, garage doors, blinds, awnings and rolling shutters and alarm systems for all types of space, from private homes to large public buildings.

[www.niceforyou.com](http://www.niceforyou.com)

Nice SpA  
Oderzo, TV, Italy



Nice takes care of the environment. By using natural paper, we avoid excessive use of raw materials and exploitation of the forests. Waste is reduced, energy is saved and climate quality is improved.