

Edge Blending Setup Guide for BrightLink 1485Fi and PowerLite EB- 800F Series

Contents

| | |
|--|-----------|
| About Edge Blending | 5 |
| Edge Blending Requirements | 6 |
| Initial Setup for Projectors | 8 |
| Connecting Multiple Projectors of the Same Model | 8 |
| Projector Identification System for Multiple Projector Control | 10 |
| Setting the Projector ID | 10 |
| Setting the Remote Control ID | 11 |
| Calibrating Automatically (BrightLink 1485Fi) | 12 |
| Performing Touch Unit Setup (BrightLink 1485Fi) | 14 |
| Multiple Projector Connection Menu Settings | 19 |
| Scaling an Image | 22 |
| Projection Area Adjustments for Edge Blending | 24 |
| Adjusting Color Uniformity | 24 |
| Correcting Image Shape with Point Correction | 28 |
| Blending the Image Edges | 30 |
| Color Adjustment for Edge Blending | 34 |
| Adjusting the Projector's Brightness Level | 34 |
| Matching the Image Colors | 36 |
| Adjusting the Black Level | 38 |
| Completing the Edge Blending Set-up | 42 |
| Calibrating for Finger Touch Interactivity (BrightLink 1485Fi) | 42 |
| Configuring the Display Settings | 46 |
| Copyright Notice | 48 |
| A Note Concerning Responsible Use of Copyrighted Materials | 48 |
| Trademarks | 48 |
| Copyright Attribution | 49 |

About Edge Blending

This guide explains how to set up your computer and multiple projectors to project a single, unified image using the Edge Blending feature.

If you are setting up two adjacent BrightLink projectors, the DuoLink feature lets you draw seamlessly across the projected images.

This guide is intended for use with the following projectors:

- BrightLink 1485Fi
- PowerLite EB-800F
- PowerLite EB-805F

Note: The illustrations and screen captures in this guide are intended only for representative purposes. While the specific items shown may not be identical to the ones on your product, the steps are the same unless stated otherwise.

Edge Blending Requirements

In order to use the Edge Blending feature, you must have the following hardware:

Hardware

- DuoLink Interactive Setup:
 - Two BrightLink 1485Fi projectors
 - Two HDMI video cables
 - Two USB-A to USB-B cables
 - Stereo mini cable
 - A Windows computer running Windows 7, Windows 8.x, Windows 10, or Windows 11, or a Mac running OS X 10.7 to 10.11, macOS 10.12 to 10.15, macOS 11.x, or macOS 12.x
- Non-interactive Setup:
 - Two to four PowerLite EB-800F or EB-805F projectors
 - Two to four HDMI video cables (same number as projectors being used)
 - A Windows computer running Windows 7, Windows 8.x, Windows 10, or Windows 11, or a Mac running OS X 10.7 to 10.11, macOS 10.12 to 10.15, macOS 11.x, or macOS 12.x

Notes on Installation

- See your product's online *Installation Guide* for installation steps and refer to the Edge Blending tab of the Projector Throw Distance Simulator [here](#).
- Install the projectors overlapping the blend area and adjust the projected images as much as possible using the roll, pitch, and yaw adjustments on your mounts to minimize the need for electronic adjustments (Point Correction feature can only adjust up to 32 pixels (1.38 inches [35 mm]) for each adjusting point). See your product's online *Installation Guide*.
- Make sure to adjust the focus of the projectors.

DuoLink Interactive Setup

For a DuoLink interactive setup, projectors should be installed the same distance from the center line of the whiteboard and create a 3:1 aspect ratio (combined image width should be three times the height).

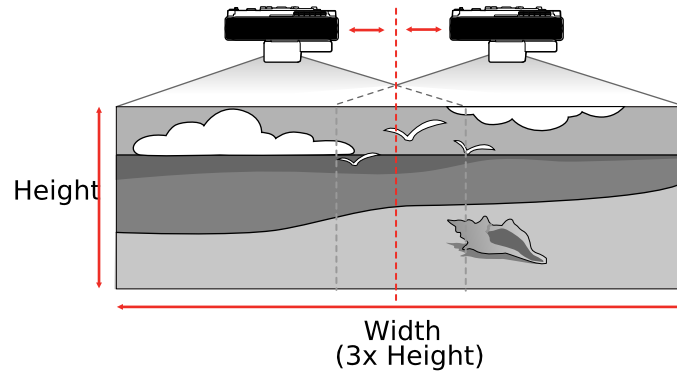

Non-interactive Setup

For a non-interactive setup, it is recommended that you set the Blend Range setting to **256** pixels, or blend between 15% and 25% of each projector's screen.

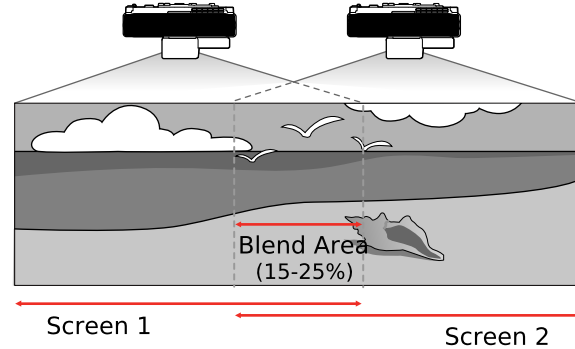

Initial Setup for Projectors

Follow the instructions in these sections to set up your projectors to project a unified image using Edge Blending.

[Connecting Multiple Projectors of the Same Model](#)

[Projector Identification System for Multiple Projector Control](#)

[Calibrating Automatically \(BrightLink 1485Fi\)](#)

[Performing Touch Unit Setup \(BrightLink 1485Fi\)](#)

[Multiple Projector Connection Menu Settings](#)

[Scaling an Image](#)

Connecting Multiple Projectors of the Same Model

For a non-interactive setup, you can connect up to four projectors of the same model in the same room to project a single unified image. For a DuoLink interactive setup, you can connect two BrightLink 1485Fi projectors in the same room to project a single, interactive unified image. Wait to power on the projectors until all connections have been made.

Note: The interactive features are available only when connecting two BrightLink 1485Fi projectors. The two projectors must be synchronized using the optional remote control cable set (V12H005C28) and a USB-A to USB-B cable.

Note: You can also connect your computer to the HDMI and USB ports on your projector's control pad, if equipped.

1. Connect the computer and the projectors using HDMI cables as shown.

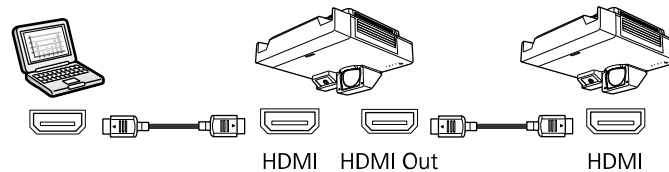

Note: If you are connecting three or more projectors in a non-interactive setup, connect the projectors in a chain as shown.

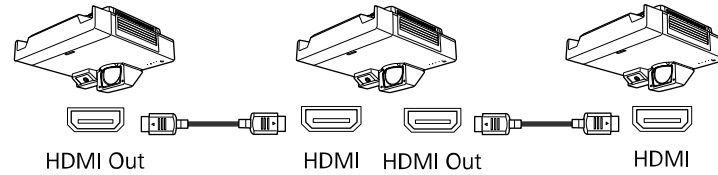

2. If you are using interactive features (BrightLink 1485Fi), connect one end of the stereo mini cable to the **SYNC Out** port starting from the projector on the left, and connect the other end to the **SYNC In** port on the other projector.

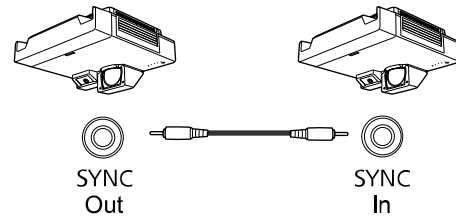

3. If you are using interactive features (BrightLink 1485Fi), connect the computer and the projectors using USB cables as shown.

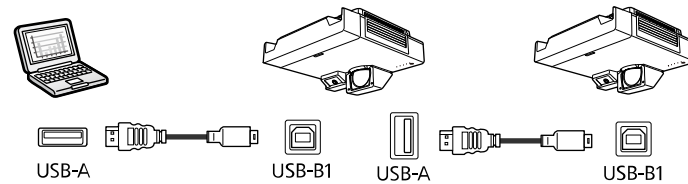

Note: If you used the **HDMI3** port for any projector in step 1, make sure to connect the USB cable to that projector's **USB-B2** port instead.

4. After making the appropriate connections, you need to adjust the necessary projector menu settings.
5. Power on the projectors and wait 30 minutes for the images to stabilize before adjusting projector settings.

Note: If you adjusted the projector mount before making cable connections, double-check the projector mount adjustments. See your product's online *Installation Guide* for more information.

To control multiple projectors using one remote control, set the ID for each projector. See the link below.

After that, if you are using interactive features (BrightLink 1485Fi), perform auto calibration, then Touch Unit setup on each projector. See the links below.

Parent topic: [Initial Setup for Projectors](#)

Related concepts

[Projector Identification System for Multiple Projector Control](#)

Related references

[Multiple Projector Connection Menu Settings](#)

Related tasks

[Performing Touch Unit Setup \(BrightLink 1485Fi\)](#)

[Calibrating Automatically \(BrightLink 1485Fi\)](#)

Projector Identification System for Multiple Projector Control

You can operate multiple projectors using one remote control for more elaborate presentations. To do this, you assign an identification number to each projector and to the remote control. Then you can operate all the projectors at once or individually.

[Setting the Projector ID](#)

[Setting the Remote Control ID](#)

Parent topic: [Initial Setup for Projectors](#)

Setting the Projector ID

If you want to control multiple projectors from a remote control, give each projector a unique ID.

1. Press the **Menu** button.
2. Select the **Multi-Projection** menu and press **Enter**.

3. Select **Projector ID** and press **Enter**.

| | |
|------------------|--------|
| [Projector ID] | Return |
| ✓ Off | |
| 1 | |
| 2 | |
| 3 | |
| 4 | |
| 5 | |
| 6 | |
| 7 | |
| 8 | |
| 9 | |

4. Press the arrow buttons on the remote control to select the identification number you want to use for the projector. Then press **Enter**.

Repeat these steps for all the other projectors you want to operate from one remote control.

Note: If you don't know the projector's ID, aim the remote control at the projector and press the **ID** button to temporarily display the projector's ID on the screen.

Parent topic: [Projector Identification System for Multiple Projector Control](#)

Setting the Remote Control ID

The remote control's ID is set to zero by default so it can operate any compatible projector. If you want to set the remote control to operate only a particular projector, you need to set the remote control's ID to match the projector's ID.

1. Turn on the projector you want the remote control to operate with exclusively.
2. Make sure you know the projector's ID number as set in the Multi-Projection or Installation menu **Projector ID** setting.
3. Aim the remote control at that projector.

4. Hold down the **ID** button on the remote control while you press the numeric button that matches the projector's ID. Then release the buttons.

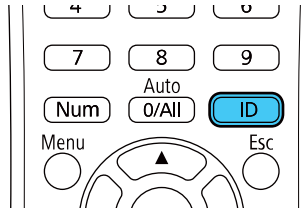

The remote control's ID is set.

Note: If the batteries are left out of the remote control for an extended period, the remote control ID returns to its default setting.

Parent topic: [Projector Identification System for Multiple Projector Control](#)

Calibrating Automatically (BrightLink 1485Fi)

If you are setting up multiple projectors for a DuoLink interactive setup, run Auto Calibration and then Touch Unit setup on each projector. You do not need the pens or a computer for Auto Calibration.

Note: You can start Auto Calibration by pressing the **User** button on the remote control or by pressing the **Menu** button on the remote control as described here.

Note: Before performing Auto Calibration, disable Edge Blending in the projector's menus, and on the projector that isn't currently being calibrated, disable the Touch Unit and then enable A/V mute.

1. Press the **Menu** button, select the **Pen/Touch** menu, and press **↵ Enter**.

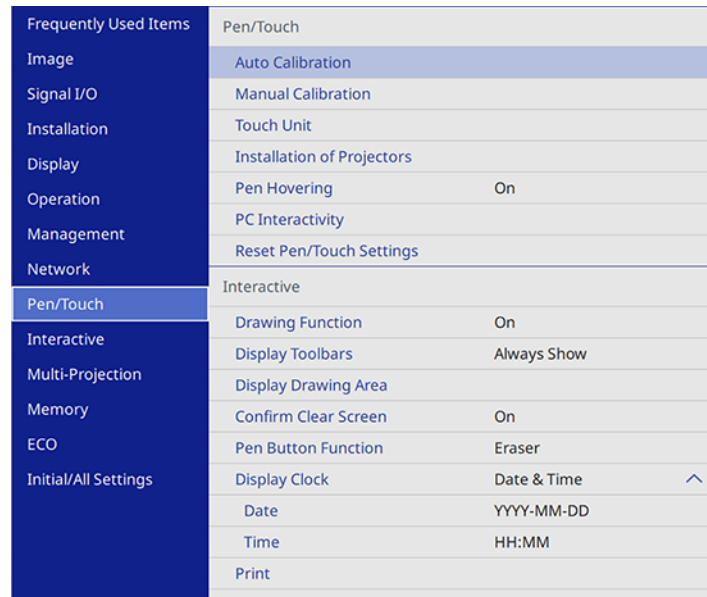

2. Select **Auto Calibration** and press **↵ Enter**.

This screen appears:

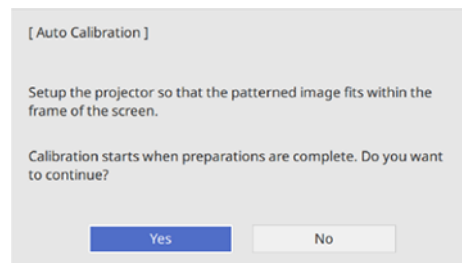

3. Adjust the image focus, if necessary.
4. Check that the image pattern fits into the projected display, then press **↵ Enter** to select **Yes**.

A pattern appears then disappears, and the system is calibrated. If you see a message that calibration failed, you need to calibrate manually.

The cursor location and pen position should match after calibration. If not, you may need to calibrate manually. See your product's online *User's Guide* for manual calibration steps.

If you are completing an interactive setup, next run Touch Unit setup. After that, perform Auto Calibration and Touch Unit setup on the second projector, if you haven't done so already. See the link below for Touch Unit setup.

Parent topic: [Initial Setup for Projectors](#)

Performing Touch Unit Setup (BrightLink 1485Fi)

Perform Touch Unit setup to adjust the angle of the laser light coming from the Touch Unit so that it can detect the position of your fingers.

Note: Make sure you have calibrated the pens, installed the Touch Unit, and turned the Touch Unit on before performing Touch Unit setup. See the online *Installation Guide* for Touch Unit installation information and click the link below for pen calibration instructions.

Note: Make sure the Edge Blending feature is disabled and enable A/V Mute on the projector in the setup that is not currently being adjusted.

1. Press the **Menu** button, select the **Installation** menu, and press **↵ Enter**.
You see a screen like this:

| | | |
|----------------------|----------------------------------|-------------------|
| Installation | Setting Plate Installation Guide | |
| Display | Vertical Installation | No |
| Operation | Projection | Front/Upside Down |
| Management | Auto Screen Adjustment | |
| Network | Geometry Correction | Point Correction |
| Pen/Touch | Digital Zoom | ▼ |
| Interactive | Connect ELPCB02 | Off |
| Multi-Projection | Touch Unit | |
| Memory | Remote Receiver | Off |
| ECO | Screen Type | 16:9 ▼ |
| Initial/All Settings | High Altitude Mode | Off |
| | Reset Installation Settings | |
| | Display | |
| | Pattern Display | |
| | Pattern Type | |

2. Select **Touch Unit** and press **↵ Enter**.
You see a screen like this:

| | |
|----------------------|--------|
| [Touch Unit] | Return |
| Installation Pattern | |
| Power | On |
| Touch Unit Setup | |
| Touch Calibration | |
| Calibration Range | Wide |

3. Select **Touch Unit Setup** and press **↵ Enter**.

The following screen appears:

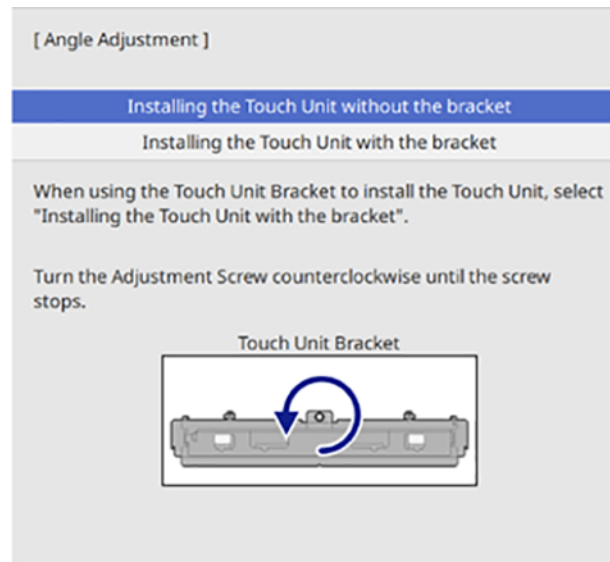

4. Select the option for the Touch Unit installation method that was used and press **↵ Enter**.
5. If you are using the Touch Unit Bracket, turn the adjustment screw on the bracket counterclockwise until it stops.
6. Attach the two markers to the positions shown on the projected screen making sure the thinner ends of the markers are facing the Touch Unit.

Note: Do not place anything other than the markers near the projected image during angle adjustment. If other objects are on or near the projected image, angle adjustment may not be performed correctly.

7. Move each marker over the projected cross until the lines of the cross align with the lines on the marker. Make sure to match the positions so that the crosses overlap with the points on the marker positions.

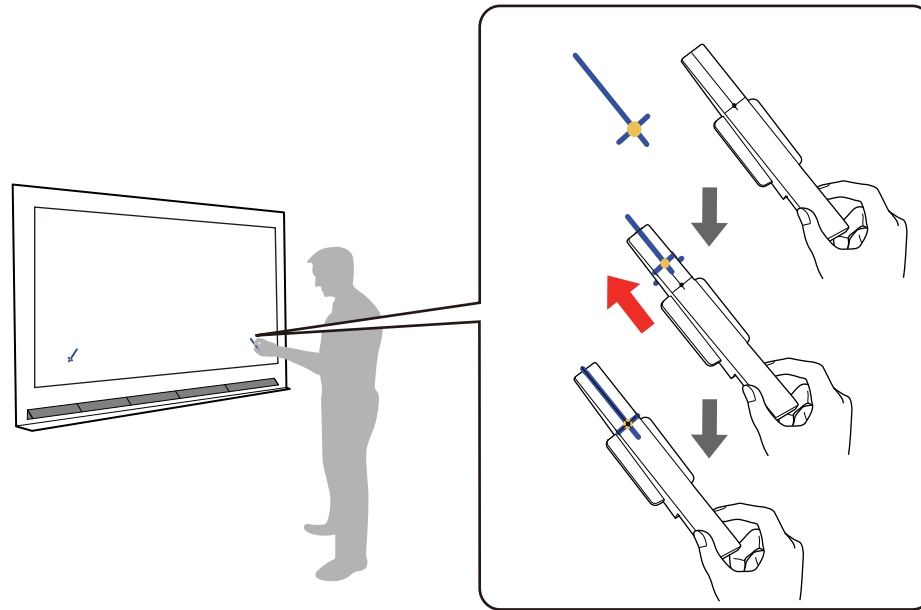

Note: If the magnets won't attach to the screen completely, wipe the area to remove any dirt and try again. For non-magnetic screens, use the supplied tape to secure the markers.

8. Press **↵ Enter** on the remote control or control panel to begin the auto adjustment.
9. When adjustments are complete, remove the markers.

Note: If auto adjustment fails and the Touch Unit is mounted using the bracket, follow the instructions on the screen to manually adjust the angle of the laser and run auto adjustment again. If auto adjustment fails and the Touch Unit is directly on the whiteboard, try repositioning the Touch Unit and make sure there is no sunlight on the board, there are no objects near the board, and the markers have not moved.

10. Touch each of the four yellow circles on the screen and verify that the gray touch indicator appears in the correct position.

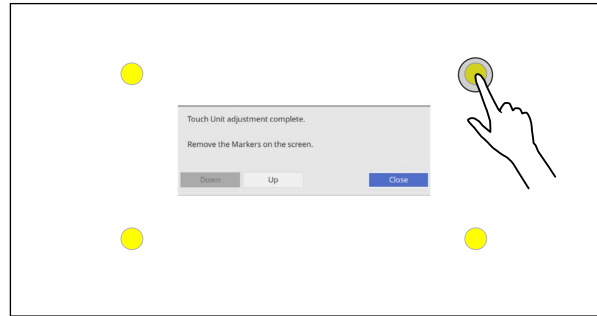

Note: Finger touch operations may not function correctly if you are wearing bandages, artificial nails, nail polish, or anything else that may obstruct your fingers.

If the gray indicators do not appear where you touched the screen, you need to manually adjust the Touch Unit alignment.

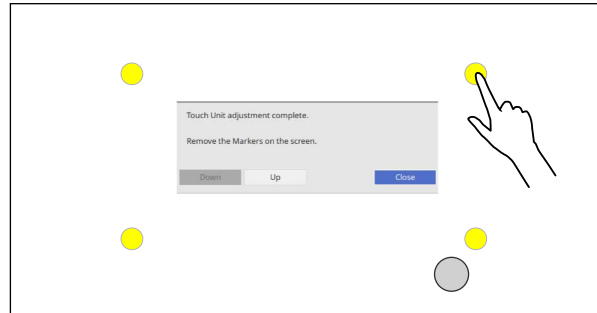

11. Select **Up** using the remote control or control panel and press **↵ Enter**.
Try touching the four dots again and repeat this process until the touch indicators appear in the correct position.
12. When you are finished with adjustments, select **Close**.
13. Perform Auto Calibration and Touch Unit setup for any remaining projector. See the link below for Auto Calibration.

Parent topic: [Initial Setup for Projectors](#)

Related tasks

[Calibrating Automatically \(BrightLink 1485Fi\)](#)

Multiple Projector Connection Menu Settings

After connecting multiple projectors to project a unified image, see the tables below to select the correct projector menu settings. Make sure your computer is connected to Projector 1 (the left-most projector in your setup).

Interactive Setup (BrightLink 1485Fi)

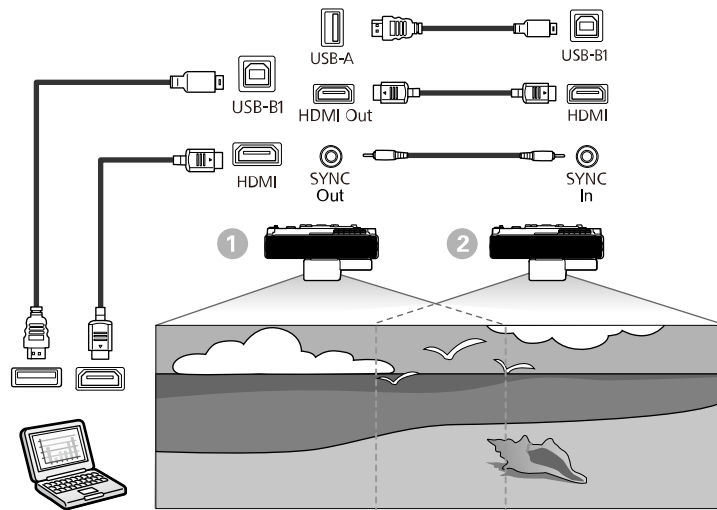

Note: Whiteboard width must be three times its height.

| Setting | Projector 1 | Projector 2 |
|------------------------|------------------|------------------|
| Image Menu | | |
| Color Mode | Multi-Projection | Multi-Projection |
| Signal I/O Menu | | |
| EDID | 3240 x 1080/60Hz | 3240 x 1080/60Hz |
| Pen/Touch Menu | | |

| Setting | Projector 1 | Projector 2 |
|--|---|--------------------|
| Installation of Projectors > Sync of Projectors | Wired | Wired |
| Multi-Projection Menu | | |
| HDMI Out Setting | Process Out | Process Out |
| Order | Specify the position of the projectors in number order from left to right | |
| Connect Computer | Yes | No |
| Edge Blending > select any edge > Blend Start Position | 0 | 0 |
| Edge Blending > select the overlapped edges > Blend Range | 600 (Right Edge) | 600 (Left Edge) |
| Scale | Auto | Auto |
| Projector ID | Select the correct projector IDs for each | |

Note: Make sure an active computer signal is connected to the projector or the Scale option will not be displayed.

Note: PC Free Whiteboard, PC Free tools, and the projector control toolbar are not available once you change the HDMI Out setting to **Process Out**. Use the projector's remote to control the projector, change sources, or perform other functions. Download Easy Interactive Tools from the projector's support page to use Whiteboard and Annotation functionality.

Note: If you are using the projectors in the same room as another projector that does not support multi-projector connections, set the **Installation of Projectors > Infrared Intensity** setting to **Strong**.

Non-interactive Setup (2-4 Projectors)(PowerLite EB-800F/EB-805F)

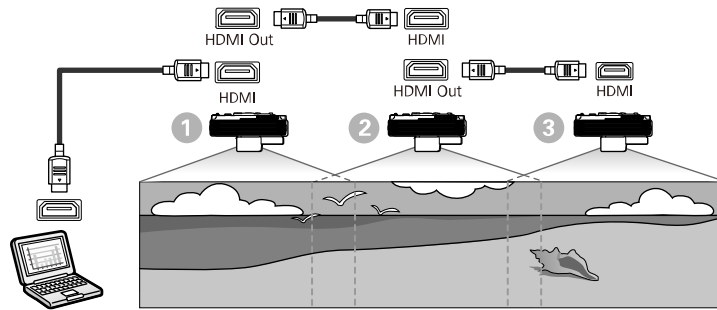

| Setting | Projector 1 | Projectors 2-4 |
|--|---|-------------------------|
| Image Menu | | |
| Color Mode | Multi-Projection | Multi-Projection |
| Multi-Projection Menu | | |
| Projector ID | Select the correct projector IDs for each | |
| HDMI Out Setting | Pass Through | Pass Through |
| Number of Projectors | Specify the number of projectors connected in a series | |
| Order | Specify the position of the projectors in number order from left to right | |
| Edge Blending > select any edge > Blend Start Position | 0 | 0 |
| Edge Blending > select the overlapped edges > Blend Range | 256* | 256* |

*For a non-interactive setup, it is recommended that you set the Blend Range setting to **256** pixels, or blend between 15% and 25% of each projector's screen. Refer to the Edge Blending tab of the online Projector Throw Distance Simulator [here](#).

Parent topic: [Initial Setup for Projectors](#)

Scaling an Image

You can project the same image from multiple projectors and use the Scale feature to crop and combine them into one large image.

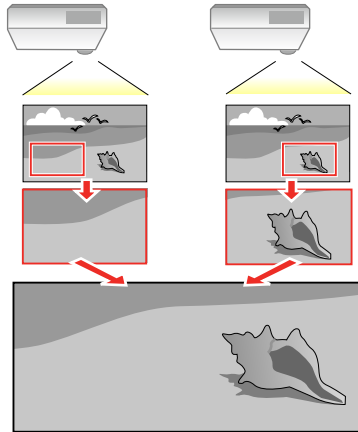

1. Press the **Menu** button.
2. Select the **Multi-Projection** menu and press **↵ Enter**.
3. Select the **Scale** setting and press **↵ Enter**.

You see this screen:

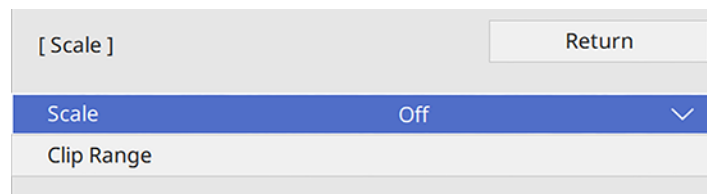

Note: Make sure an active computer signal is connected to the projector or the Scale option will not be displayed.

4. Select one of the following as the **Scale** setting:
 - For a DuoLink interactive setup, select **Auto** to automatically adjust the clipped areas according to the **HDMI Out Setting** and **Edge Blending** settings you selected
 - For a non-interactive setup, select **Manual** to adjust the clipped areas manually
5. Select the **Scale Mode** setting and select one of these options:
 - **Zoom Display** to maintain the image aspect ratio as you scale the image

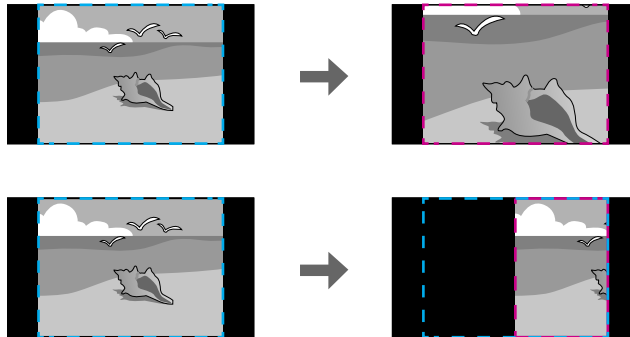

- **Full Display** to adjust the image to the projector's screen size as you scale the image

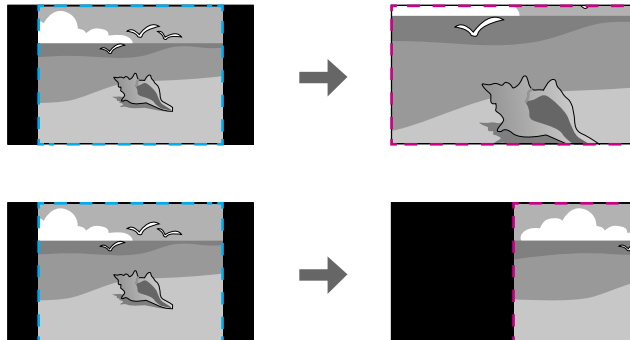

6. Press the **Menu** button to exit.

Parent topic: [Initial Setup for Projectors](#)

Projection Area Adjustments for Edge Blending

You can adjust the area of the projected screens to fine-tune the unified image.

For best results, see the following sections to adjust the Color Uniformity for each projector, use Point Correction to adjust the outlines of the unified image, set up Edge Blending, and then use Point Correction again to adjust the blended area of the image.

[Adjusting Color Uniformity](#)

[Correcting Image Shape with Point Correction](#)

[Blending the Image Edges](#)

Adjusting Color Uniformity

If the color tone is uneven on each screen, adjust the color tone balance in the Multi-Projection or Management menu of each projector. (The color tone may not be uniform even after performing color uniformity.)

Note: Set the **Color Mode** setting in each projector's Image menu to **Multi-Projection** before you start projecting.

1. Press the **Menu** button on the remote or control panel, select the **Multi-Projection** or **Management** menu, and press **Enter**.

| | |
|-----------------------|--------------------------------------|
| Frequently Used Items | Multi-Projection |
| Image | Projector ID Off |
| Signal I/O | HDMI Out Setting Off ∨ |
| Installation | Geometry Correction Point Correction |
| Display | Edge Blending |
| Operation | Scale |
| Management | Color Uniformity |
| Network | Light Source Mode Normal |
| Pen/Touch | Color Matching |
| Interactive | RGBCMY |
| | Reset Multi-Projection Settings |
| Multi-Projection | Memory |
| Memory | Save Memory |
| ECO | Load Memory |
| Initial/All Settings | Rename Memory |
| | Erase Memory |
| | Reset Memory |
| | ECO |

2. Select the **Color Uniformity** setting and press **Enter**.

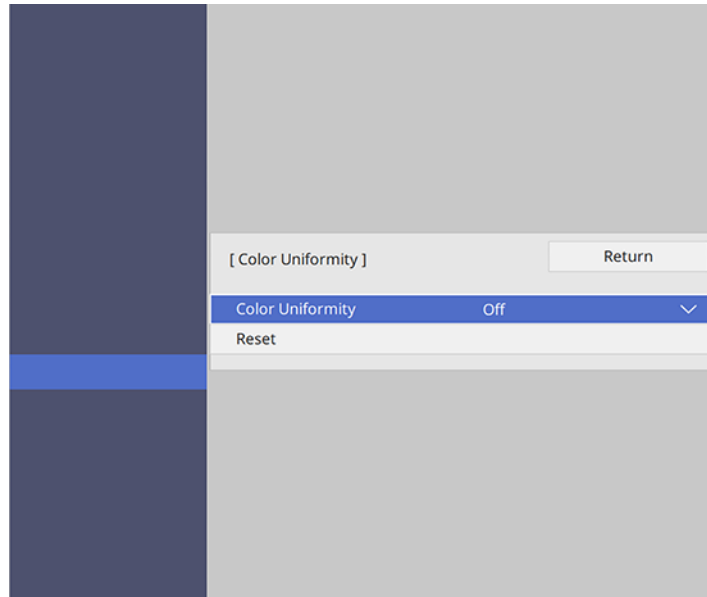

3. Select **On** as the **Color Uniformity** setting and press **Enter**, then press **Esc**.
4. Select **Adjustment Level** and press **Enter**.
5. Press the left or right button to select an adjustment level and press **Esc**.
6. Select **Start Adjustments** and press **Enter**.

7. Select the area you want to adjust and press **Enter**.

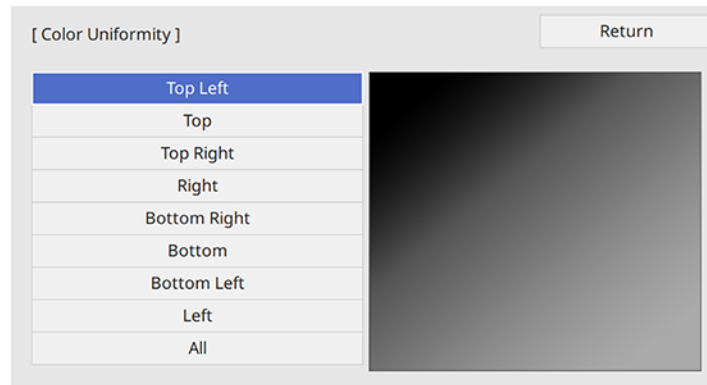

8. Select **Red**, **Green**, or **Blue** and press the left arrow button to weaken the color tone or the right arrow button to strengthen the color tone.

Note: The adjustment screen changes each time you press **Enter**.

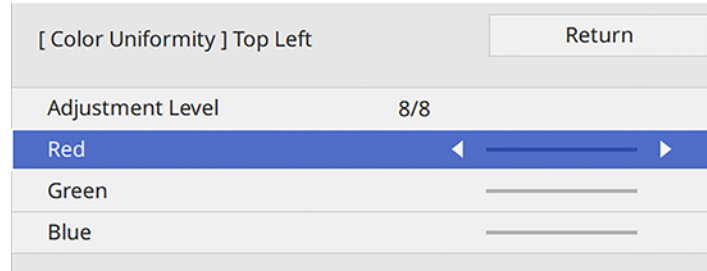

9. Press **Esc** to return to the area selection screen.
10. Repeat steps 7 through 9 for each area, then select **All** to adjust the entire screen.
11. Press **Esc** to exit the menus.

Parent topic: [Projection Area Adjustments for Edge Blending](#)

Correcting Image Shape with Point Correction

You can use the projector's Point Correction feature to fine-tune the image shape using points on a grid. This is useful for adjusting overlapping areas in multiple projected images that do not line up correctly.

Follow these steps on each projector. You will need to make two adjustments: one for the outer shape of the images and another for the blended area. You can select Quick Corner from within the Point Correction menu to roughly adjust the shape and size of the image before you fine-tune the image using Point Correction.

Note: Make sure you have adjusted the Color Uniformity on all projectors before correcting the image shapes with Point Correction.

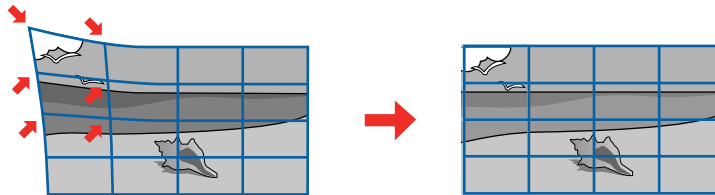

1. Turn on the projector and display an image.
2. Press the **Menu** button.
3. Select **Installation > Geometry Correction > Point Correction**.

Note: If you see a confirmation message, select **Yes** and press **↵ Enter**.

4. Select **Quick Corner** to roughly adjust the shape and size of the image if needed.

Note: Make sure you select **Quick Corner** from the Point Correction menu and not the Geometry Correction menu.

If you adjusted the image using Quick Corner, press **Esc** to return to the Point Correction menu.

5. Select **Point Correction** from the Point Correction menu and press **↵ Enter**.
6. Select the **Point Correction** setting again and press **↵ Enter**.
7. Select **3x3** and press **↵ Enter**.

You see a grid on the projected image.

Note: If you need to change the color of the grid lines, press **Esc**, and select the **Pattern Color** setting. We recommend using red and green.

8. Do one of the following:

- If this is the first Point Correction adjustment, correct the outer points on the grid as shown below. Press the arrow buttons on the projector or remote control to move to the first point and then press **↵ Enter**.

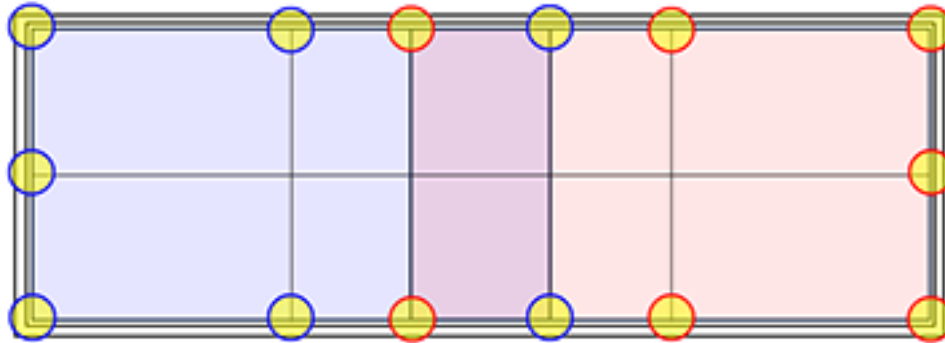

- If this is the second Point Correction adjustment, correct the points in the overlapped section of the images. Press the arrow buttons on the projector or remote control to move to the first point and then press **↵ Enter**.

9. Press the arrow buttons as necessary to correct the image shape. If you are correcting the overlapped section of the images, correct the points until it is perfectly blended.

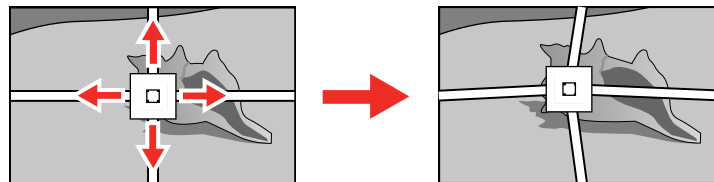

10. Press **Esc** to return to the previous screen and select another point to correct, if necessary.

11. Do one of the following:

- If this is the first Point Correction adjustment, press the **Menu** button when you are finished and click the link below to set up Edge Blending.

- If this is the second Point Correction adjustment, press **Esc** and repeat steps 6 through 8 for the **5x5**, **9x9**, and then **17x17** grids. Press the **Menu** button when you are finished and click the link below to begin color adjustments.

Parent topic: [Projection Area Adjustments for Edge Blending](#)

Related tasks

[Blending the Image Edges](#)

Related topics

[Color Adjustment for Edge Blending](#)

Blending the Image Edges

You can use the projector's Edge Blending feature to create a seamless image from multiple projectors.

Note: Make sure you have adjusted the Color Uniformity and run the first Point Correction adjustment on all projectors before setting up Edge Blending.

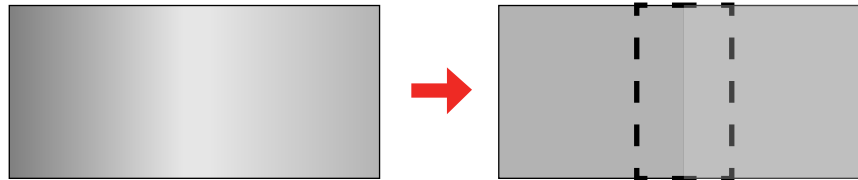

Note: Before performing Edge Blending, set the **Color Mode** setting to **Multi-Projection** to make more precise adjustments.

1. Press the **Menu** button.

2. Select the **Multi-Projection** menu and press **Enter**.

| | |
|-----------------------|--------------------------------------|
| Frequently Used Items | Multi-Projection |
| Image | Projector ID Off |
| Signal I/O | HDMI Out Setting Off |
| Installation | Geometry Correction Point Correction |
| Display | Edge Blending |
| Operation | Scale |
| Management | Color Uniformity |
| Network | Light Source Mode Normal |
| Pen/Touch | Color Matching |
| Interactive | RGBCMY |
| | Reset Multi-Projection Settings |
| Multi-Projection | Memory |
| Memory | Save Memory |
| ECO | Load Memory |
| Initial/All Settings | Rename Memory |
| | Erase Memory |
| | Reset Memory |
| | ECO |

3. Select the **Edge Blending** setting and press **Enter**.
4. Turn on the **Edge Blending**, **Line Guide**, and **Pattern Guide** settings.

Note: Select a different **Guide Color** setting for each projector so that you can see the blended area clearly. We recommend red and green.

5. Select the edge you want to blend on each projector and press **Enter**. For the projector on the left, select the **Right Edge** and for the projector on the right, select **Left Edge**.

You see a screen like this:

| | |
|----------------------|--------|
| [Top Edge] | Return |
| Blending | Off |
| Blend Start Position | 0 |
| Blend Range | 0 |
| Blend Curve | 0 |

6. Select the **Blending** setting and select **On**.
7. Press **Esc** to return to the previous screen.
8. Select the **Blend Start Position** setting and adjust the point where edge blending begins.

Note: If you created a 3:1 unified image area using the Edge Blending feature, set the Blend Start Position setting to **600** (BrightLink 1485Fi).

9. Select the **Blend Range** setting and use the arrow buttons to select the width of the blended area so that the displayed guides are at the edges of the overlapped area between the two images.

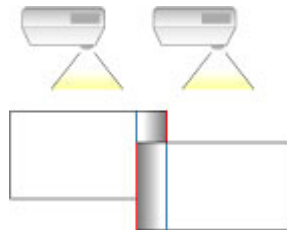

Note: For a non-interactive setup, it is recommended that you set the Blend Range setting to **256** pixels, or blend between 15% and 25% of each projector's screen. Refer to the Edge Blending tab of the online Projector Throw Distance Simulator [here](#).

10. Press **Esc** to go back to the previous screen.
11. Select the **Blend Curve** setting and select a gradient for the shaded area on the projectors.

12. When the edges are blended, turn off the **Line Guide** and **Pattern Guide** settings on each projector to check the final settings.

13. When you are finished, press the **Menu** button.

If the blended area does not overlap exactly, correct the shape of the blended area using **Point Correction**.

Parent topic: [Projection Area Adjustments for Edge Blending](#)

Color Adjustment for Edge Blending

Once the projected area adjustments are complete, adjust the color settings on the projectors to minimize any differences in brightness or color. Use these sections to make color adjustments for each projector.

[Adjusting the Projector's Brightness Level](#)

[Matching the Image Colors](#)

[Adjusting the Black Level](#)

Adjusting the Projector's Brightness Level

Adjust the brightness of the light source for the projectors so that the brightness levels in the unified image match.

1. Turn on the projectors, if necessary, and switch to the image source you want to use.
2. Check the unified image.
3. Do one of the following:
 - If the brightness level is uniform across the unified image, you are done. Proceed to the next topic.
 - If there is a difference in brightness in the unified image, reduce the brightness of any other projectors to match that of the projector with the lowest brightness level. Go to the next step.

Note: To match brightness in the unified image, projector brightness is reduced because the brightness of the projector with the lowest brightness level cannot be increased.

4. Press the **Menu** button.

5. Select the **Operation** menu and press **↵ Enter**.

| | | |
|-----------|---------------------------------|--------------------|
| Operation | Auto Source Search | On |
| Operation | Light Source Brightness Cont... | |
| Operation | Direct Power On | Off |
| Operation | Auto Power On | Off |
| Operation | Sleep Mode | On ^ |
| Operation | Sleep Mode Timer | 10 min. |
| Operation | A/V Mute Timer | On |
| Operation | Standby Mode | Communication On ^ |
| Operation | Port | Wired LAN |
| Operation | Quick Startup | Off |
| Operation | Indicators | On |
| Operation | Inv Direction Button | Off |
| Operation | Reset Operation Settings | |
| Operation | Management | |
| Operation | User Button | Light Source Mode |
| Operation | User's Logo | |
| Operation | User Pattern | |

6. Select **Light Source Brightness Control** and press **↵ Enter**.

| | |
|-------------------------------------|-----------|
| [Light Source Brightness Control] | Return |
| Maintain Brightness | On |
| Maintain Brightness Level | 100 % |
| Estimated Remains | 0H [] |
| Light Source Mode | Normal |
| Brightness Level | 100 % |

7. On any projectors with brighter projected images, set the **Light Source Mode** setting to **Custom**, select **Brightness Level** and use the left and right arrow buttons to adjust the brightness until it is even for all projectors.

8. Press **Menu** or **Esc** to exit the menus.

Note: For the best results in maintaining the brightness level, set the **Light Source Calibration** setting to **Run Periodically** in the projector's Management menu.

Parent topic: [Color Adjustment for Edge Blending](#)

Matching the Image Colors

You can match the display color of multiple projectors that will project next to one another. Turn on all the projectors so you can properly adjust the color of the combined screen.

1. Press the **Menu** button.
2. Select the **Multi-Projection** menu and press **↵ Enter**.

| | |
|-----------------------|--------------------------------------|
| Frequently Used Items | Multi-Projection |
| Image | Projector ID Off |
| Signal I/O | HDMI Out Setting Off ▼ |
| Installation | Geometry Correction Point Correction |
| Display | Edge Blending |
| Operation | Scale |
| Management | Color Uniformity |
| Network | Light Source Mode Normal |
| Pen/Touch | Color Matching |
| Interactive | RGBCMY |
| | Reset Multi-Projection Settings |
| Multi-Projection | Memory |
| Memory | Save Memory |
| ECO | Load Memory |
| Initial/All Settings | Rename Memory |
| | Erase Memory |
| | Reset Memory |
| | ECO |

3. Select the **Color Matching** setting and press **↵ Enter**.

You see this screen:

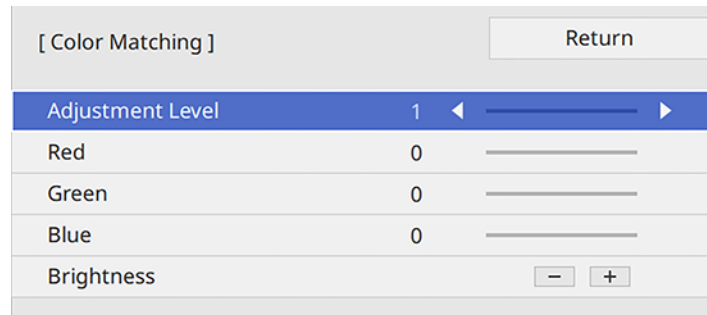

4. Press the left or right arrow button to select **Adjustment Level 8**.

Note: There are several adjustment levels and you can adjust each level individually.

5. Press the left or right arrow buttons to adjust the **Brightness** setting.
6. Press the left or right arrow buttons to adjust the color tone for the **Red**, **Green**, and **Blue** settings if necessary.
7. Press **Esc** to return to the Multi-Projection menu.
8. Select the **Operation** menu and press **↵ Enter**.
9. Select **Light Source Brightness Control** and press **↵ Enter**.
10. Set the **Light Source Mode** setting to **Custom** and adjust the **Brightness Level** setting as necessary.
11. Press **Esc** and repeat steps 2 through 6 for **Adjustment Level 7** through **2**.
12. When you are finished, press the **Menu** button.

Parent topic: [Color Adjustment for Edge Blending](#)

Adjusting the Black Level

When two images overlap, the overlapping area can appear differently from the areas that do not overlap. You can use the projector's Black Level setting to make the difference less noticeable.

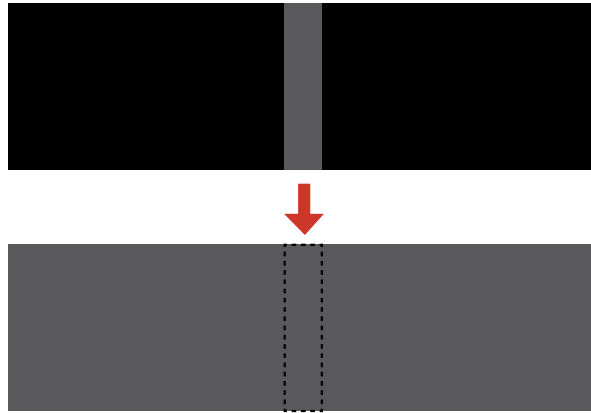

Note: You cannot adjust the black levels while projecting a test pattern, and you may not be able to adjust the black levels correctly if the **Geometry Correction** settings are set too high. The brightness and tone of the overlapping areas may differ from the rest of the image even after adjusting the black level.

1. Press the **Menu** button.

2. Select the **Multi-Projection** menu and press **↵ Enter**.

| | |
|-----------------------|--------------------------------------|
| Frequently Used Items | Multi-Projection |
| Image | Projector ID Off |
| Signal I/O | HDMI Out Setting Off ▼ |
| Installation | Geometry Correction Point Correction |
| Display | Edge Blending |
| Operation | Scale |
| Management | Color Uniformity |
| Network | Light Source Mode Normal |
| Pen/Touch | Color Matching |
| Interactive | RGBCMY |
| | Reset Multi-Projection Settings |
| Multi-Projection | Memory |
| Memory | Save Memory |
| ECO | Load Memory |
| Initial/All Settings | Rename Memory |
| | Erase Memory |
| | Reset Memory |
| | ECO |

3. Select the **Black Level** setting and press **↵ Enter**.

Note: The **Black Level** setting is displayed only if **Edge Blending** is enabled and at least one (top, bottom, left, right) edge is set to **On**.

4. Select the **Color Adjustment** setting and press **↵ Enter**.

You see a screen based on the **Top Edge**, **Bottom Edge**, **Right Edge**, and **Left Edge** settings you selected for the **Edge Blending** setting.

5. Select the area you want to adjust and press **↵ Enter**.

Note: The area you selected is displayed in orange. Adjust overlapping areas starting with the brightest areas first. For example, adjust area 2 to match area 1, then adjust area 3 to match area 2.

- Adjust the brightness and tone of the areas that do not overlap to match the areas that overlap using the displayed adjustment sliders. Then press the **Esc** button.

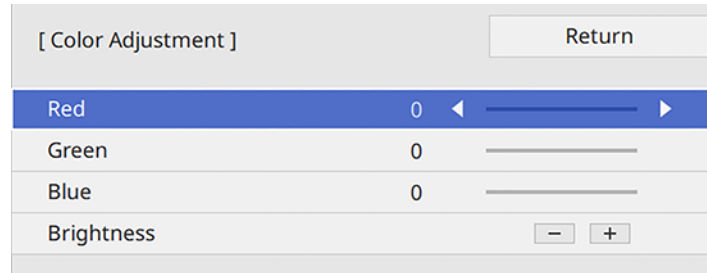

- Repeat the previous two steps as needed until all areas match.
- If the tone of some areas do not match, you can adjust them using the **Area Correction** setting. Continue with the next step. Otherwise, press the **Menu** button to exit.
- Press the **Esc** button to return to the Black Level screen.
- Select the **Area Correction** setting and press **↵ Enter**.
- Select the **Start Adjustments** setting and press **↵ Enter**.

You see a screen with boundary lines indicating areas that are overlapping. The boundary lines are based on the **Top Edge**, **Bottom Edge**, **Right Edge**, and **Left Edge** settings you selected for the **Edge Blending** setting.

- Use the arrow buttons to select a boundary line of the area you want to adjust and press **↵ Enter**. The selected line is displayed in orange.



- Use the arrow buttons to adjust the boundary line position and press **↵ Enter**.

14. Use the arrow buttons to select an adjustment point and press **↵ Enter**.

Note: You can change the number of adjustment points displayed by changing the **Points** setting in the Area Correction menu.

The selected point turns orange.

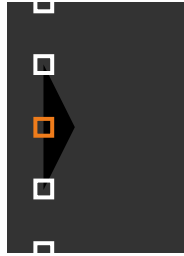

15. Use the arrow buttons to move the point.

16. To move another point, press the **Esc** button and repeat the previous two steps.

17. To move another boundary line, press the **Esc** button repeatedly until you can select a boundary line.

18. When you are finished, press the **Esc** button until you see a confirmation message. Select **Yes** and press **↵ Enter**.

19. Repeat steps 4 through 7 to adjust the **Color Adjustment** settings, if necessary.

20. When you are finished, press the **Menu** button.

Note: Changing the **Top Edge**, **Bottom Edge**, **Right Edge**, or **Left Edge** settings resets the **Black Level** setting to its default value.

Parent topic: [Color Adjustment for Edge Blending](#)

Completing the Edge Blending Set-up

Once you complete the projected area and color adjustments, make some final adjustments on the projectors and your computer to complete Edge Blending set-up.

Attention: If you are completing the Edge Blending set-up for use with interactive features (BrightLink 1485Fi), you must perform auto calibration, then Touch Unit calibration again on both projectors before configuring the display settings on your computer. See the links below.

[Calibrating for Finger Touch Interactivity \(BrightLink 1485Fi\)](#)
[Configuring the Display Settings](#)

Related tasks

[Calibrating Automatically \(BrightLink 1485Fi\)](#)

Calibrating for Finger Touch Interactivity (BrightLink 1485Fi)

Finger touch calibration coordinates the positioning of your finger with the location of the cursor.

Note: Make sure you have calibrated the pens, installed the Touch Unit, performed Touch Unit setup, and turned the Touch Unit on before calibrating for finger touch interactivity. See your product's online *Installation Guide* for Touch Unit installation information.

Note: If you are setting up multiple projectors for DuoLink, before performing Touch Unit calibration, disable Edge Blending in the projector's menus, and on the projector that isn't currently being calibrated, disable the Touch Unit and then enable A/V mute.

1. Press the **Menu** button, select the **Installation** menu, and press **↵ Enter**.

| | |
|-----------------------|--------------------------------------|
| Frequently Used Items | Installation |
| Image | Fixed Installation Off |
| Signal I/O | Test Pattern |
| Installation | Setting Plate Installation Guide |
| Display | Vertical Installation No |
| Operation | Projection Front/Upside Down |
| Management | Auto Screen Adjustment |
| Network | Geometry Correction Point Correction |
| Pen/Touch | Digital Zoom |
| Interactive | Connect ELPCB02 Off |
| Multi-Projection | Touch Unit |
| Memory | Remote Receiver Off |
| ECO | Screen Type 16:9 |
| Initial/All Settings | High Altitude Mode Off |
| | Reset Installation Settings |
| | Display |
| | Pattern Display |
| | Pattern Type |

2. Select **Touch Unit** and press **↵ Enter**.

| | |
|----------------------|--------|
| [Touch Unit] | Return |
| Installation Pattern | |
| Power | On |
| Touch Unit Setup | |
| Touch Calibration | |
| Calibration Range | Wide |

3. Select **Touch Calibration** and press **↵ Enter**.

The following screen appears:

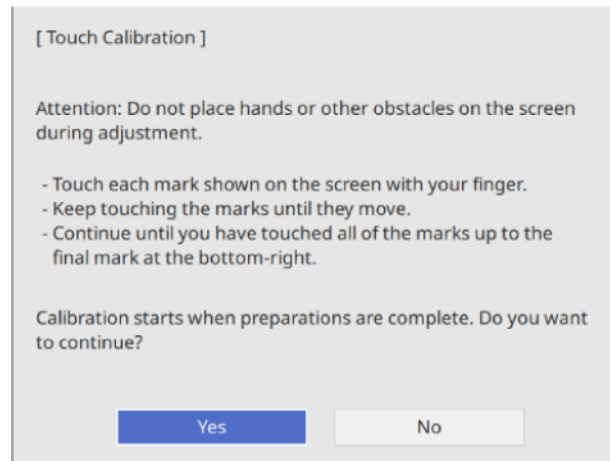

Note: If **Touch Calibration** is disabled, make sure **Power** is set to **On**.

4. Adjust the image focus, if necessary.
5. Press **↵ Enter** to select **Yes**.
A green circle appears in the upper left corner of your projected image.
6. Touch and hold the center of the circle with your finger until the circle disappears and another circle appears, then release it.

The circle disappears, and you see another circle below the first one.

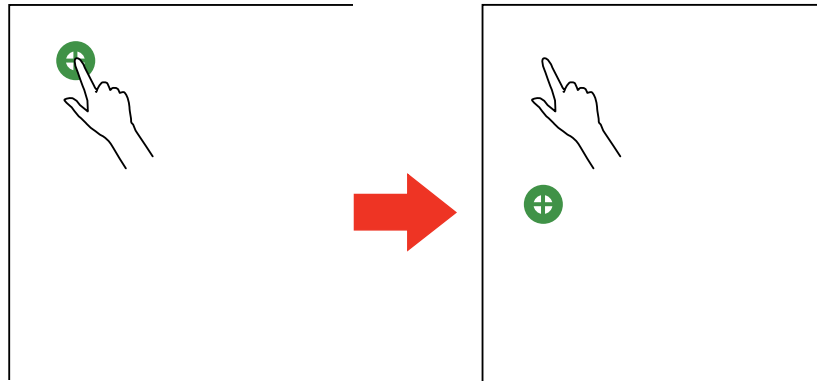

Note: For the most accurate calibration, make sure you touch the center of the circle with the tip of your finger.



Note: Make sure you are not blocking the signal between your finger and the interactive receiver (next to the projector lens).

7. Touch the center of the next circle with your finger and continue until all of the circles disappear.

When you get to the bottom of a column, the next circle appears at the top of a new column.

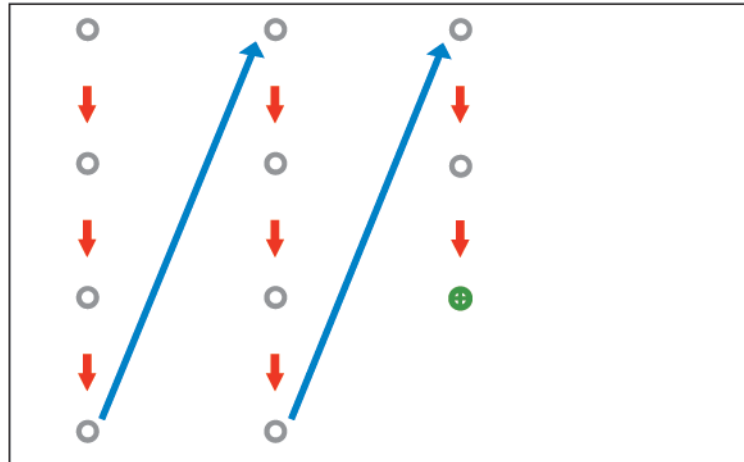

Note: If you make a mistake, press the **Esc** button on the remote control or control panel to go back to the previous circle. It may take several seconds after all of the dots have disappeared for touch calibration to be completed. To cancel the calibration process, press and hold the **Esc** button for 2 seconds.

8. If the cursor location and your finger position do not match, repeat these steps to calibrate again.

Parent topic: [Completing the Edge Blending Set-up](#)

Configuring the Display Settings

If you are completing the Edge Blending set-up, you must configure the display settings on the computer to project your desktop.

Note: This is a general description of the tasks involved in configuring your computer display. See your computer or operating system manual for details. Some video cards may not support certain display configurations.

1. Set your computer's video settings to extend the desktop.

The projectors should be recognized as one projector with a resolution of 3240x1080 for BrightLink 1485Fi models or 1920x1080 for PowerLite EB-800F/EB-805F models.

2. Make sure the output resolution of the computer is set to match the **EDID** settings of the projectors.
3. Position the projector display so that the computer display is the farthest to the right.
4. Select the projector as the primary display and make sure your desktop is extended onto the second display.

Note: If your computer desktop isn't projected correctly, check the **EDID** setting on the projectors.

5. For Mac, make sure the **System Preferences > Mission Control > Displays have separate Spaces** setting is disabled.

Parent topic: [Completing the Edge Blending Set-up](#)

Copyright Notice

All rights reserved. No part of this publication may be reproduced, stored in a retrieval system, or transmitted in any form or by any means, electronic, mechanical, photocopying, recording, or otherwise, without the prior written permission of Seiko Epson Corporation. The information contained herein is designed only for use with this Epson product. Epson is not responsible for any use of this information as applied to other products.

Neither Seiko Epson Corporation nor its affiliates shall be liable to the purchaser of this product or third parties for damages, losses, costs, or expenses incurred by purchaser or third parties as a result of: accident, misuse, or abuse of this product or unauthorized modifications, repairs, or alterations to this product, or (excluding the U.S.) failure to strictly comply with Seiko Epson Corporation's operating and maintenance instructions.

Seiko Epson Corporation shall not be liable for any damages or problems arising from the use of any options or any consumable products other than those designated as Original Epson Products or Epson Approved Products by Seiko Epson Corporation.

This information is subject to change without notice.

[A Note Concerning Responsible Use of Copyrighted Materials](#)

[Trademarks](#)

[Copyright Attribution](#)

A Note Concerning Responsible Use of Copyrighted Materials

Epson encourages each user to be responsible and respectful of the copyright laws when using any Epson product. While some countries' laws permit limited copying or reuse of copyrighted material in certain circumstances, those circumstances may not be as broad as some people assume. Contact your legal advisor for any questions regarding copyright law.

Parent topic: [Copyright Notice](#)

Trademarks

EPSON® and PowerLite® are registered trademarks and EPSON Exceed Your Vision is a registered logomark of Seiko Epson Corporation.

Windows is a registered trademark of Microsoft Corporation in the United States and/or other countries.

Mac, macOS, and OS X are trademarks of Apple Inc., registered in the U.S. and other countries.

HDBaseT™ and the HDBaseT Alliance logo are trademarks of the HDBaseT Alliance.

General Notice: Other product names used herein are for identification purposes only and may be trademarks of their respective owners. Epson disclaims any and all rights in those marks.



Parent topic: [Copyright Notice](#)

Copyright Attribution

© 2022 Epson America, Inc.

3/22

CPD-61306

Parent topic: [Copyright Notice](#)