

NORRE

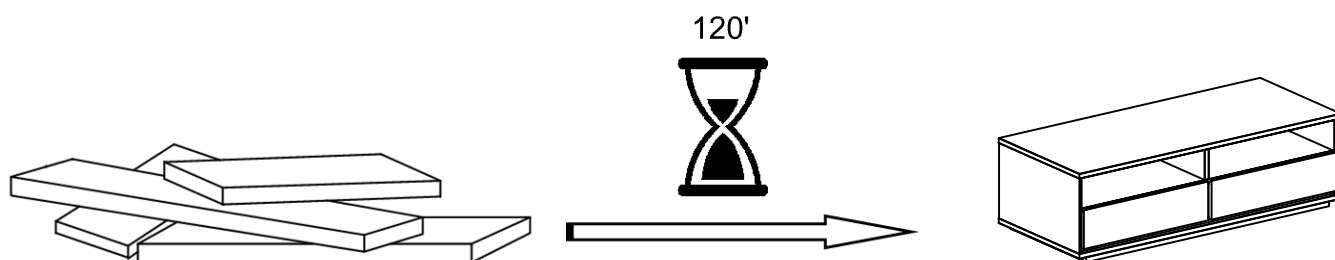

⚠ ENGLISH

- Do not dispose of any packaging or contents of the shipping carton until assembly is completed to avoid accidentally discarding small parts or hardware.

⚠ FRANÇAIS

- Ne jetez rien des produits d'emballage et du contenu de la boîte jusqu'à ce que l'assemblage soit terminé, afin d'éviter de jeter par mégarde de petites pièces ou des morceaux.

⚠ ESPAÑOL

- Para evitar desechar accidentalmente las partes pequeñas o las piezas de ferretería, no tirar el embalaje o contenido de la caja hasta que el ensamblaje esté completo.

Care Instructions:

- Dust often using a clean, soft, dry and lint-free cloth.
- Blot spills and wipe with a clean, damp cloth immediately.
- We do not recommend the use of chemical cleansers, abrasives or furniture polish on our lacquered finish.
- Hardware may loosen over time. Periodically check to make sure all connections are tight. Re-tighten if necessary.

Instructions d'entretien :

- Épousseter régulièrement avec un chiffon propre, doux et non pelucheux.
- Éponger immédiatement les liquides renversés et essuyer à l'aide d'un chiffon propre et humide.
- L'utilisation de produits nettoyants chimiques, d'abrasifs ou d'encastiques sur nos finitions laquées n'est pas recommandée.
- Le matériel de fixation peut se desserrer avec le temps. Vérifiez régulièrement afin de vous assurer que tous les raccords sont bien serrés. Resserrez-les au besoin.

Instrucciones de cuidado:

- Limpiar el polvo con un trapo limpio, suave, seco y libre de pelusas.
- Secar los derrames de inmediato y limpiar con un trapo limpio y húmedo.
- Recomendamos no usar limpiadores químicos, abrasivos o lustramuebles sobre el acabado barnizado.
- Las piezas de ferretería pueden aflojarse con el tiempo. Controlar periódicamente que estén bien ajustadas. Si es necesario, volver a ajustarlas.

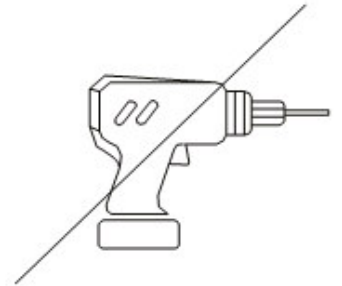
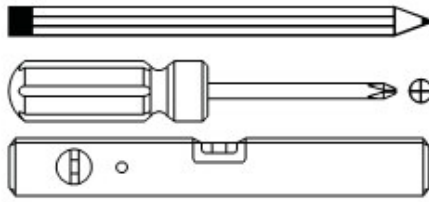
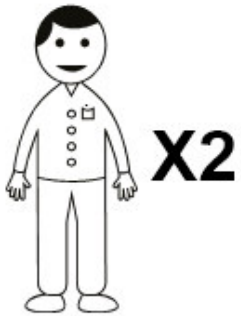

NOT INCLUDED / NON INCLUS / NO INCLUIDAS

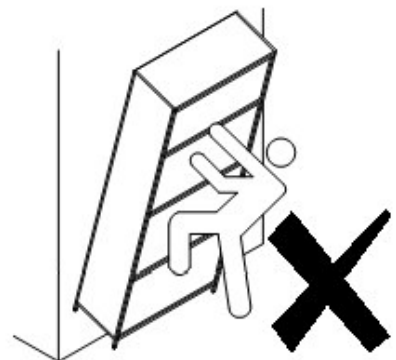
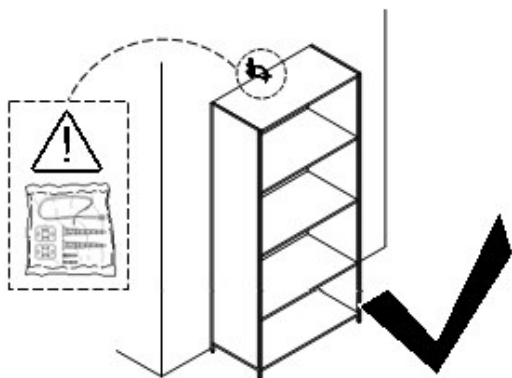
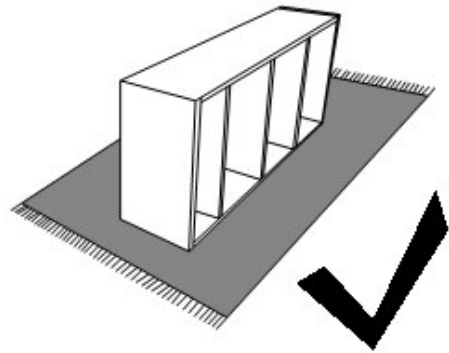
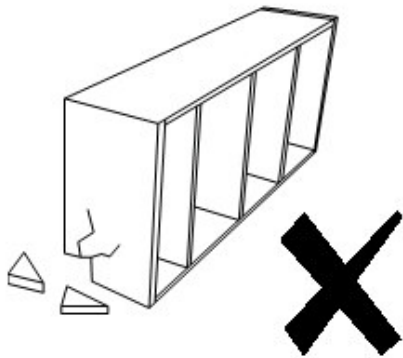
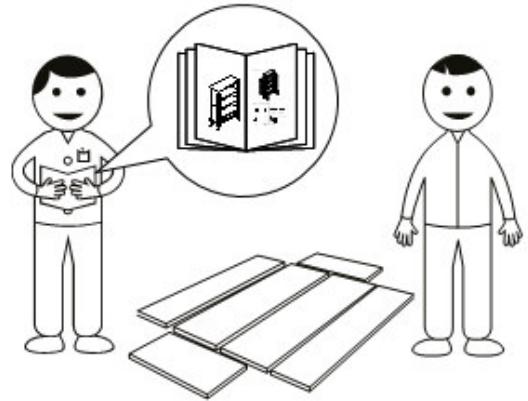

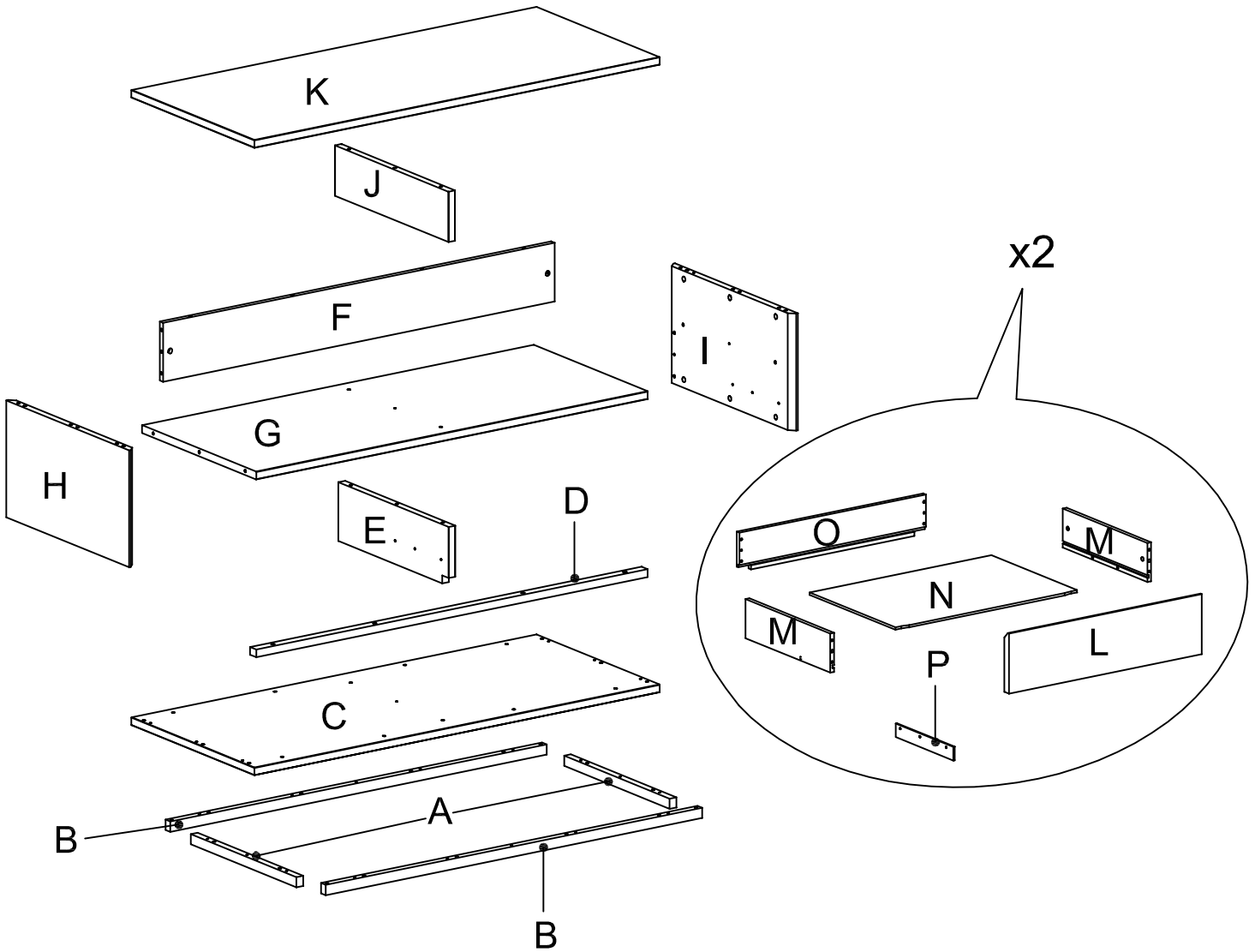

YDN	BWC	ADM	AV	Ai	BZG	ZF5	ZF1
Ø ¼" x 1 ¾"	Ø ¼" x 1 ¼"	Ø 5/16" x 1 3/16"	Ø ¼" x 1 3/16"	Ø 9/16" x 7/16"	Ø ½" x ½"	Ø ¼" x 7/8"	Ø ¼" x 3/8"
20x	28x	66x	16x	20x	8x	6x	6x
ZUL	ZUM	AQO	ZYY	HV			
2x	2x	4x	1x				

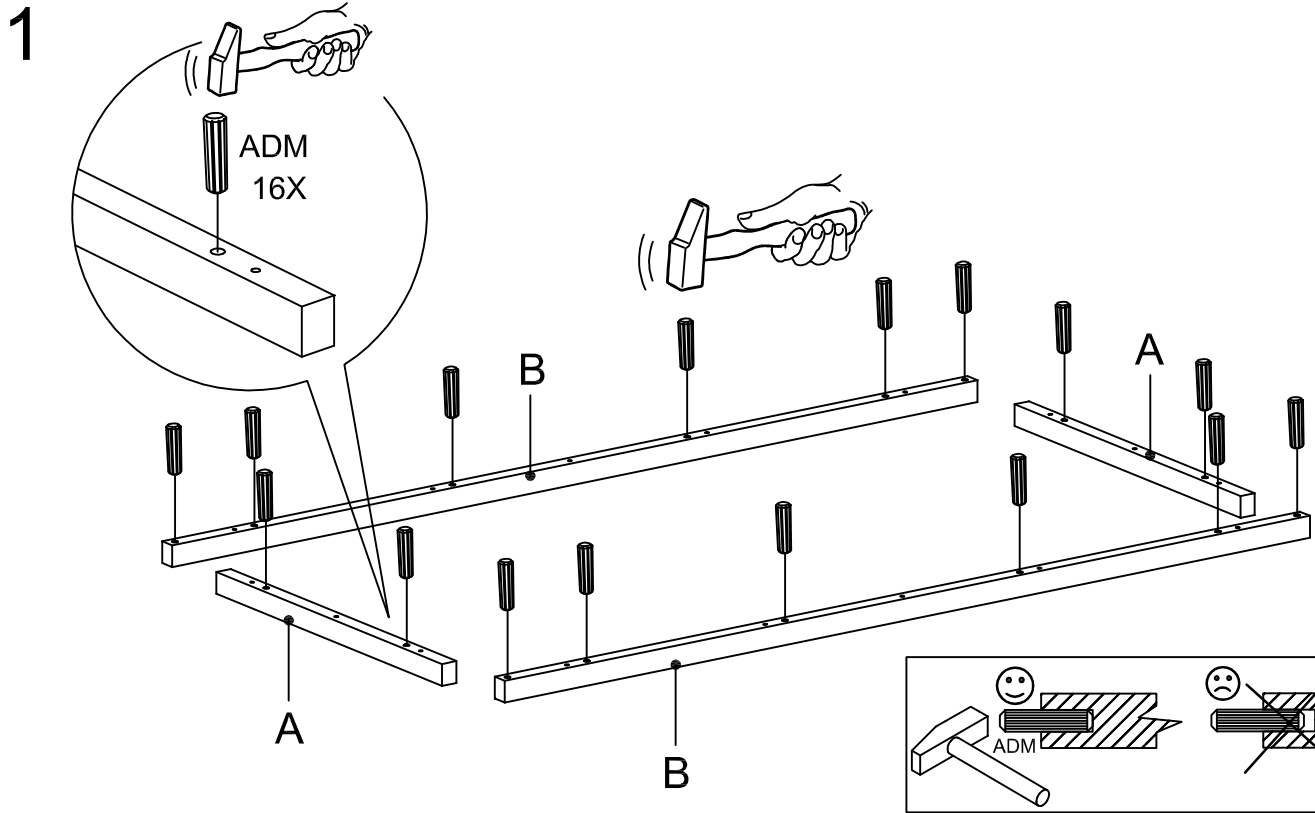

2

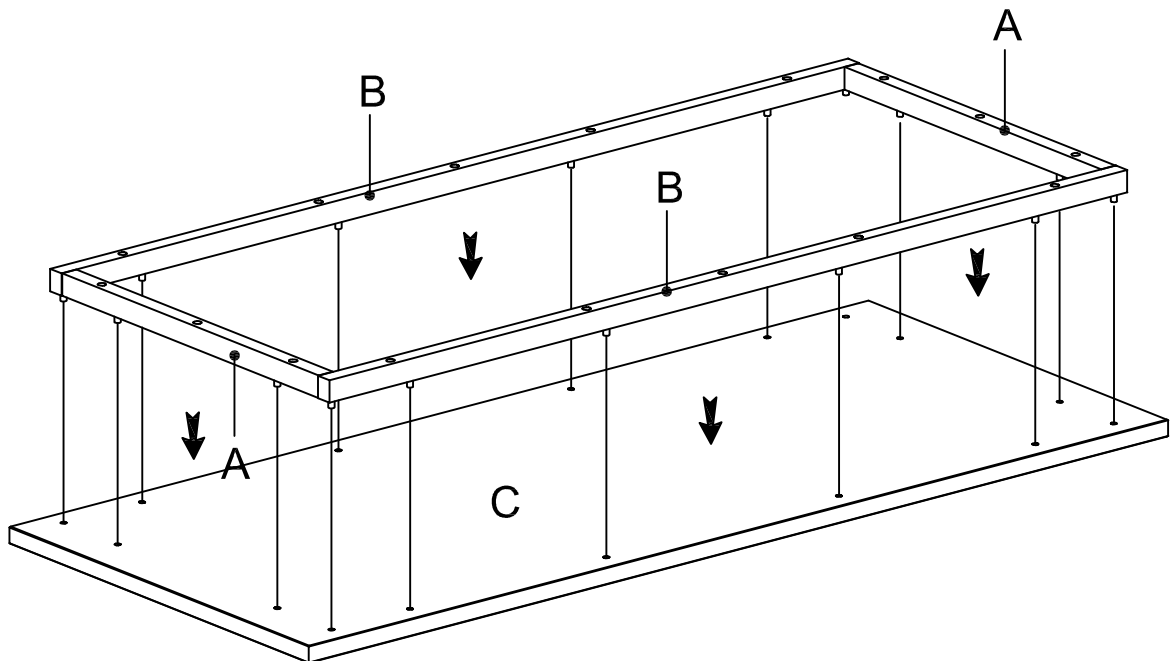

3

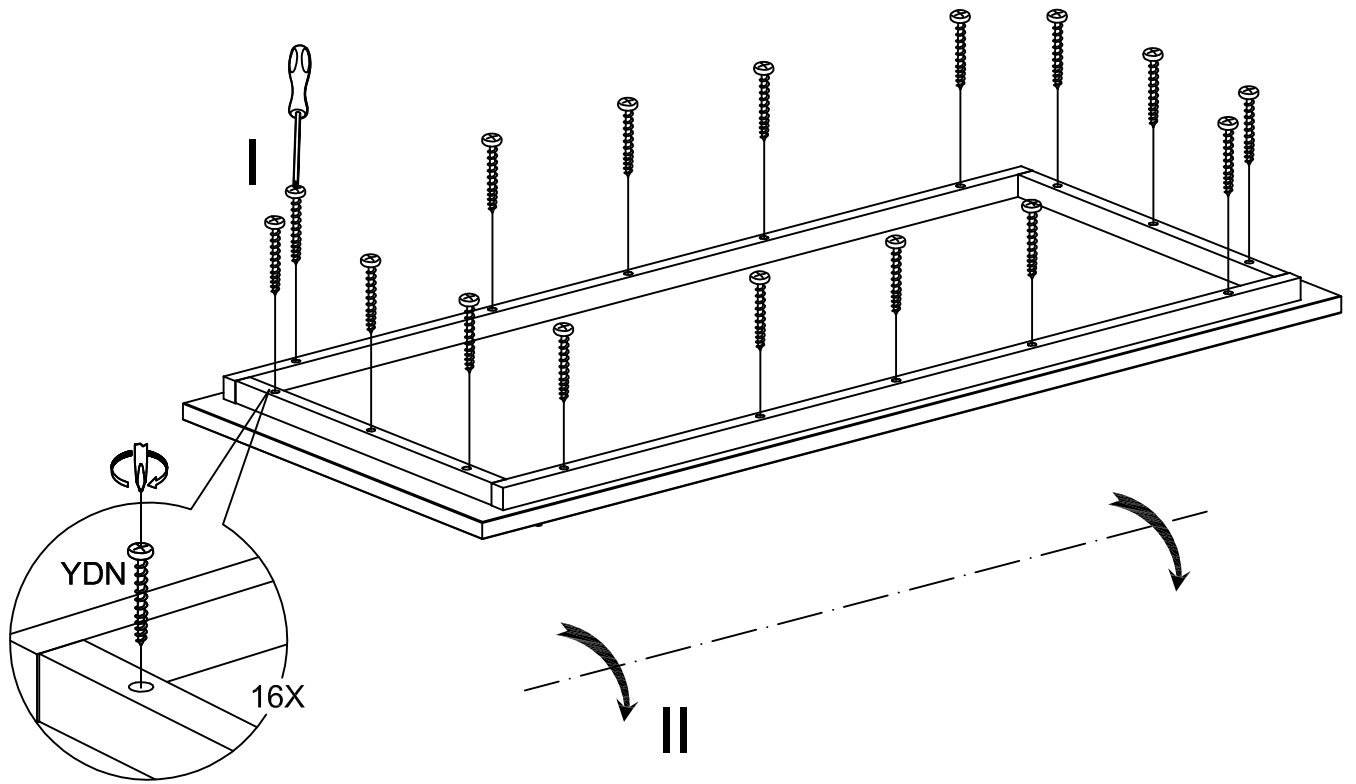

4

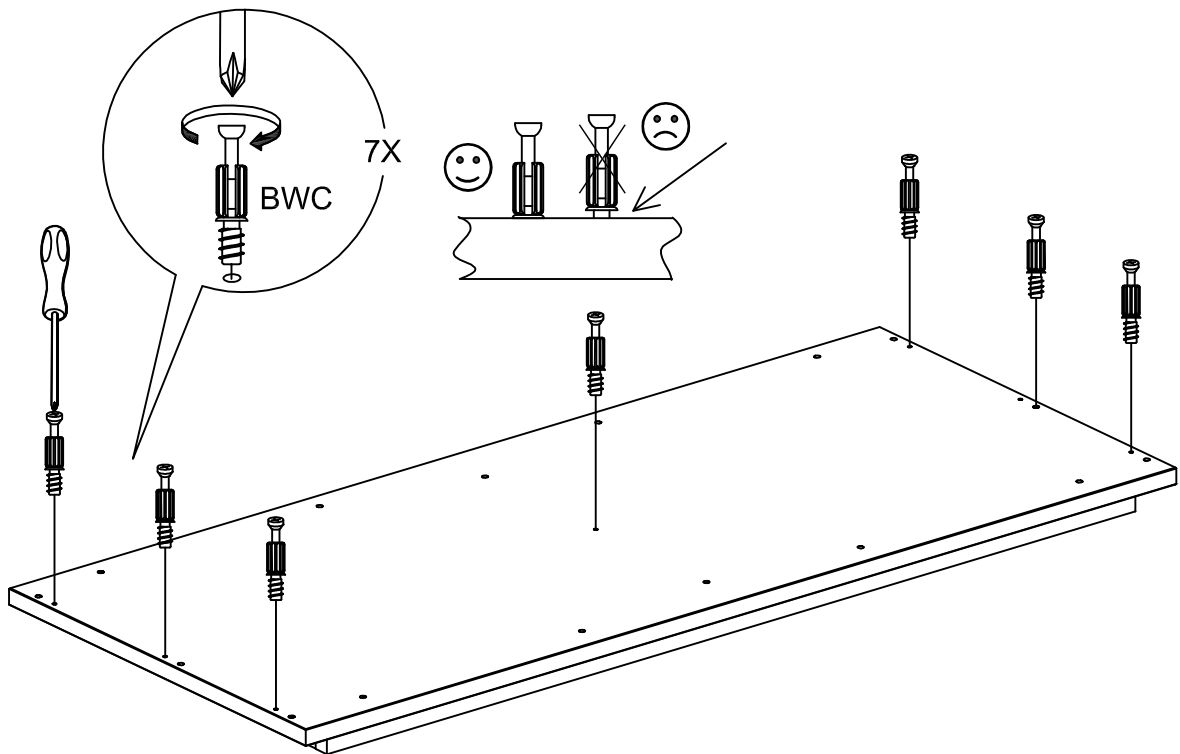

5

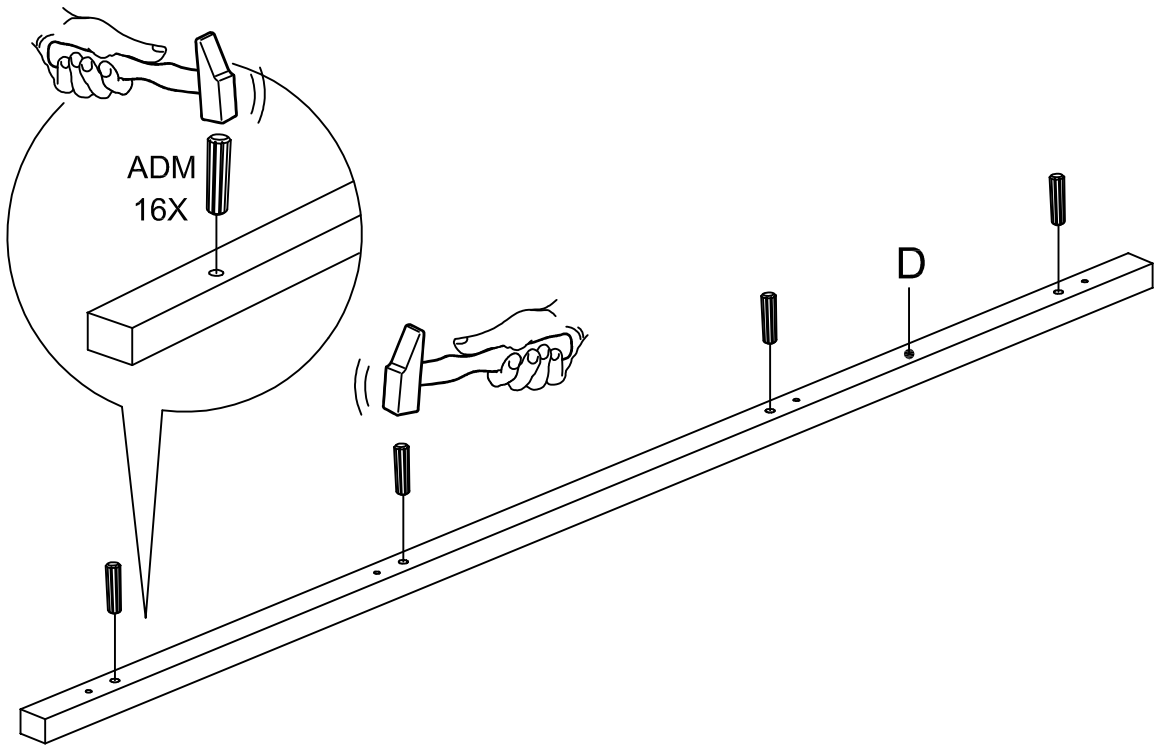

6

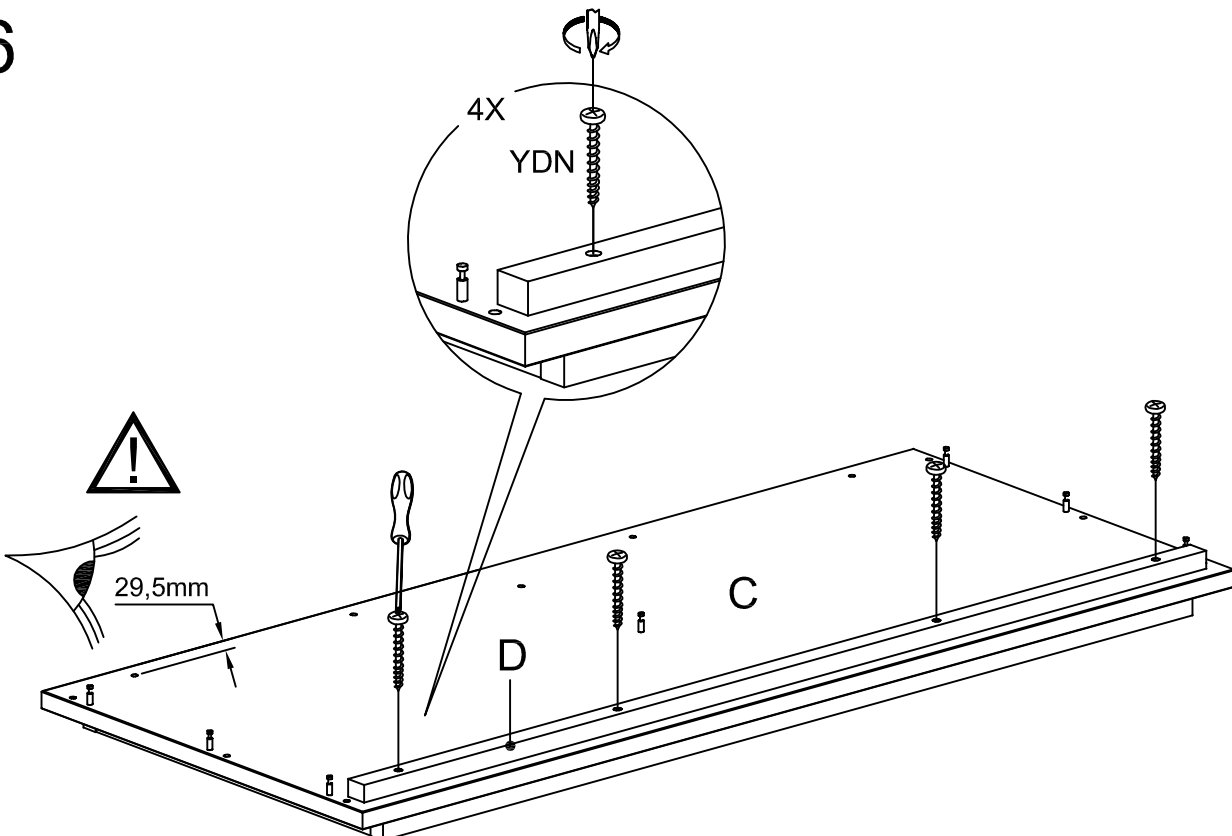

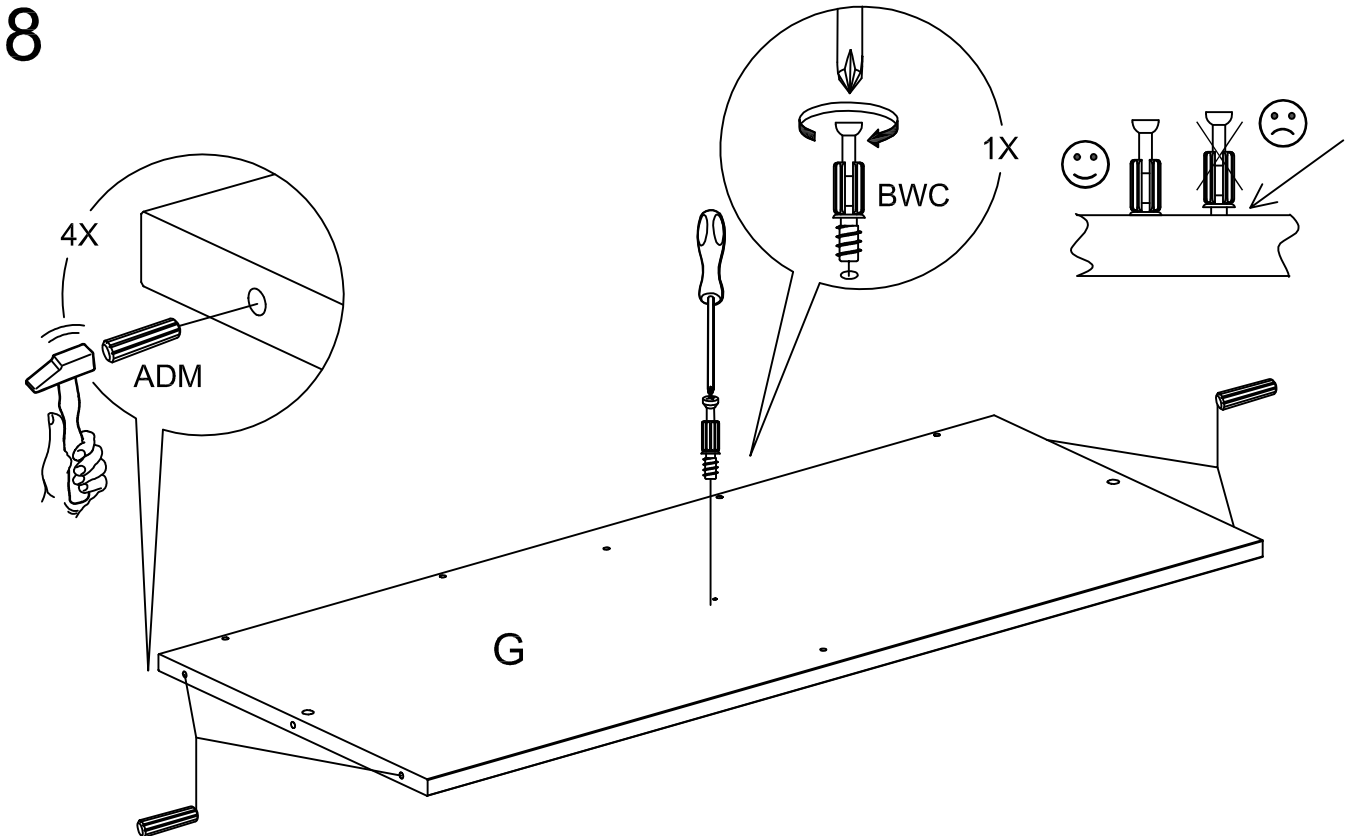
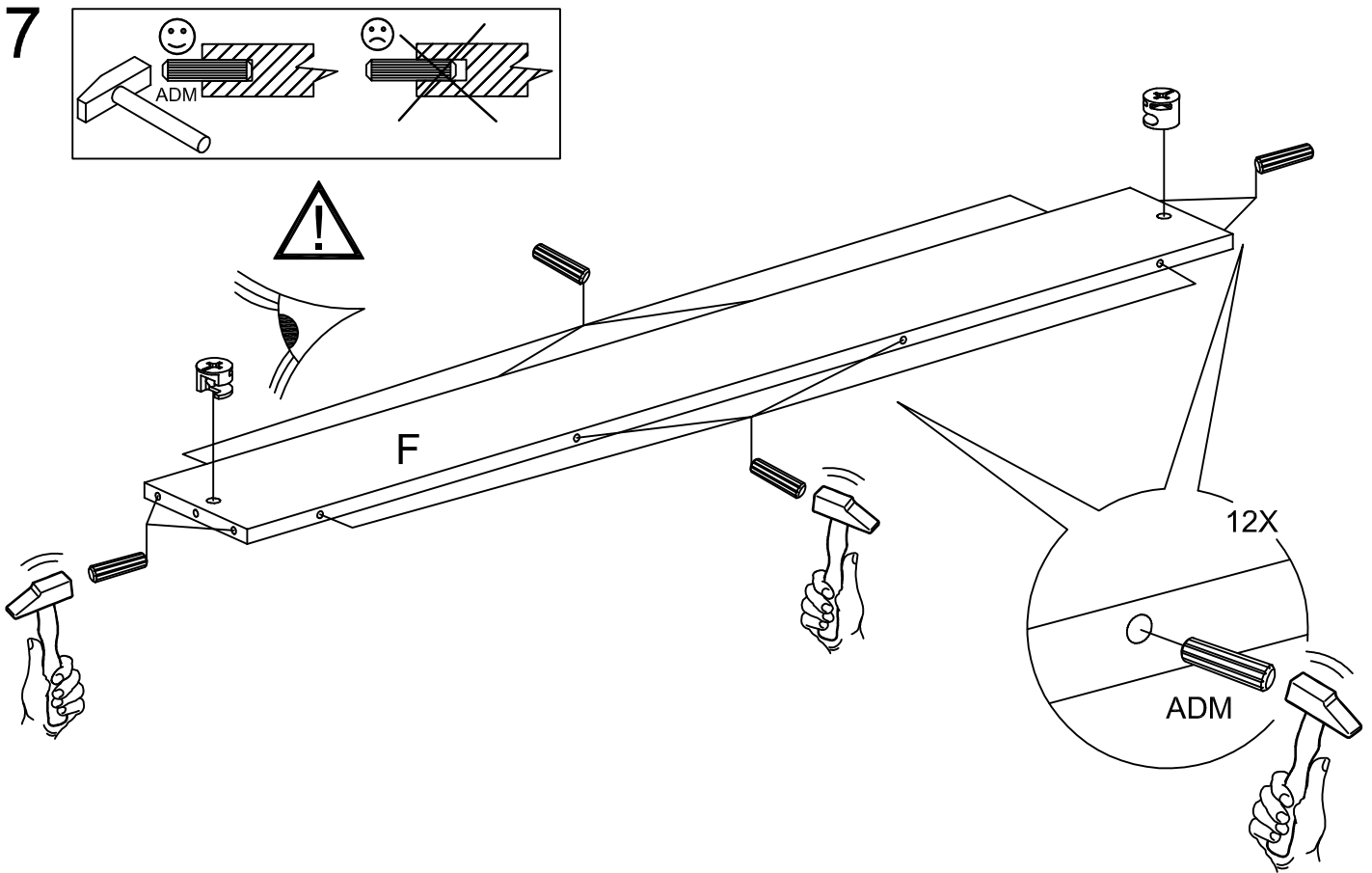

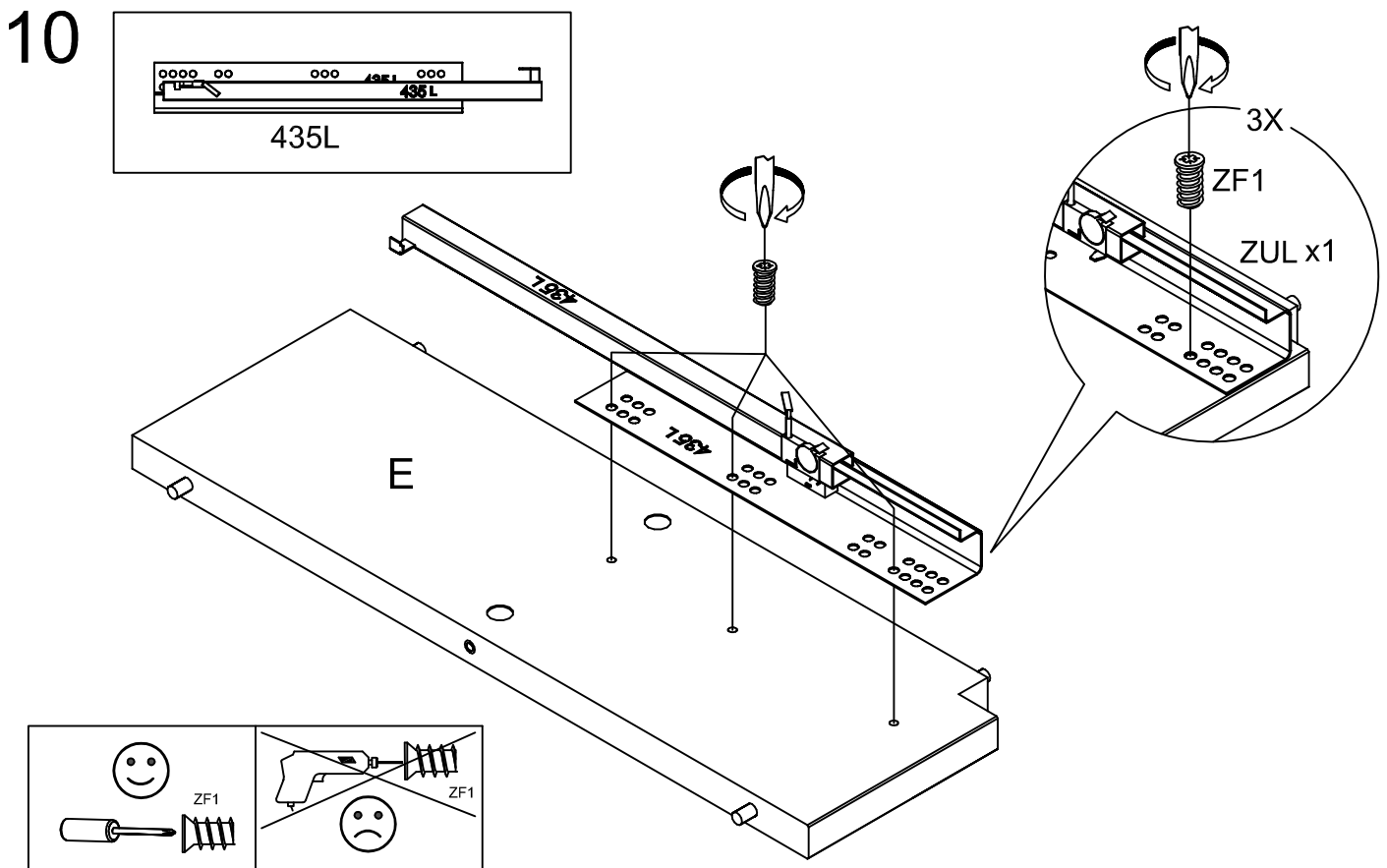
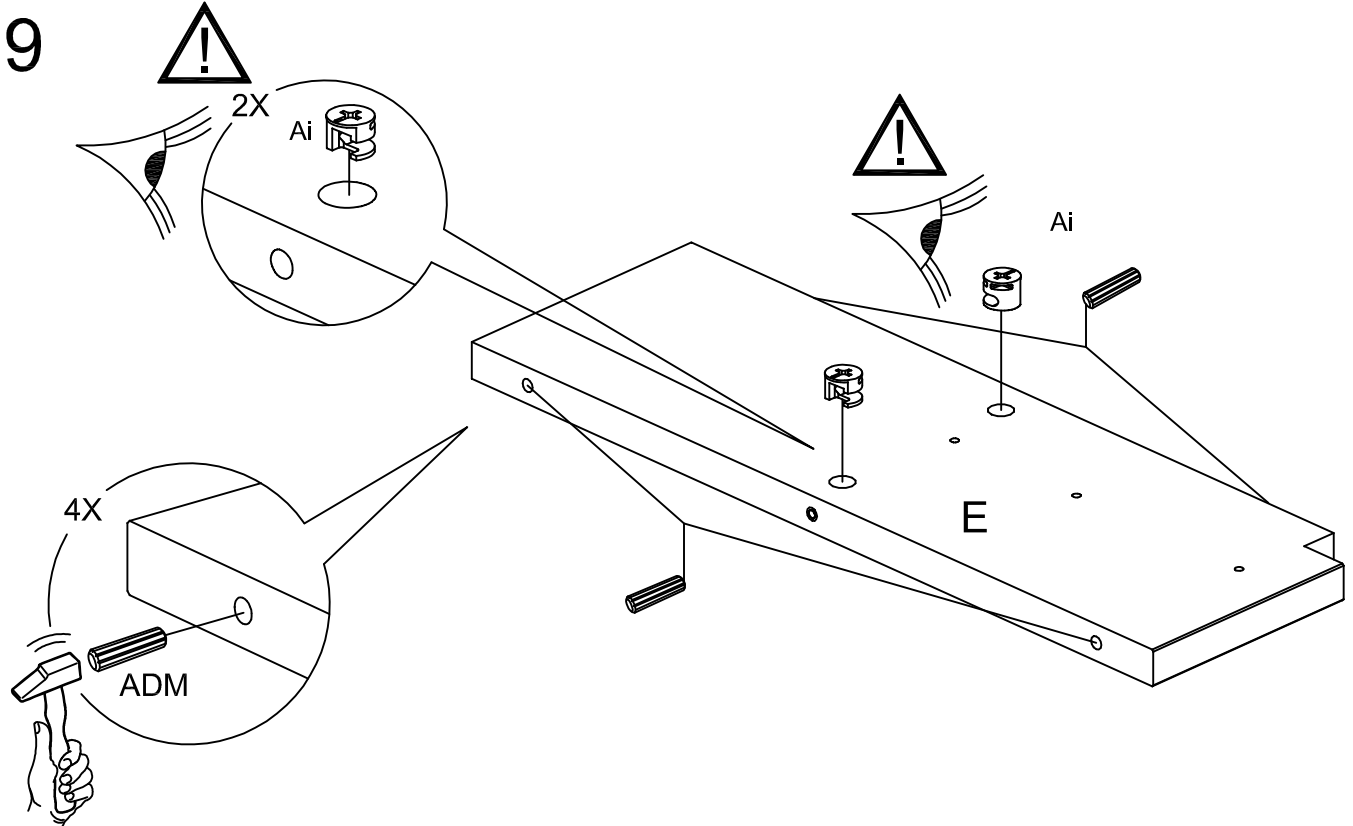

11

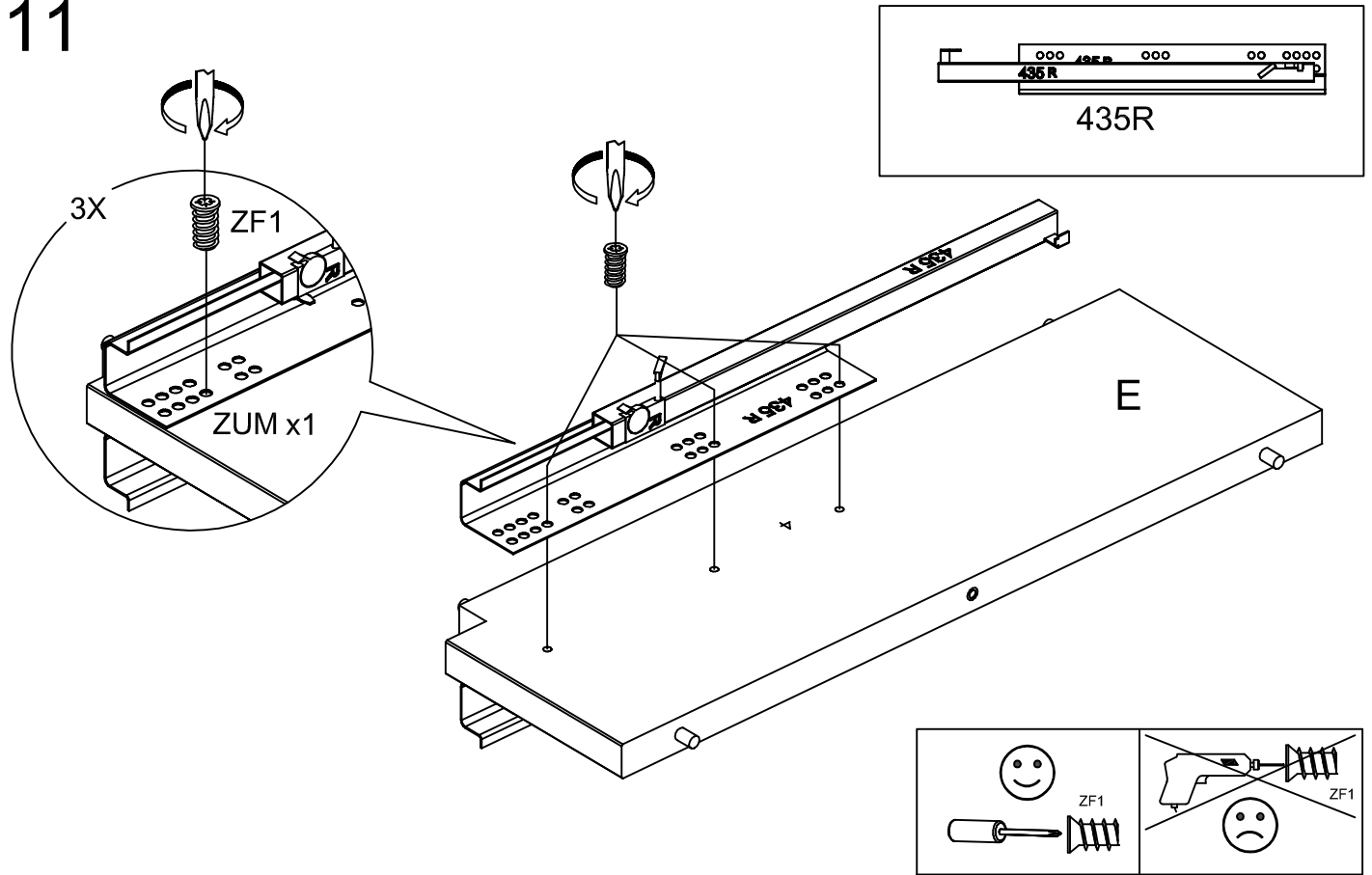

12

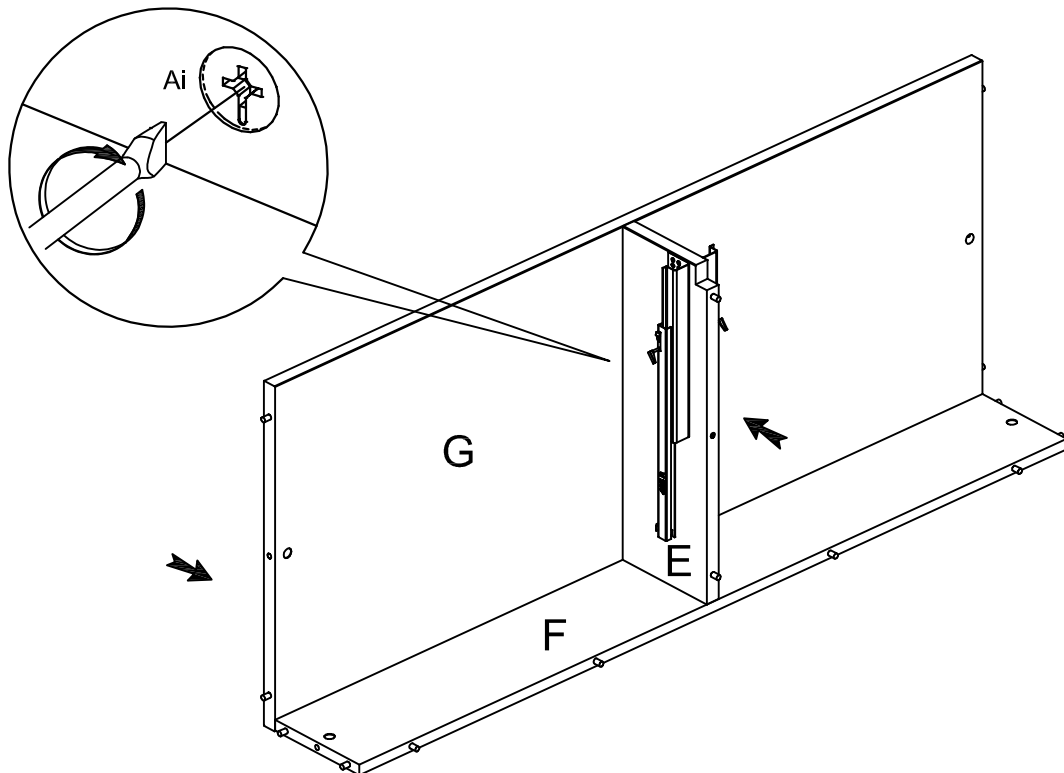

13

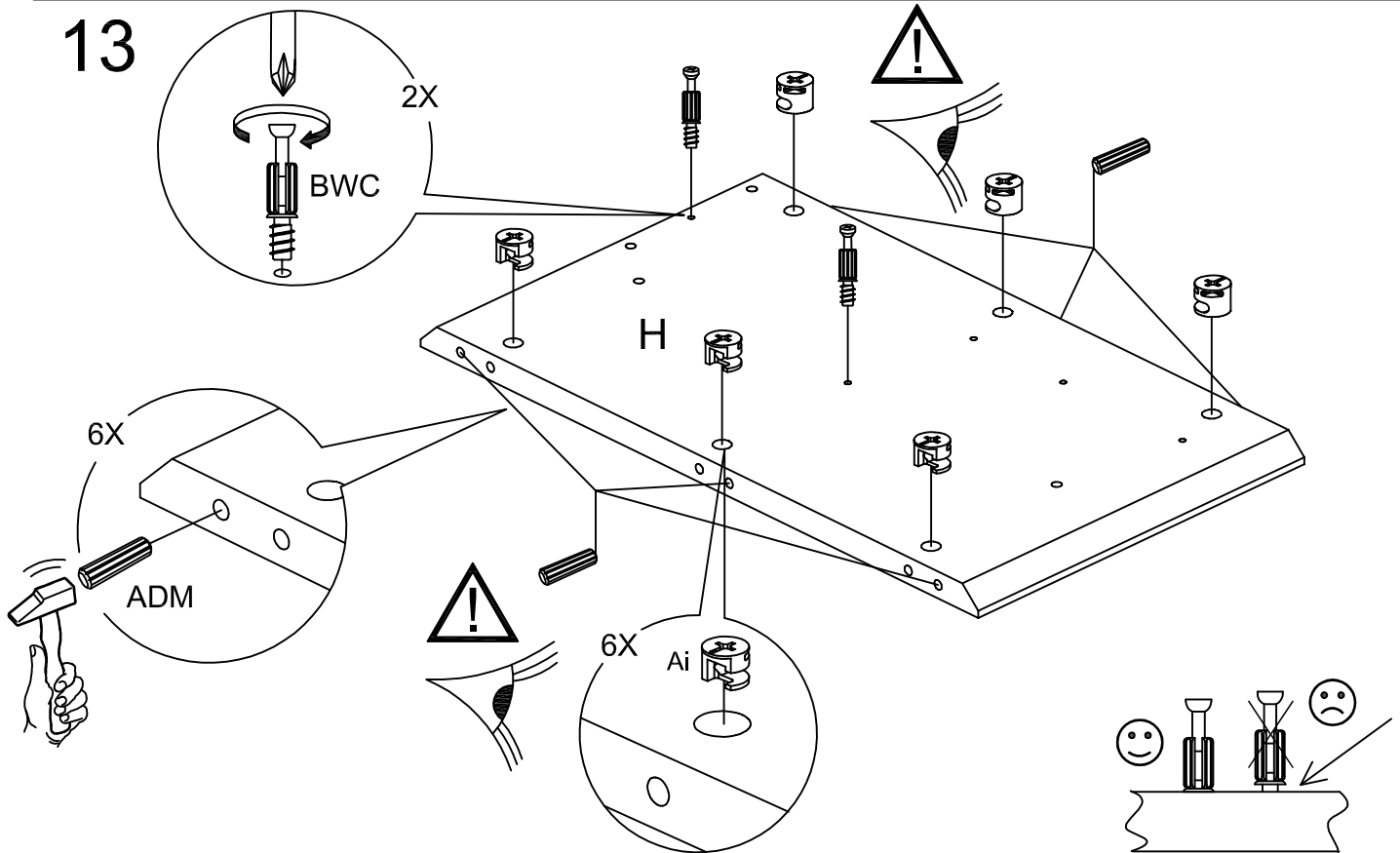

14

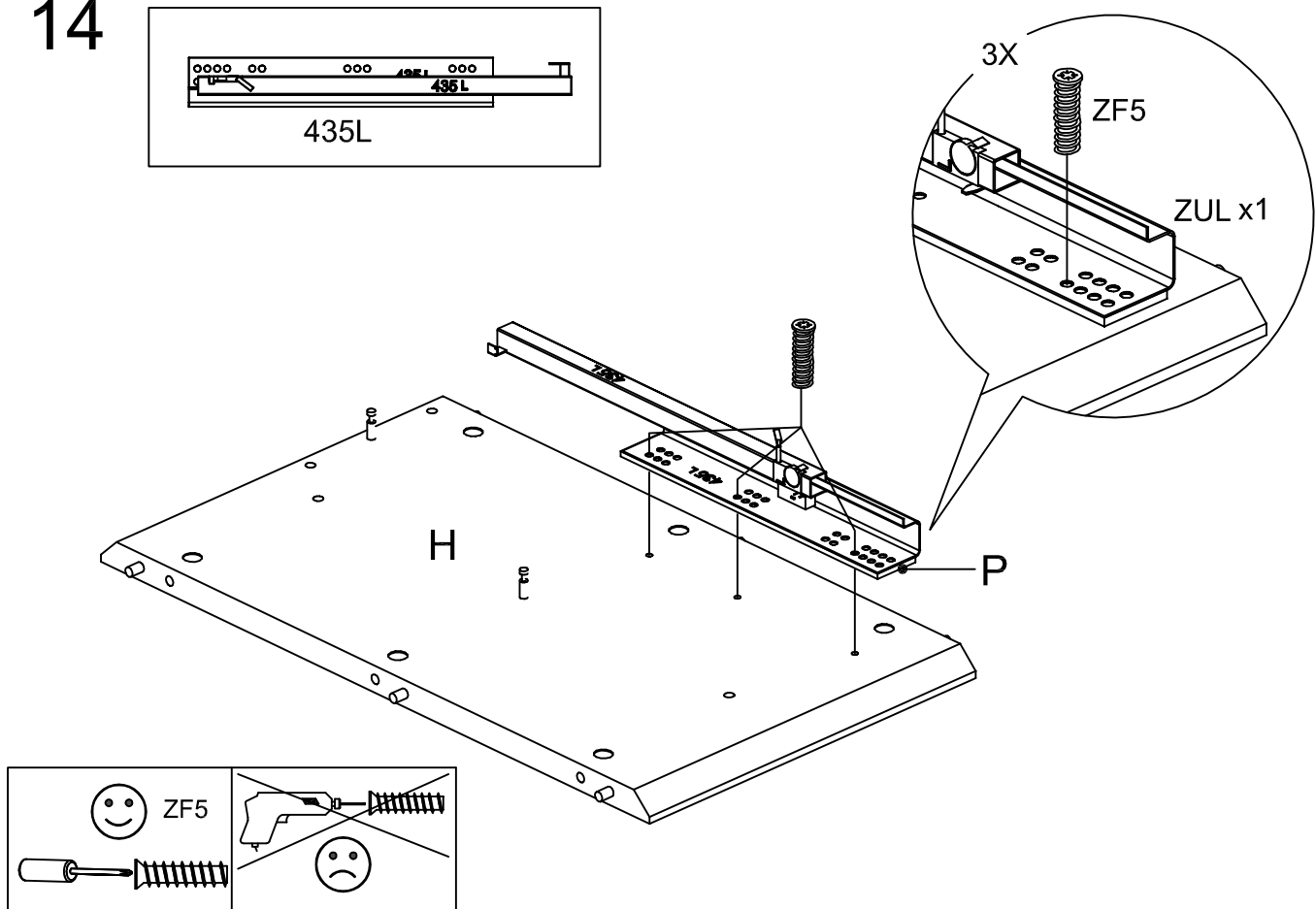

15

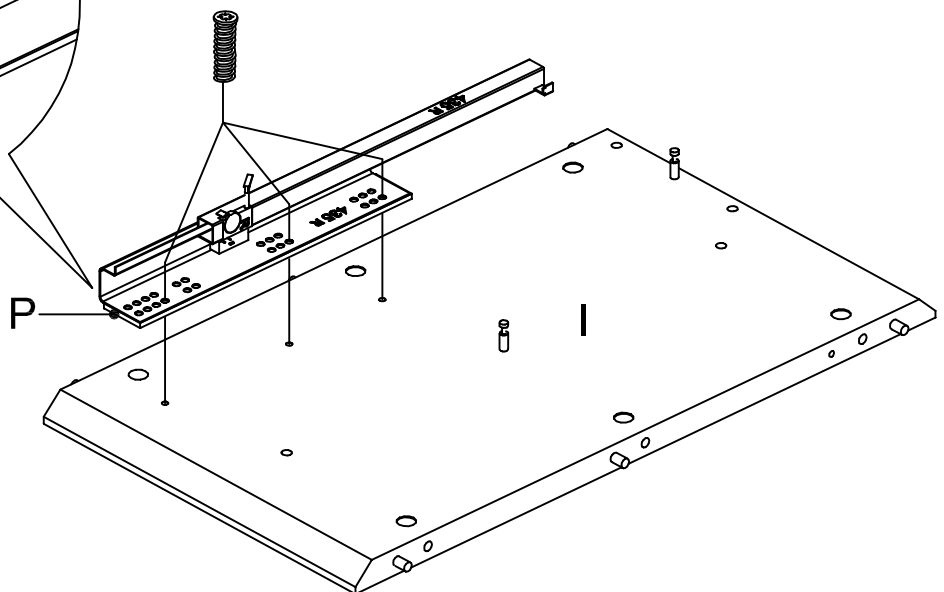
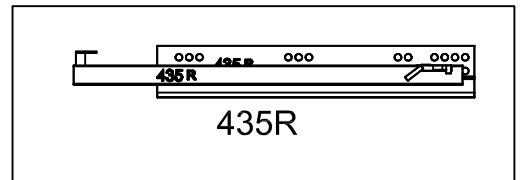
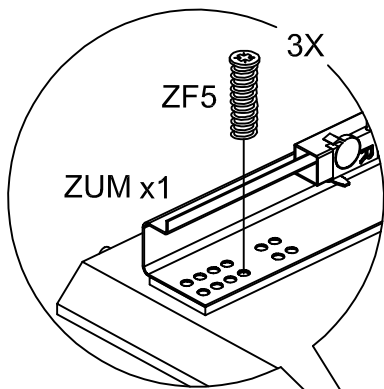
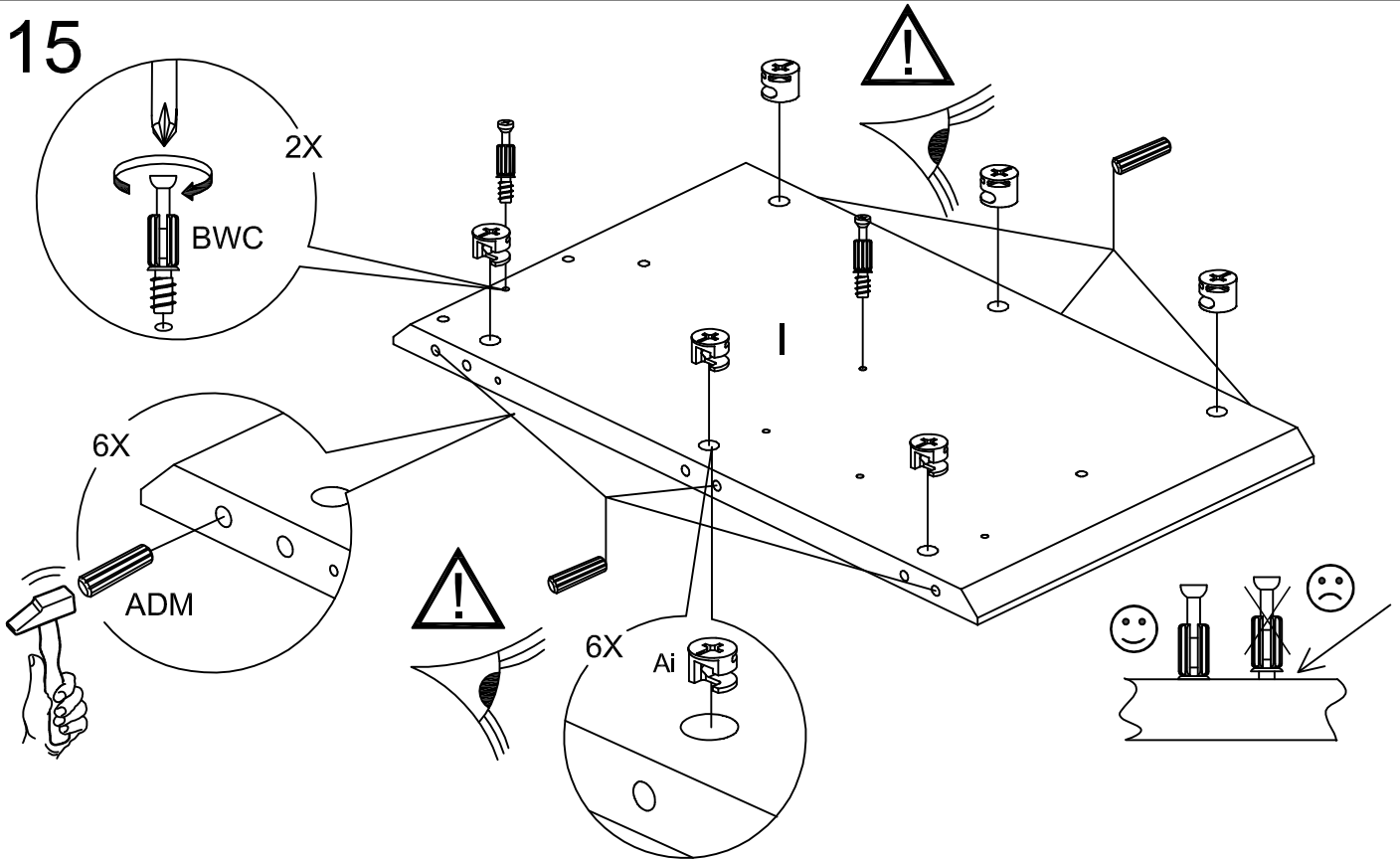

17

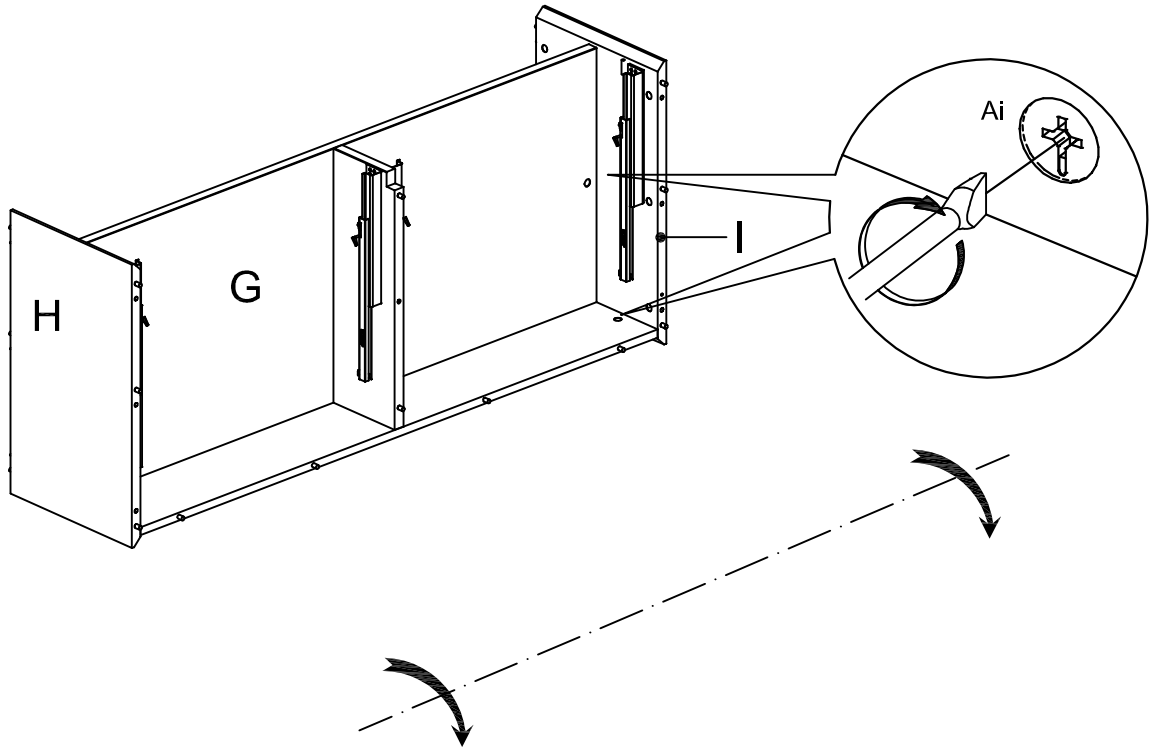

18

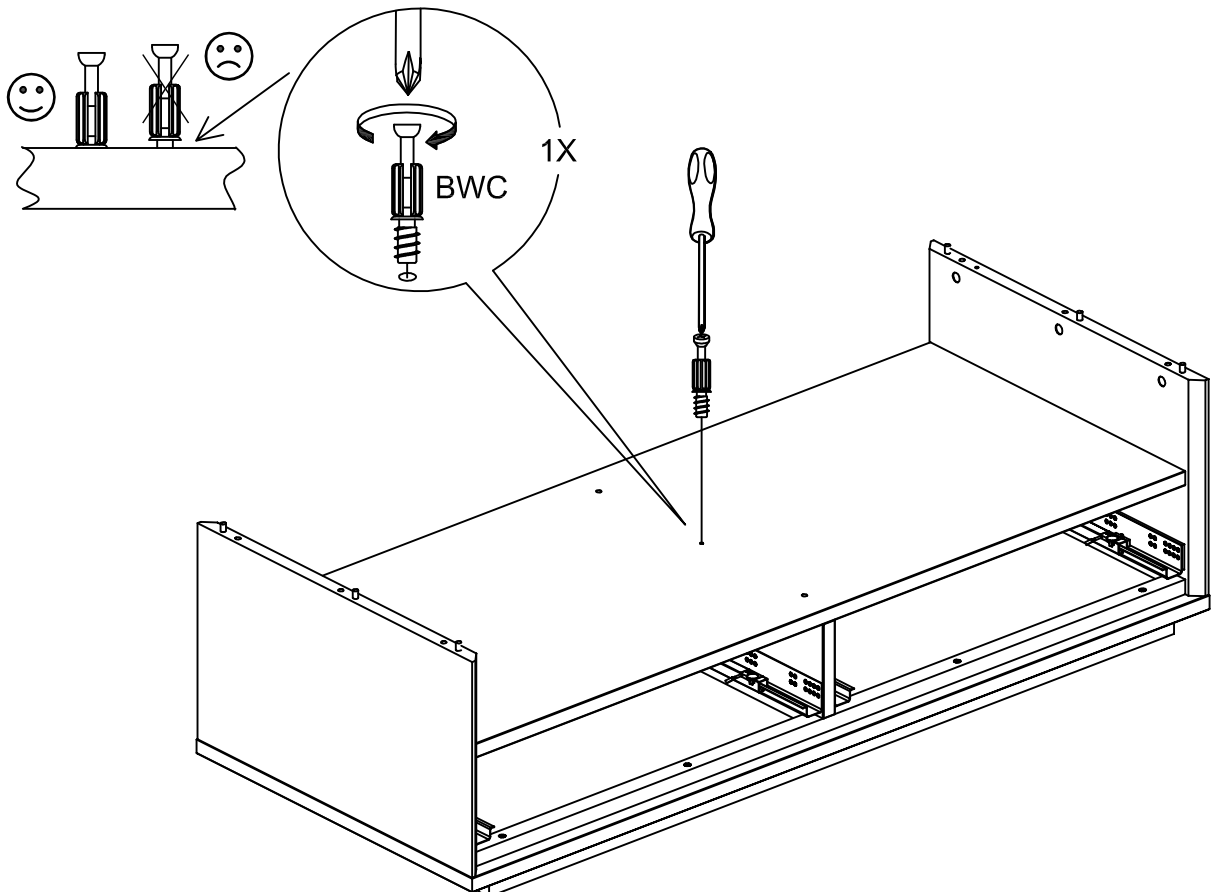

19

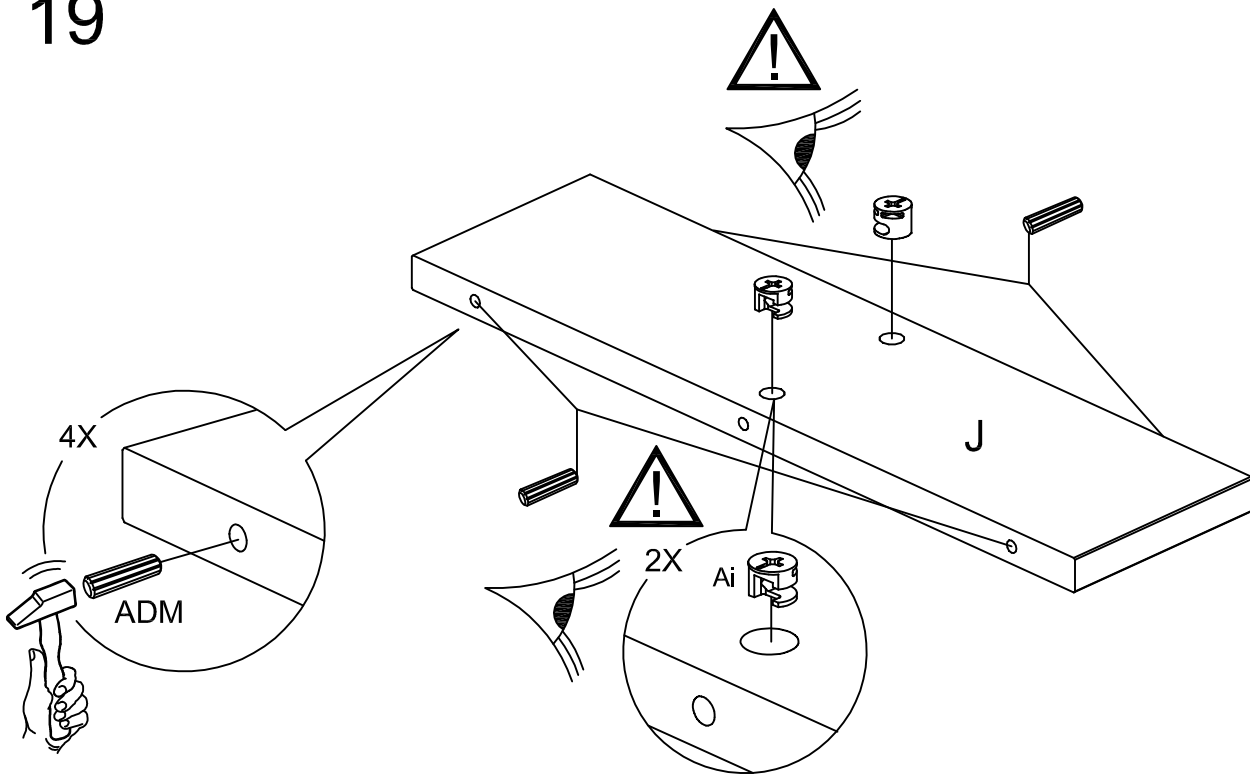

20

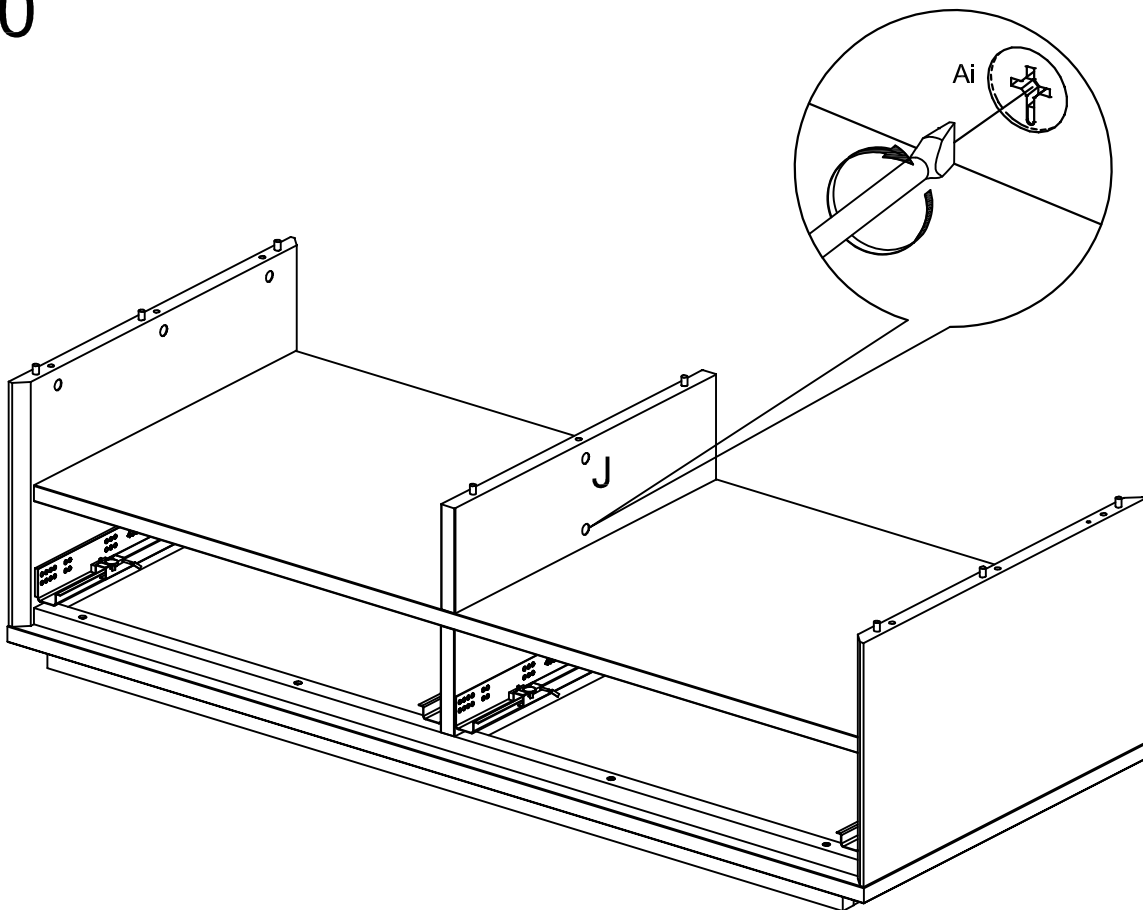

21

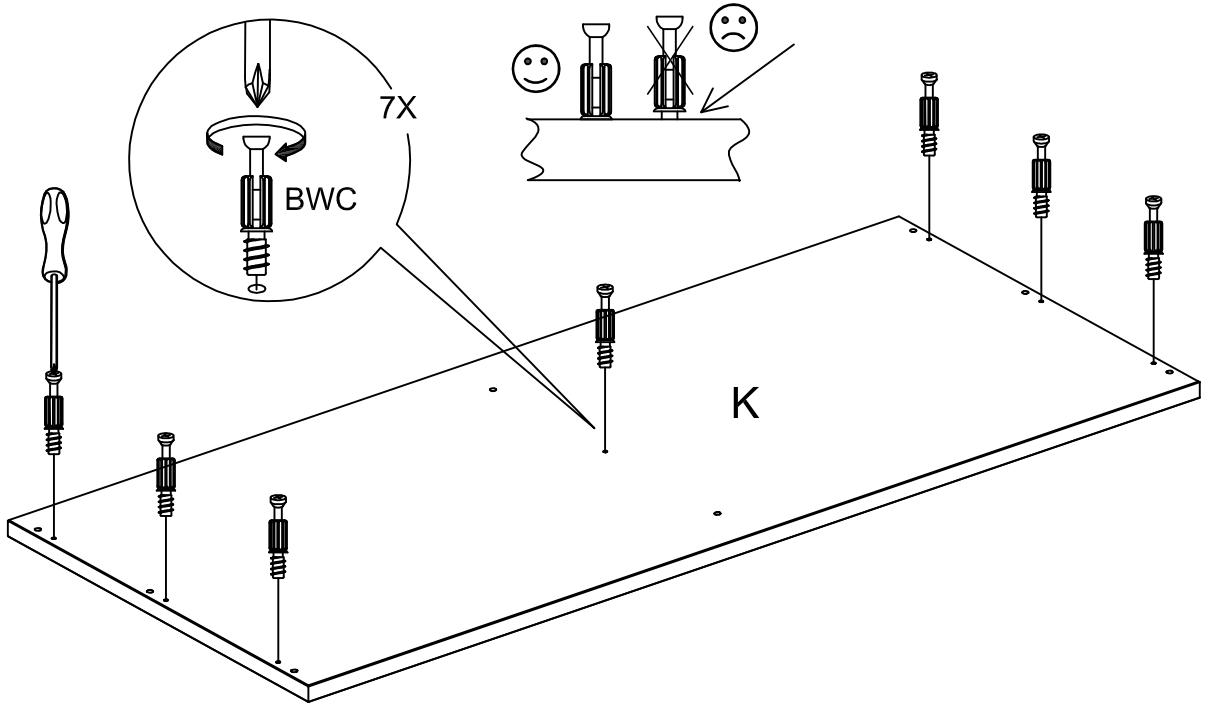

22

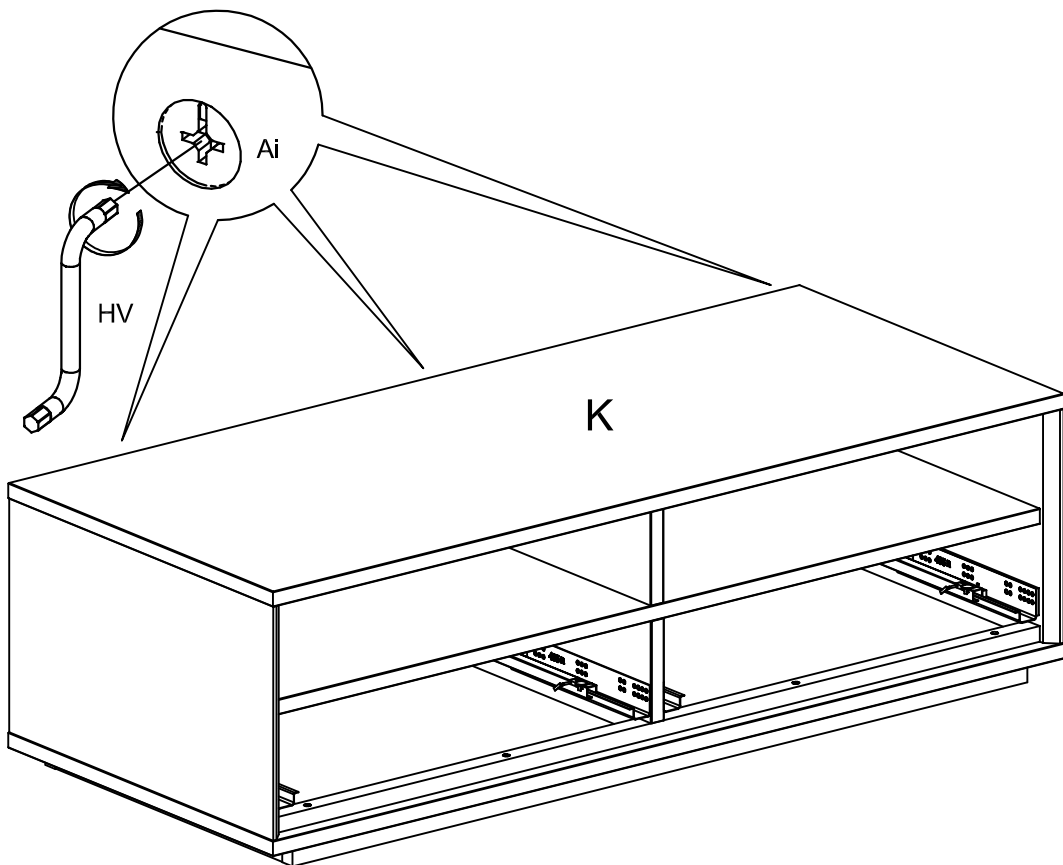

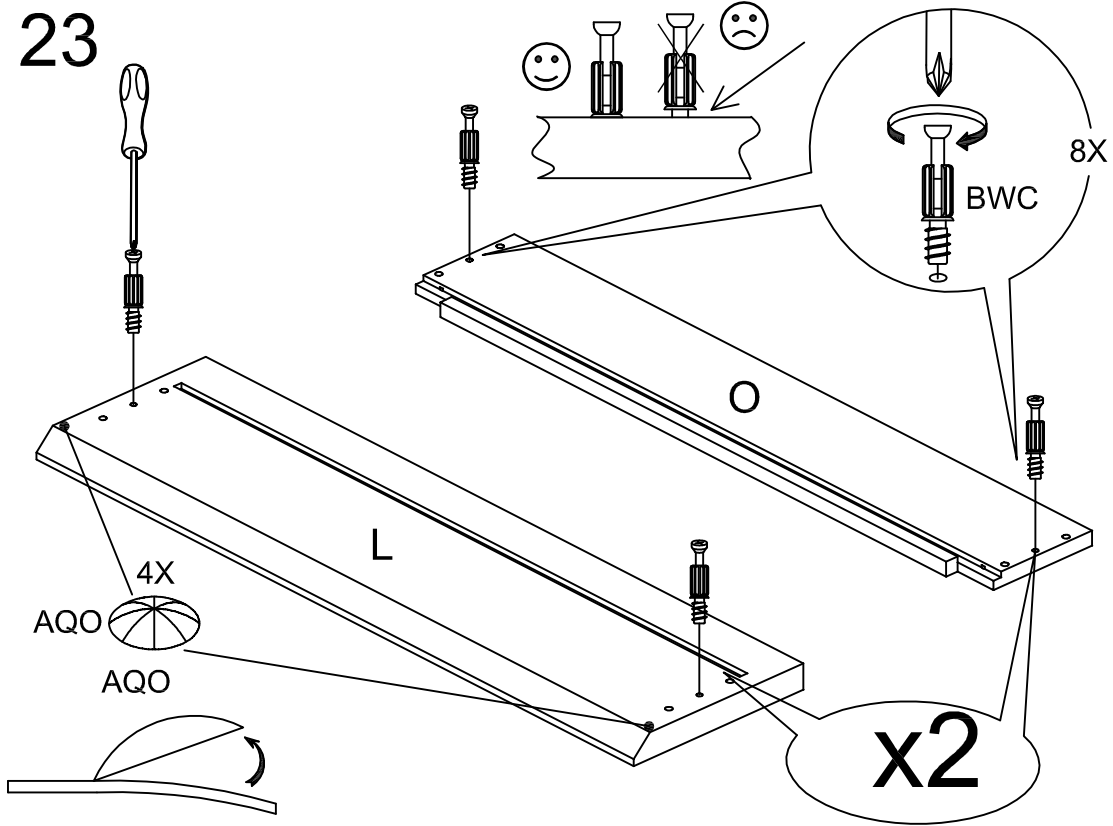

24

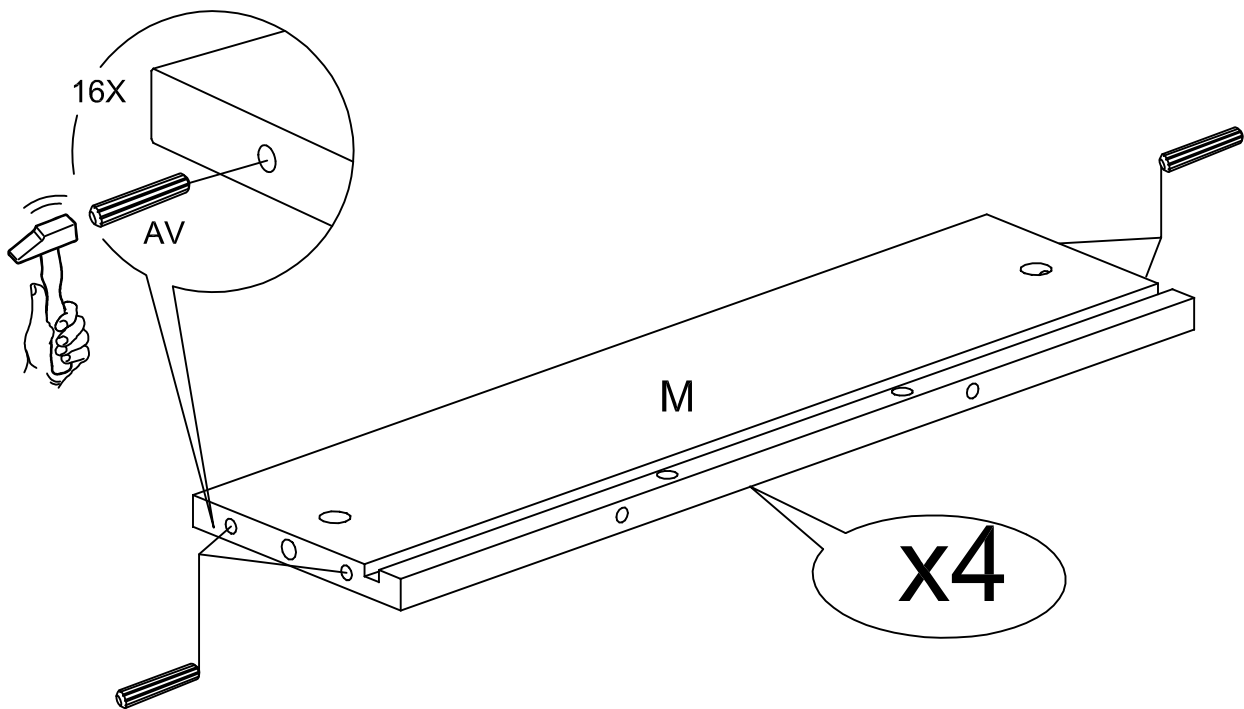

25

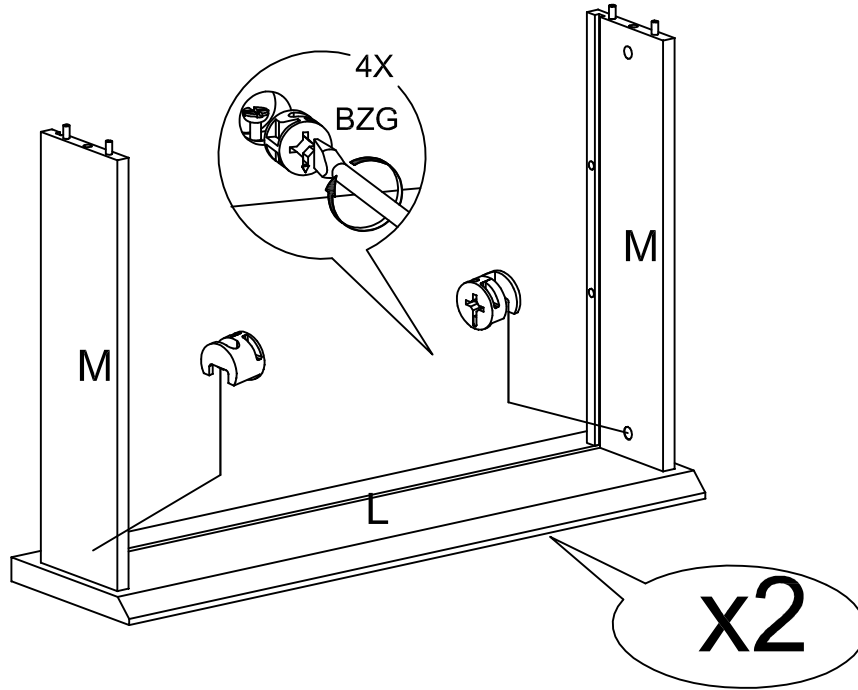

26

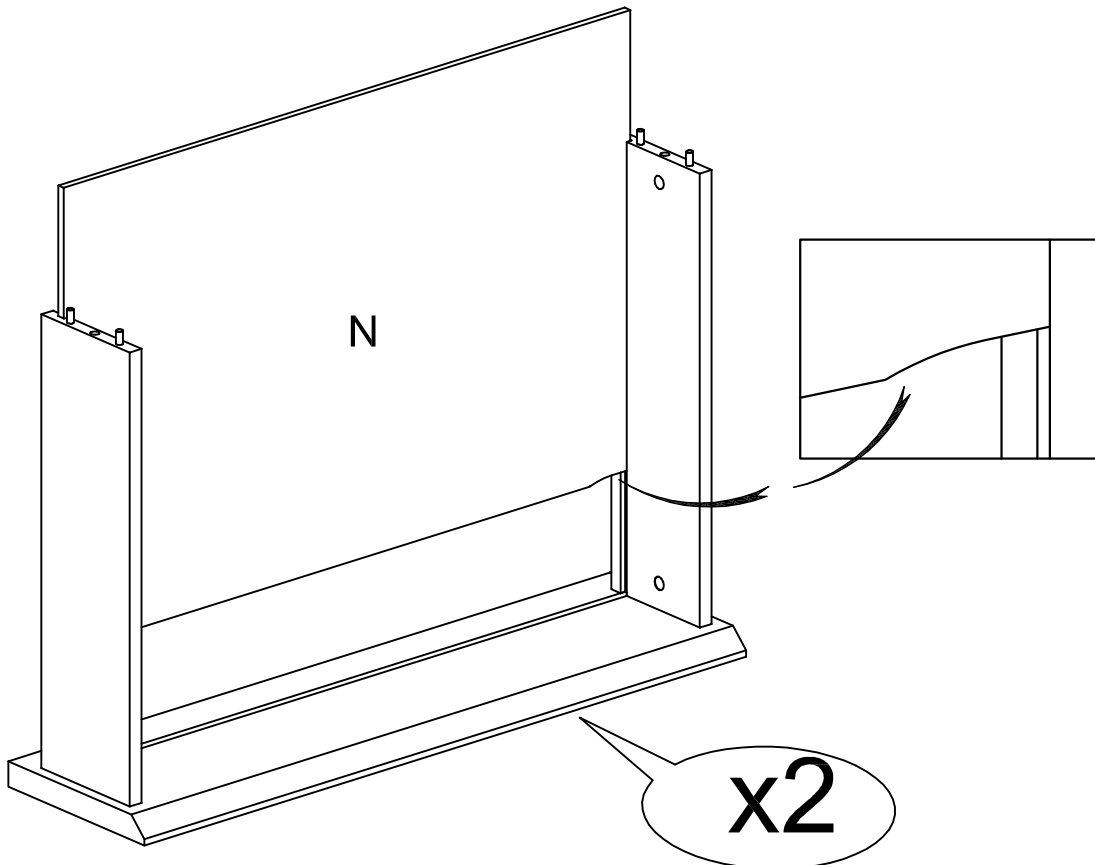

27

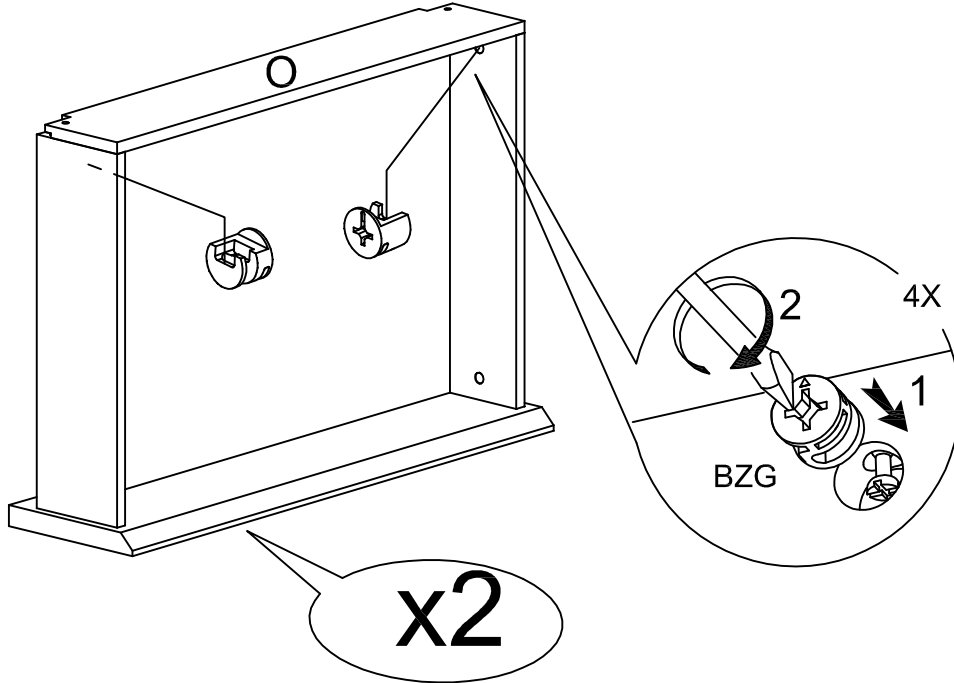

28

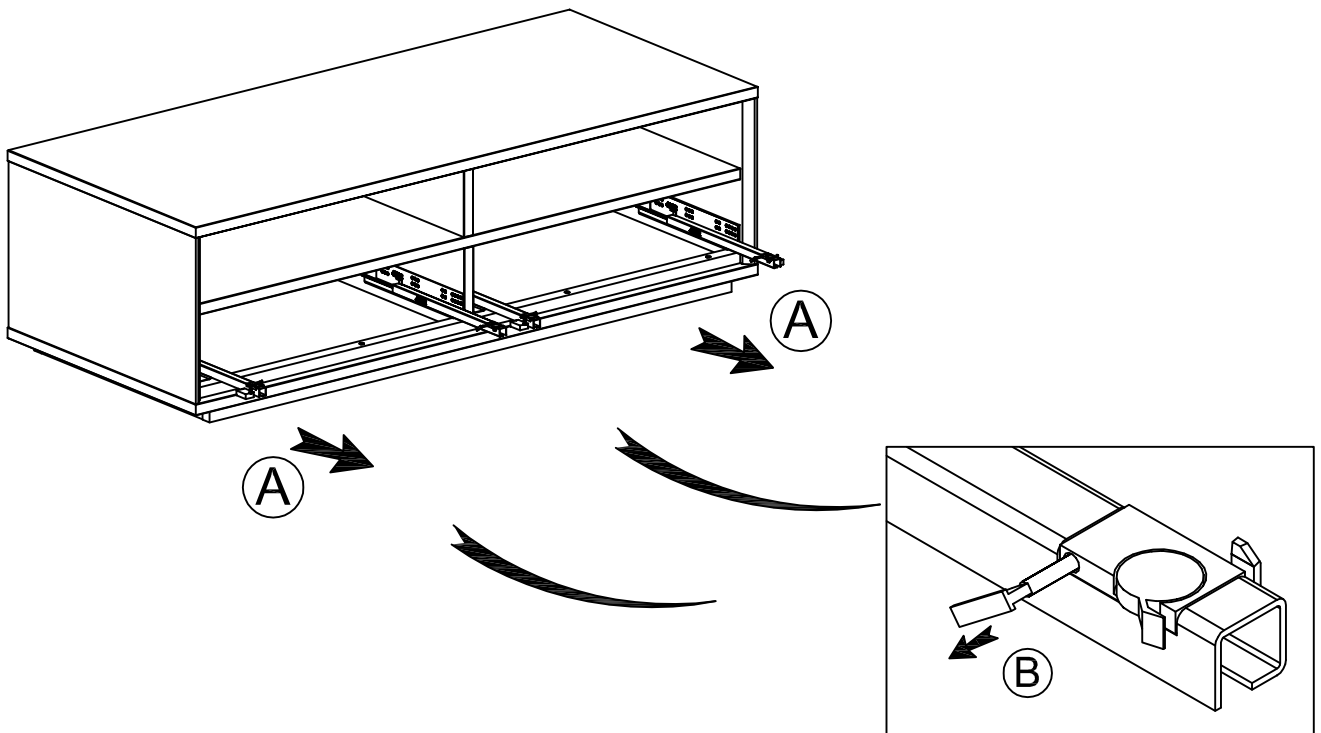

29

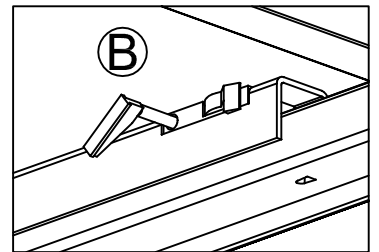
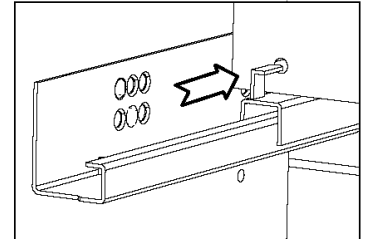
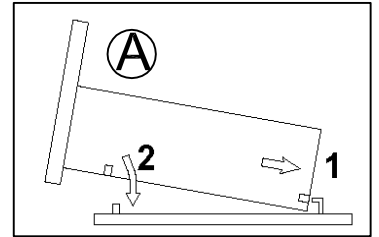
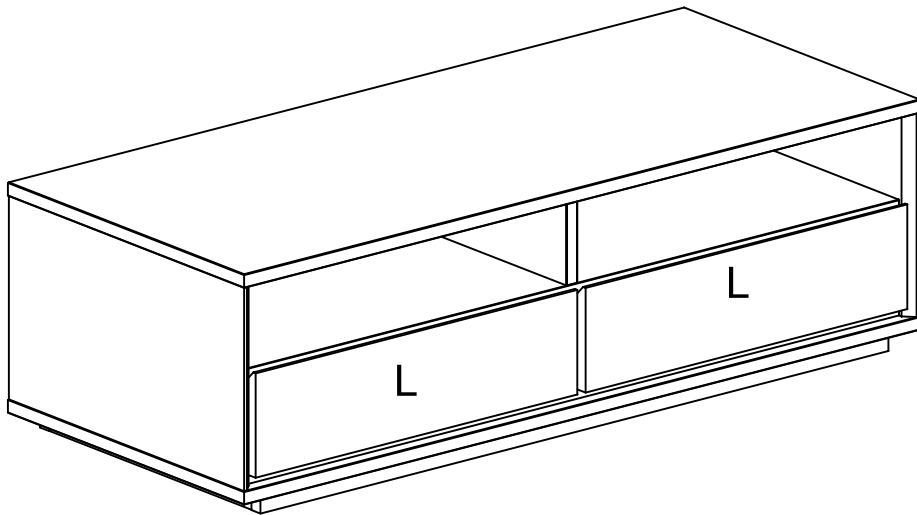

30

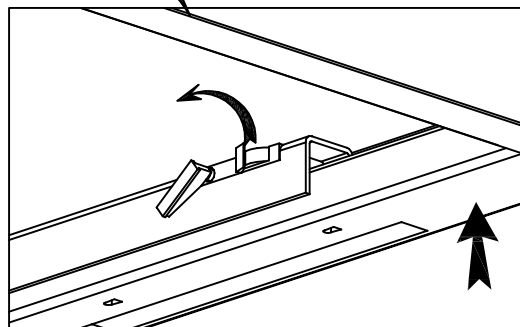
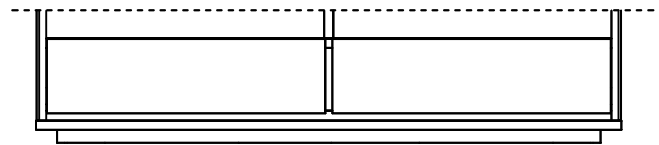
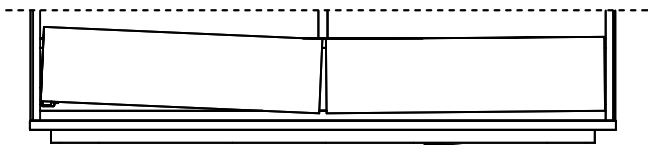

31

