



LM Ornate Wood Floor Mirror

Mounting Instructions

NOTE: This item can be wall-mounted or used as a floor mirror by leaning it against a wall. Two D-rings are secured to the rear surface for wall-mounting. Either one of the two D-rings is also used with the anti-tip hardware (included), to help secure the mirror to the wall should the mirror be used as a floor mirror. Since this item is relative large and heavy, we recommend that two people work together to mount this item to the wall.

A) Wall-Mount Instructions:

HARDWARE:



(2) Screw



(2) Drywall Anchor

Note: The provided mounting hardware is meant for drywall and stud construction only. For other wall types, please consult your local hardware store for assistance in selecting the appropriate hardware. For safety and ease of mounting, two people are recommended.

TOOLS NEEDED (not included):

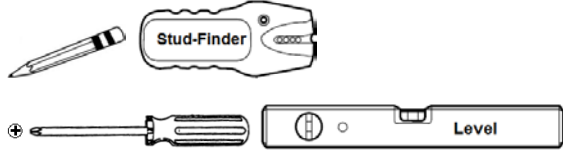

TOOL (included): A Paper Template is provided with this item to help locate the insertion points of the mounting hardware, see more as following instructions.

MOUNTING INSTRUCTIONS:

1. Position the provided paper template at a desired mounting location on wall. Use a level to ensure the template is level and adjust if necessary.
2. Using a pencil, mark the wall by piercing the template at the location of each insertion mark, as shown. Remove the template from the wall. The marks remaining on the wall are the insertion points for the mounting hardware.

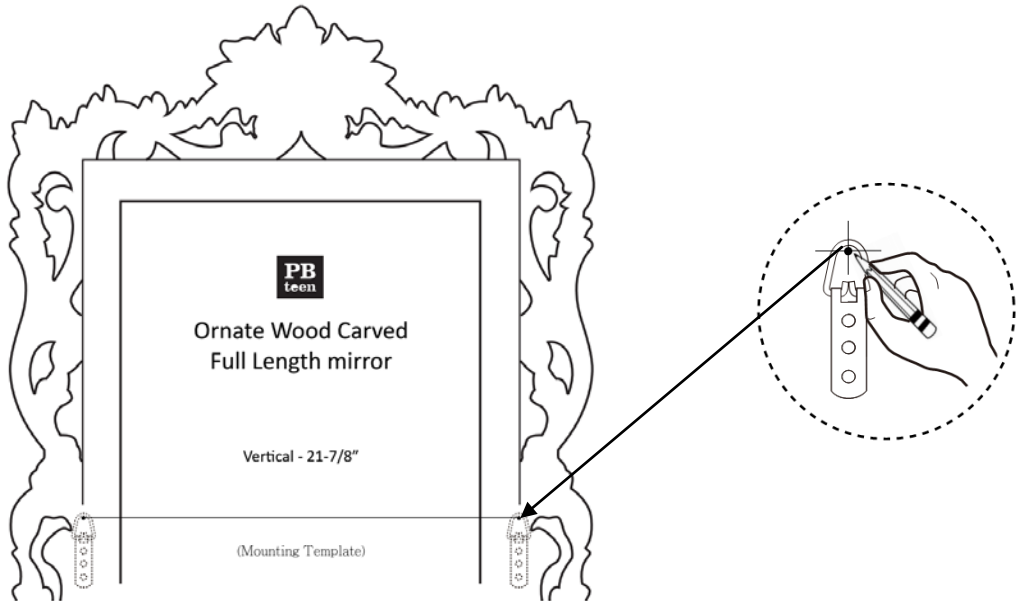

3. Use a stud-finder to determine if there is a wall stud located at either insertion mark. Install the proper hardware, as shown below. Note that the head of each screw resides about 3/8" from the wall.



For stud mounting:

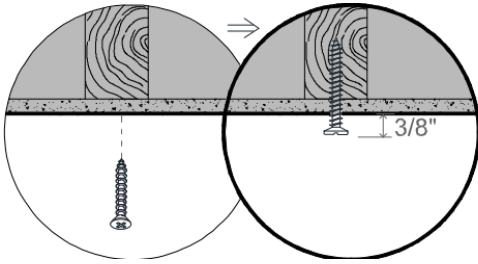

For non-stud mounting:

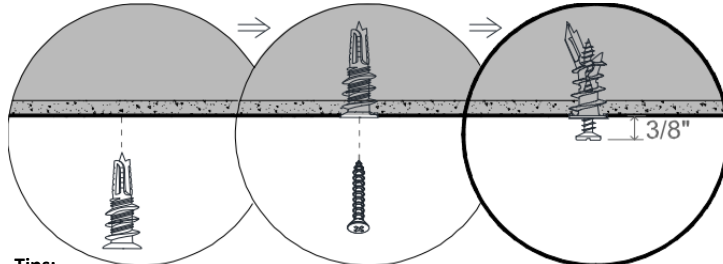

Tips:
The anchor is self-drillable.
No pilot hole required.

4. With the help of another person, hang the mirror to the wall so that the D-rings engage the screw heads.

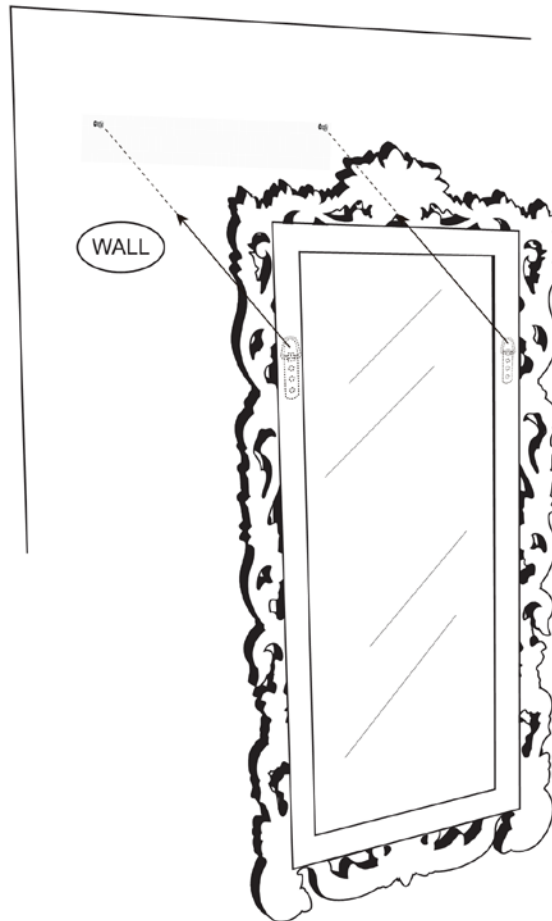

CARE INSTRUCTIONS:

- To clean the mirror frame, wipe with a soft, dry cloth. Do not use abrasive or strong chemical household cleaners.
- A household glass cleaner may be used for the mirror surface – spray the cleaner on a clean cloth first and then use the cloth to clean the mirror.

B) Floor Mirror (Installing the Provided Anti-Tip Kit):

If you decide to use this mirror as a floor mirror, we strongly recommend that you install the provided anti-tip kit to prevent the mirror from accidentally falling and causing injury or damage.

TOOLS NEEDED: Pencil / Stud-Finder / Philips Screwdriver

HARDWARE: One Anti-tip Kit

- The anti-tip kit includes one plastic bracket, two screws and one connecting nylon strap as shown to the right.
- As explained below, the bracket must be secured to a wall stud using the provided screws and the mirror positioned along the wall so that the provided strap can connect between the bracket and the D-ring located on the back of the mirror.



INSTALLATION INSTRUCTIONS:

- 1) Perhaps with the help of another person, position the mirror against a wall at a desired location. The mirror should be placed leaning on the wall so that the bottom of the mirror is about 4 ~ 8 inches away from the wall. Use a pencil to lightly mark the wall on each side of the mirror and then carefully move the mirror aside.
- 2) Use a stud-finder to determine the stud locations within the two side marks of Step (1) and mark out the studs with a pencil. Reposition the mirror at the location and align the D-rings on the back with a wall stud – you may need to move the mirror a short distance left or right. Mark a location on the wall along the stud mark for the plastic bracket so it is next to the mirror's D-ring.
- 3) Vertically position the plastic bracket against wall at the mark. Use the provided screws and a screwdriver to secure the bracket to the wall and aligned stud. Rotate each screw clockwise until tight.
- 4) Carefully move the mirror back to the location and secure the mirror to the wall using the provided nylon strap. Lace the nylon strap through the bracket and the D-ring as shown, and then slide the thin end of the strap through the receiving end of the plastic strap. Pull to tighten the piece of the mirror snug against the wall. Installation of the Anti-Tip Kit is complete.

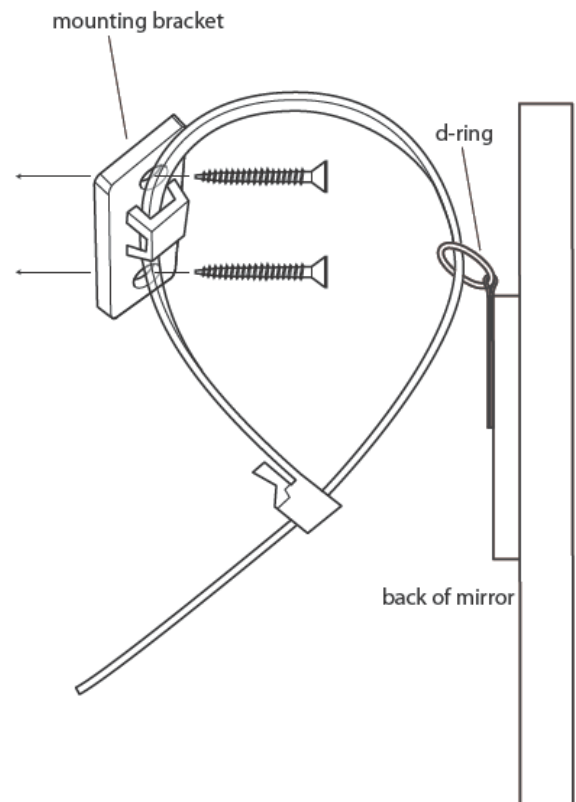

To remove the strap, depress the small level that is located at the ratchet end of the strap and slide the strap out.

Thank you for your purchase!
www.pbteen.com