

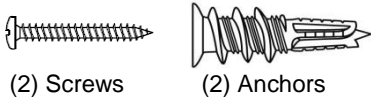

# Antiqued Paneled Mirror: Heart

Mounting Instruction

## HARDWARE INCLUDED:



(2) Screws

(2) Anchors

**Note:** The provided mounting hardware is meant for drywall and stud construction only. For other wall types, please consult your local hardware store for assistance in selecting the appropriate hardware.

## TOOLS NEEDED (not included):

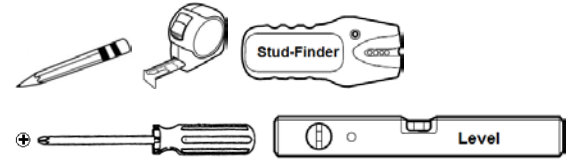

## Mounting Instructions:

**1** Measure the exact distance between the center of D-rings.

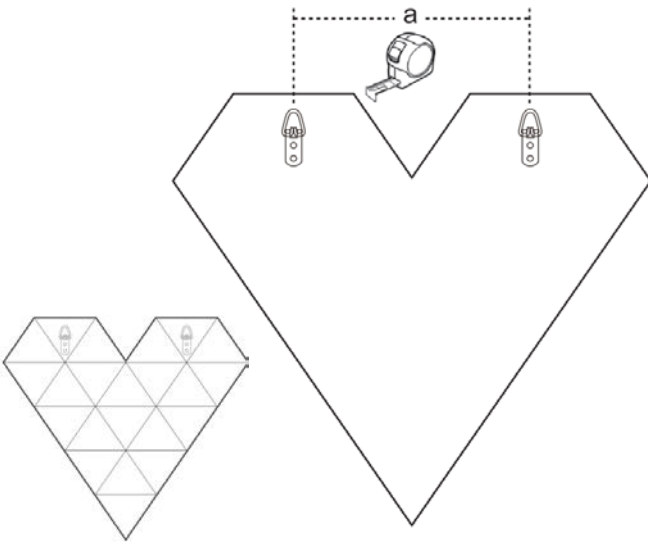

**2** With the back of the item facing away from the wall, hold it against the wall at a desired mounting location. Mark two reference points (A, B) on the wall as shown.

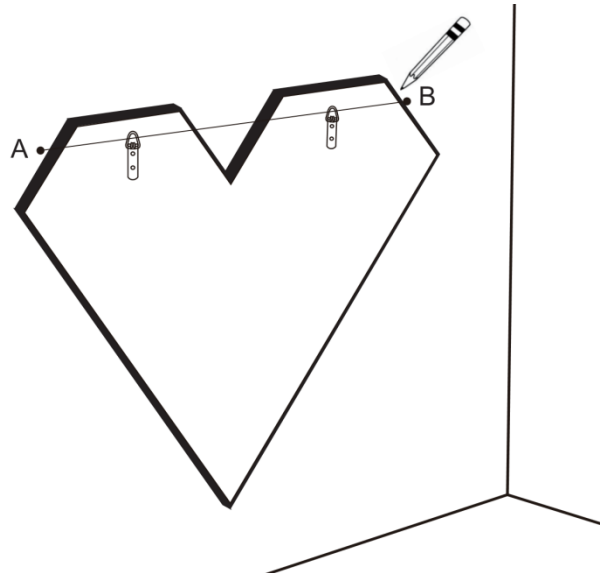

**3** Connect the two points (A, B) with a light pencil line. Use a level to ensure that the line is level.

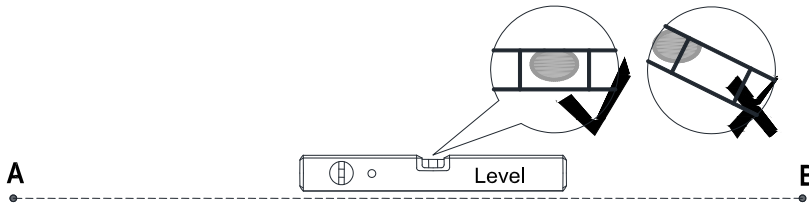

**4** Make two insertion marks (C, D) centered along the line using the measurement "a".

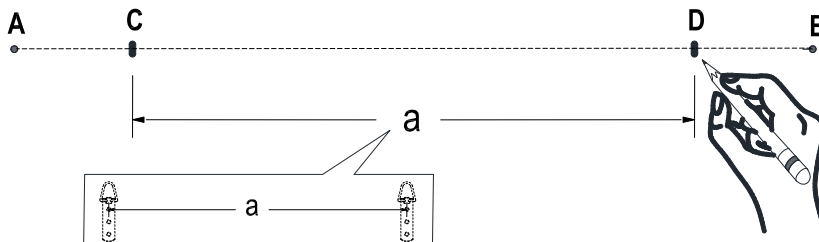

- 5** Use a stud-finder to determine if there is a wall stud located at either insertion mark. Install the proper hardware, as shown below. Note that the head of each screw resides about 3/8" from the wall.



**For stud mounting:**

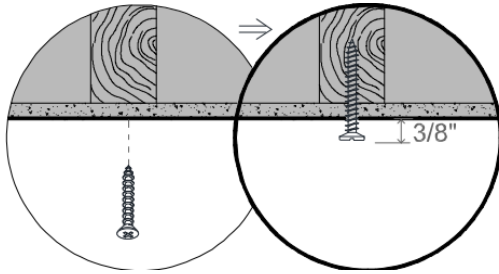

**For non-stud mounting:**

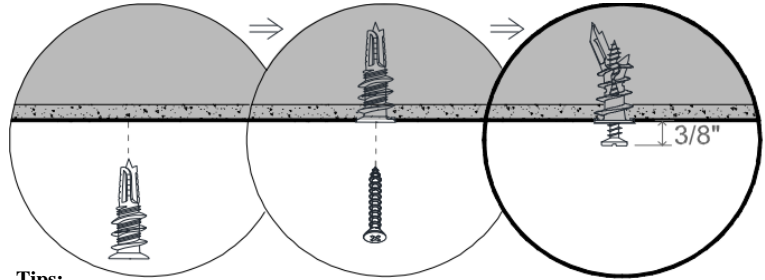

**Tips:**  
The anchor is self-drillable.  
No pilot hole required.

- 6** Hang the item to the wall so that the D-rings engage the screw heads.

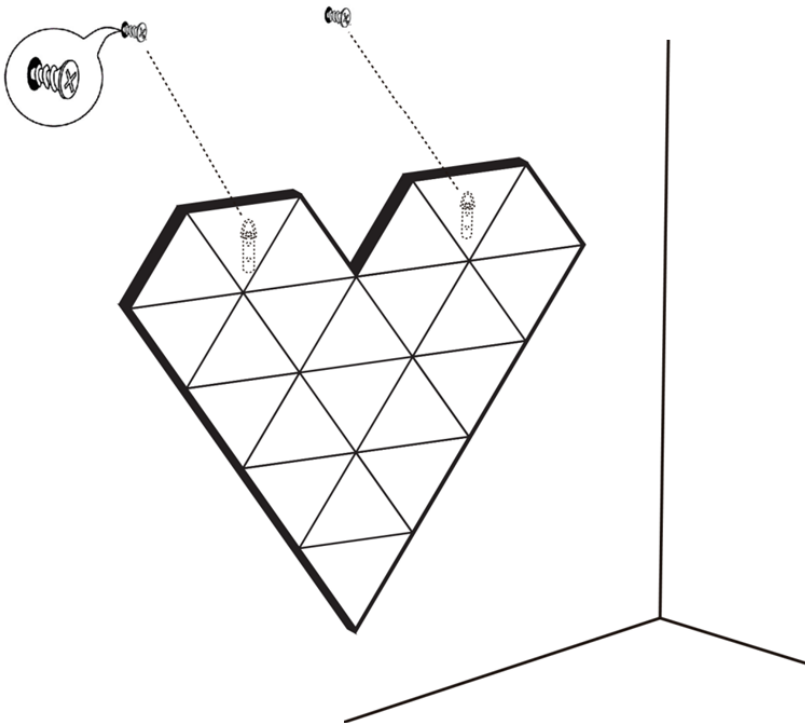

**Care Instructions:**

- To clear: Wipe with a soft, dry or slightly damp cloth.
- Do not use abrasive or strong chemical household cleaners.

Thank you for your purchase.  
Stores | Catalog | [www.pbteen.com](http://www.pbteen.com)