

P O T T E R Y B A R N

QUINN TILT MIRROR

Note:

- Please read these instructions in their entirety before beginning assembly.
- This mounting hardware is meant for dry wall/stud mounting only. If walls are concrete, brick or plaster, please consult your local hardware store for assistance.
- For safety and ease of mounting, installation is recommended using two people.

Hardware/Parts Included:

- (1) Mirror
- (2) Wall brackets with mounting plates
- (2) Flat washers
- (2) Finial caps
- (4) Screws
- (4) Wall anchors (for dry wall only)
- (2) Hex screw
- (1) Allen wrench

Tools Required for Assembly

- Level
- Stud finder
- Pencil
- # 2 Phillips screwdriver

Assembly Instructions:

1. Slide a wall bracket, then flat washer over the pre-fixed bolts on the mirror. Secure the brackets with the finial caps provided.
2. Hold the mirror in the desired location. With a pencil, mark on the wall the location of the screw holes. These will be the insertion points of your mounting hardware.
3. Using the proper hardware for your wall type, mount mirror to wall.

Dry Wall Mounting:

1. Use a Phillips screwdriver to insert the wall anchors. Do not “push” or drive the anchors into the wall, they are designed to bore into the wall like a drill bit. Slowly turn the anchors clockwise while applying pressure until the flange just touches the wall.
2. Insert the metal screw through the screw holes of the mounting plate and into the wall anchor until tight.
3. Slide the mirror onto mounting plates, secure by tightening hex screws with Allen wrench.

Stud Mounting:

Stud mounting is always best, so try to position over studs if possible. Use a stud finder to locate a stud in desired location. If there is no stud, the wall anchors/metal screws are both required.

1. With a Phillips screwdriver, insert metal screws through the screw holes of the mounting plates and into the stud; turning clockwise until tight.
2. Slide the mirror onto mounting plates, secure by tightening hex screws with Allen wrench.

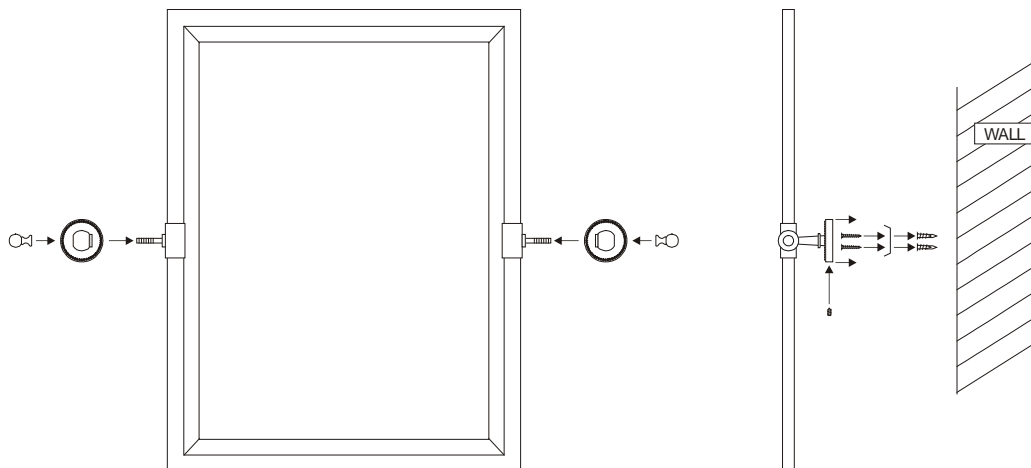

Care Instructions:

- Wipe with a soft, dry cloth only.
- Avoid cleaners and abrasives as they may damage the finish.