

# P O T T E R Y B A R N

## Hapao Wall Art

### Mounting Instructions

#### Hardware:

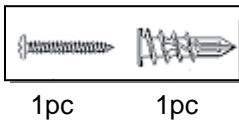

#### TOOLS NEEDED (not included):

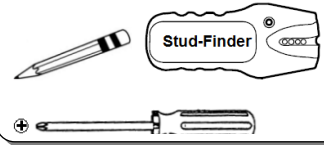

The hardware included with this item is meant for drywall or stud mounting only. If your walls are made from concrete, brick or plaster, please consult your local hardware store for assistance in selecting the appropriate hardware.

#### Hanging Orientation Options:



#### Mounting Instruction:

1

With the item located at the desired location against a wall, use a pencil to lightly mark the wall.



2

Use a stud-finder to determine if there is a wall stud[s] located at [each] either insertion mark. Install the proper hardware, as shown below. Note that the head of each screw resides about 3/8" from the wall.

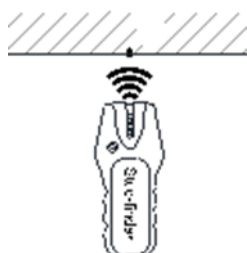

#### Stud Mounting



#### Dry Wall Mounting

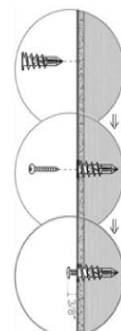

3

With the help of another person, hang the item to the wall so that the D-ring engages the screw heads.



**Care Instructions:**

- Dust often with a soft, dry cloth
- Avoid using strong chemical or abrasive cleaners.

Thank you for your purchase  
[Stores/catalog/www/potterybarn.com](https://www.potterybarn.com)