

**Welcome to St Lawrence Church. Please use this guide to take you round our church.**

**The church was first founded around 1100 by William de Danmartin, the Norman lord of the manor of Effingham East Court and dedicated to St Lawrence. He gave it to the Priory of Merton and it passed to the Crown after the Reformation. The church has been extensively altered and extended over the years. A major renovation and remodelling was completed in 1888 when most of the stained glass windows by the noted designer Heaton, Butler & Bayne were given by parishioners in memory of their loved ones.**

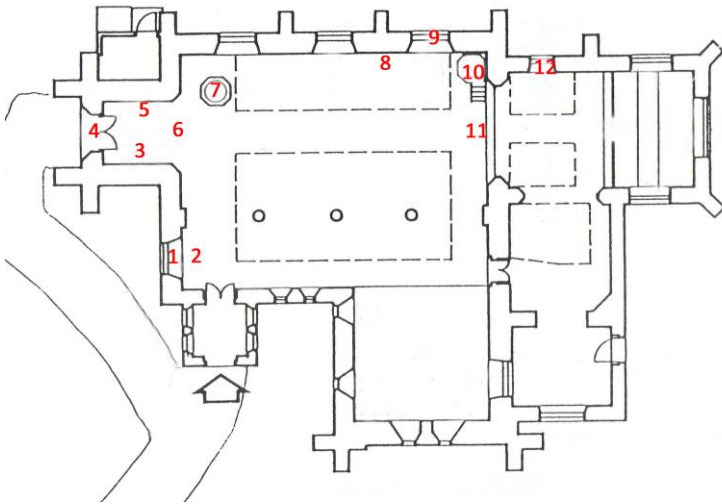

The numbers below refer to those in the plan of the church and begin from the left of the porch.

### THE SOUTH AISLE

- 1 The 1889 stained glass window on the west wall shows St. Michael in his armour and St. Raphael with a lamp in his left hand.
- 2 Seven unusual tiles, which were originally on the chancel floor, are set in a row below the window. They commemorate the children who died in infancy of the Reverend William Walker (vicar 1677 to 1696).

### THE TOWER

**The tower was erected in 1887 in memory of the Rev J Robinson by his nephew, John Teesdale, of The Lodge. He was one of two Church Wardens, (the other was Uriah Loxley) who with the Vicar, the Rev EF Bayly were responsible for the 1888 renovation. An 'unsightly' gallery was removed and 23 monuments from around the church were moved onto its walls. In 1890 a chiming clock with five bells was installed, which was replaced in 1934 by a modern mechanism whilst retaining the old face.**

**3** Thirteen memorial tablets include an ancient heart burial probably from the 12th century and a memorial to Sir Thomas Hussey Apreece, lord of the manor of Effingham, who lived at Effingham House (now the Golf Club) and died there in 1833.

**4** The 1889 stained glass window shows Christ as the Good Shepherd, carrying a lamb; John the Baptist baptising Christ with the Holy Spirit as the Dove and Christ carrying a small child.

**5** The six memorial tablets include an 1844 monument to Maria Paratt (daughter of Captain Hillebrand and Lucy Parratt of Effingham House) with a reclining effigy and mourning figure by William Pistell.

**6** Four tablets are above the arch.

### THE NAVE

**This is the oldest part of the church as the original church would have been a single cell structure. Only the north wall of flint and mortar is probably from the original building.**

**7** The font of alabaster or light marble which replaced the original chalk font was given by the Misses Teesdale in 1891.

**8** On the north wall is a large mosaic depicting angels and dedicated to the memory of Caesar Czarnikow, lord of the manor of Effingham East Court of Effingham Hill (now St Teresa's School) and his wife, Louisa.

**9** This stained glass window shows Faith and Charity and is a memorial to Charles Lambert, director of the Lambert and Butler tobacco company and long-term tenant at Effingham House who died in 1910.

**10** The pulpit, made from an old tie beam from the roof of the chancel, was donated by Caesar Czarnikow. It replaced a carved Jacobean pulpit.

**11** In the floor of the nave, just below the chancel steps, is an ancient memorial slab (c. 1312) of Walter de Geddinges, a Sheriff of Surrey in 1302 and 1307. It has an inscription in Norman French - VATER DE GEDDINGES GIT ICI DEV A SA ALME FACE MERCI. (Walter de Geddinges lies here - may God have mercy on his soul).

### THE CHANCEL

**Probably first built in the early 13th century and renovated in the late 14th at the demand of the Bishop of Winchester due to its poor condition, the chancel was again in a poor condition in 1888 when it was largely rebuilt and its roof raised, retaining the 14th century windows.**

**12** Known as the Prior of Merton Window, the exterior of the 14th century north-west window (in a similar style to those at Winchester Cathedral) in the chancel has hood mouldings ending in heads with one possibly of a Prior of Merton Priory. The stained glass

is late 19<sup>th</sup> century of St John the Evangelist and St James.

**13** Four memorial tablets commemorate wealthy residents of the parish in the 19<sup>th</sup> century.

**14** The window glass in this 14<sup>th</sup> century window is believed to be by Wales signifying The Presentation and Holy Family and incorporate surrey oaks and acorns.

**15** The large, east, three light window was erected in the 1888 renovation. The stained glass was donated by Col. Frederic Bayly, father of the vicar, in memory of his wife, Mary. The centre panel shows the Crucifixion, the Annunciation is on the left and the birth of Christ on the right. On either side are mosaics of two archangels from the Book of Enoch – St Gabriel to the left and St Uriel to the right.

**16** The reredos is of Caen stone with alabaster sculptured figures of Our Saviour and the four Marys.

**17** The south-east chancel window is believed to be 14<sup>th</sup> century. The left pane of the 1885 stained glass window is of St. Nicholas with his bags of gold for the poor and the right pane is of St. Lawrence with grid-iron.

**18** In 1891 the altar rails, which were designed for the British Embassy in Paris, were bought by public subscription.

**19** The organ was dedicated on November 22<sup>nd</sup> 1894 and was constructed by Mr. A. Kirkland. In 1899 a new choir vestry was built and the organ chamber enlarged with a bequest from Miss Elizabeth Faris of Crossways. The Great Cornet 12-17 (a stop on the great organ) came from Brompton Oratory.

**20** The Bible of the Rev. John Miller, vicar of the church from 1696 to 1724, has recently been kindly donated to the church by a parishioner. The Rev Miller took this Bible with him to America where he was previously army chaplain.

## THE TRANSEPT - ST NICHOLAS CHAPEL

*Probably first built in the early 14th century it was renovated extensively in 1888 including totally rebuilding the south wall. In 1933 the plaster ceiling of the chapel was removed on the initiative of Sir Barnes Wallis revealing a medieval crown post roof of that period.*

**21** A 15th window high on the south-east wall looks into the vestry. It contains fragments of stained glass from earlier windows.

**22** There is an ancient piscina and aumbry on the south wall and a modern aumbry reserved for Holy Communion for sick and housebound parishioners. The contemporary design depicts the martyrdom of St. Lawrence.

**23 & 24** Two windows of St Margaret of Scotland and St Longinus, the Centurion reputed to have said: "Truly this was the Son of God."

**25** The chest in the corner bearing the name 'URRY' is dated 1745. Thomas Urry was lord of the manor of Effingham from 1709 to 1777.

## THE SOUTH AISLE (continued)

**26** On the wall is a list of past Vicars of Effingham.

**27 & 28** On the wall of the south aisle are two small windows erected in memory of Elizabeth Faris in 1900 by the vicar, the Rev EF Bayly. The first is of St. Peter with a crook and keys, and the second shows St. Paul with a sword and book.

**29** Two pictures show the church's exterior and interior before the 1888 renovation.

**30** By the door is a stone holy water stoop or basin embedded in the wall, intended to remind those who enter the church of their baptism.

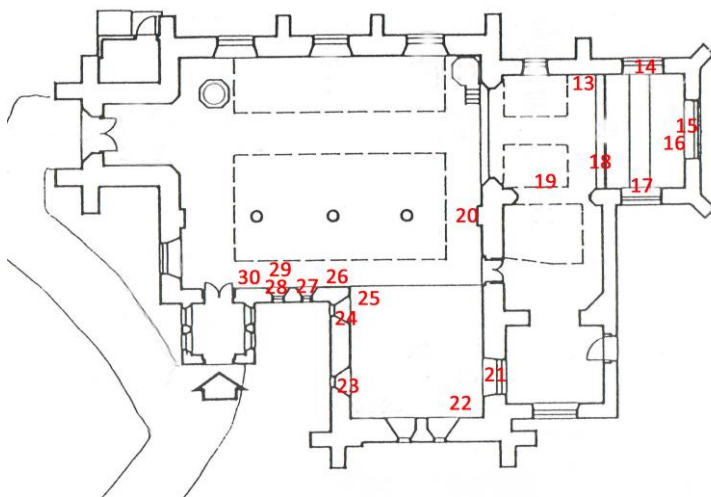

## OUTSIDE

**Please see separate graveyard plan.**

*Along the northern boundary of the graveyard there are three nationally listed Grade II tombs. The graveyard also contains the grave of Sir Barnes Wallis Kt. C.B.E. (1887 to 1979) and his wife, Mary, in the south east corner of the Churchyard, between the Vestry and the Old Vicarage. He lived in Effingham for 49 years and was an active parishioner, being secretary of the Parochial Church Council for eight years. He was knighted in 1968 for services to the nation as an engineer and an inventor.*